

**MODEL AT2M ('72 MODEL)**

**MODEL ATMX ('73 MODEL)**

[www.legends-yamaha-enduros.com](http://www.legends-yamaha-enduros.com)

This Parts List is for the exclusive parts for the AT2M ('72 MODEL), ATMX ('73 MODEL). Please refer to AT2 Parts List for the parts not listed in this publication.

# CONTENTS

|         |                                  |    |
|---------|----------------------------------|----|
| Fig. 1  | Crankcase .....                  | 1  |
| Fig. 2  | Engine .....                     | 3  |
| Fig. 3  | Transmission .....               | 5  |
| Fig. 4  | Intake .....                     | 7  |
| Fig. 5  | Carburetor .....                 | 9  |
| Fig. 6  | Flywheel Magneto .....           | 13 |
| Fig. 7  | Frame · Rear Fender · Seat ..... | 15 |
| Fig. 8  | Front Fork · Front Fender .....  | 17 |
| Fig. 9  | Fuel Tank · Oil Tank .....       | 21 |
| Fig. 10 | Front, Rear Wheels .....         | 23 |

## NUMERICAL INDEX



Fig. 1 CRANKCASE

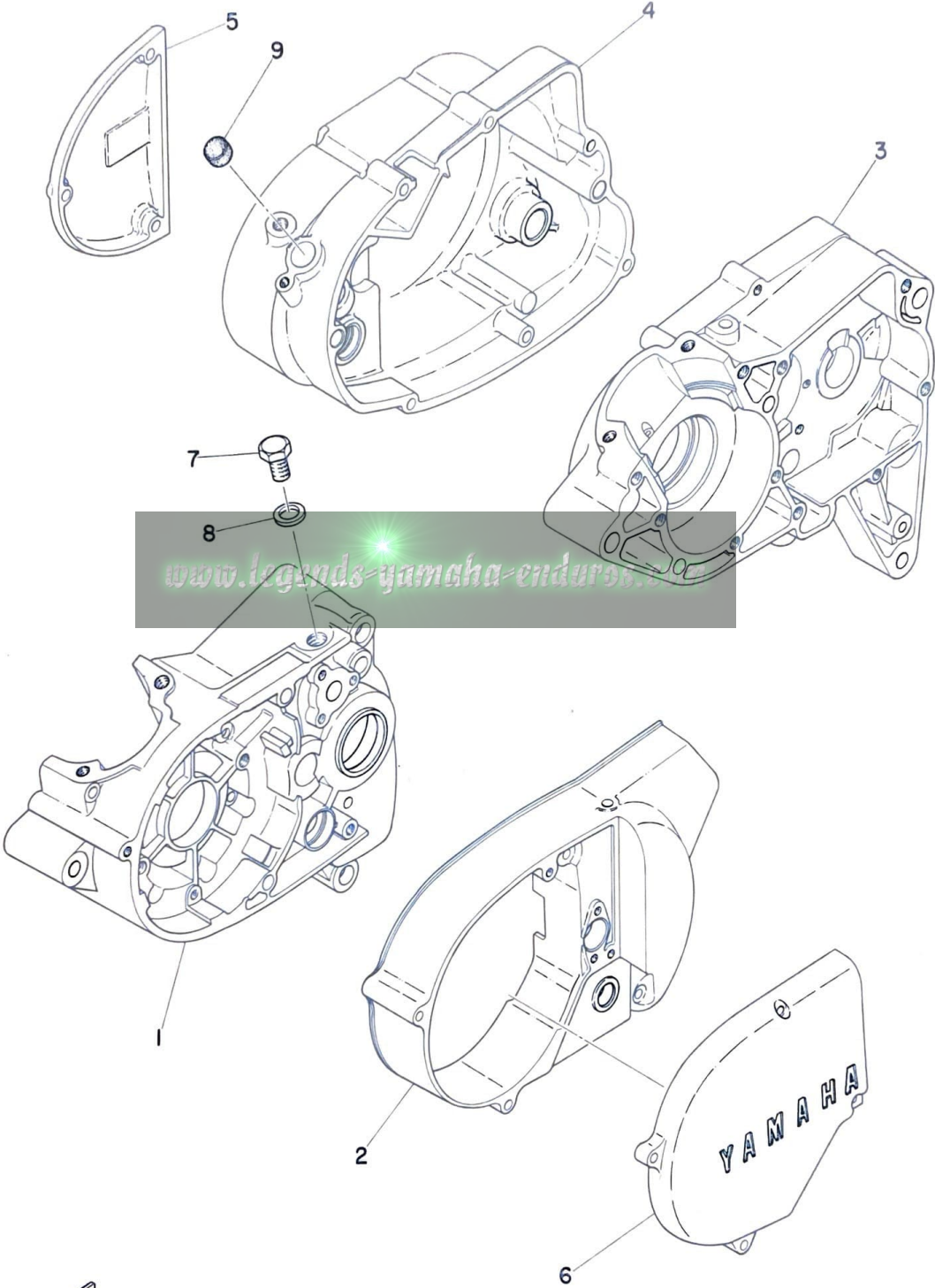

# CRANKCASE

| Ref. No. | Part No.     | Description                | Q'ty |    | Applicable Machine No. | Remarks |
|----------|--------------|----------------------------|------|----|------------------------|---------|
|          |              |                            | 2M   | MX |                        |         |
| 1- 1     | 318-15111-00 | CASE, crank left .....     |      | 1  |                        | Black   |
| 1- 2     | 318-15411-00 | COVER, crankcase left .... |      | 1  |                        | Black   |
| 1- 3     | 318-15121-00 | CASE, crank right .....    |      | 1  |                        | Black   |
| 1- 4     | 318-15421-00 | COVER, crankcase right ... |      | 1  |                        | Black   |
| 1- 5     | 318-15416-00 | COVER, oil pump .....      |      | 1  |                        | Black   |
| 1- 6     | 314-15415-00 | COVER, generater .....     |      | 1  |                        |         |
|          | 318-15415-00 | COVER, generater .....     |      | 1  |                        | Black   |
| 1- 7     | 288-18588-00 | PLUG, blind .....          | 1    | 1  |                        |         |
| 1- 8     | 136-82543-00 | GASKET .....               | 1    | 1  |                        |         |
| 1- 9     | 168-17481-00 | PLUG, blind .....          |      | 1  |                        |         |



Fig. 2 ENGINE

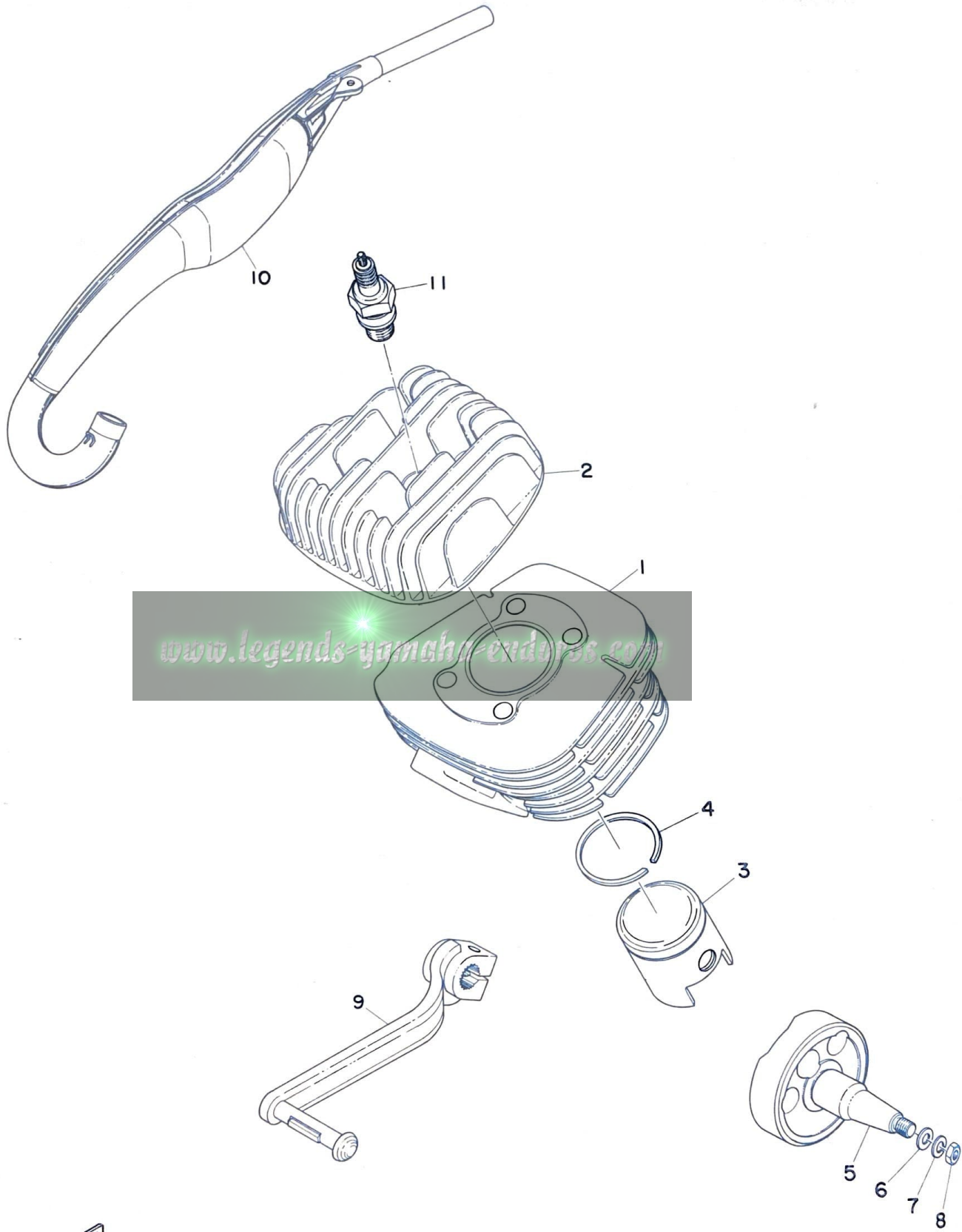

[www.legends-yamaha-riders.com](http://www.legends-yamaha-riders.com)



# ENGINE

| Ref. No. | Part No.        | Description                    | Q'ty   |        | Applicable<br>Machine No. | Remarks         |
|----------|-----------------|--------------------------------|--------|--------|---------------------------|-----------------|
|          |                 |                                | 2M     | MX     |                           |                 |
| 2- 1     | 318-11311-00    | CYLINDER .....                 | 1      |        |                           |                 |
|          | 318-11311-01    | CYLINDER .....                 |        | 1      |                           |                 |
| 2- 2     | 318-11111-00    | HEAD, cylinder .....           | 1      |        |                           |                 |
|          | 318-11111-01    | HEAD, cylinder .....           |        | 1      |                           | Black           |
| 2- 3     | 318-11631-00-96 | PISTON (STD 55.96mm) ....      | } U. R | } U. R |                           |                 |
|          | 318-11631-00-98 | PISTON (STD 55.98mm) ....      |        |        | 1                         | 1               |
|          | 318-11635-00    | PISTON (1st O.S 56.25mm) ...   | 1      | 1      |                           | Alternate parts |
|          | 318-11636-00    | PISTON (2nd O.S 56.50mm) ...   | 1      | 1      |                           | Alternate parts |
| 2- 4     | 248-11611-70    | RING, piston top (STD) .....   | 1      | 1      |                           |                 |
|          | 248-11611-80    | RING, piston top (1st O.S) ... | 1      | 1      |                           | Alternate parts |
|          | 248-11611-90    | RING, piston top (2nd O.S) ... | 1      | 1      |                           | Alternate parts |
| 2- 0-1   | 314-11400-00    | CRANK ASS'Y .....              | 1      | 1      |                           |                 |
| 2- 5     | 314-11412-00    | CRANK, left .....              | 1      | 1      |                           |                 |
| 2- 6     | 214-11557-01    | WASHER 1 (12.2-22-3.2) ...     | 1      | 1      |                           |                 |
| 2- 7     | 92901-12100     | WASHER, spring .....           | 1      | 1      |                           |                 |
| 2- 8     | 214-11555-01    | NUT, crankshaft .....          | 1      | 1      |                           |                 |
| 2- 9     | 248-18111-00-93 | PEDAL, change .....            | 1      | 1      |                           |                 |
| 2-10     | 318-14610-00    | EXHAUST PIPE ASS'Y .....       | 1      | 1      |                           |                 |
| 2-11     | 94701-00016     | PLUG, spark (B-9EN) .....      | 1      | 1      |                           |                 |



Fig. 3 TRANSMISSION

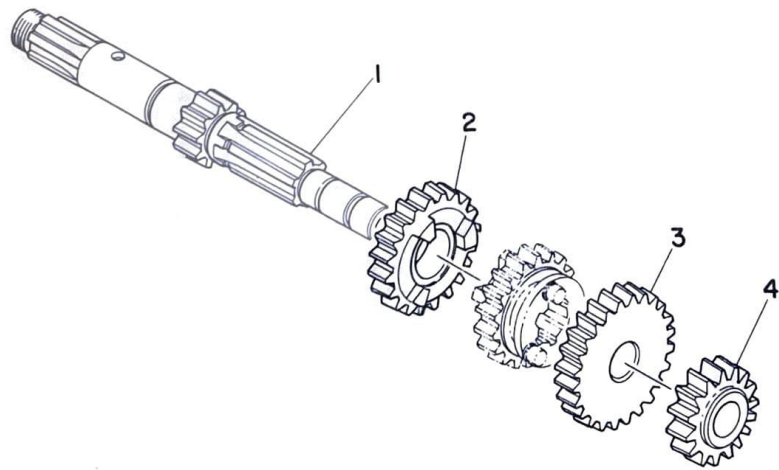
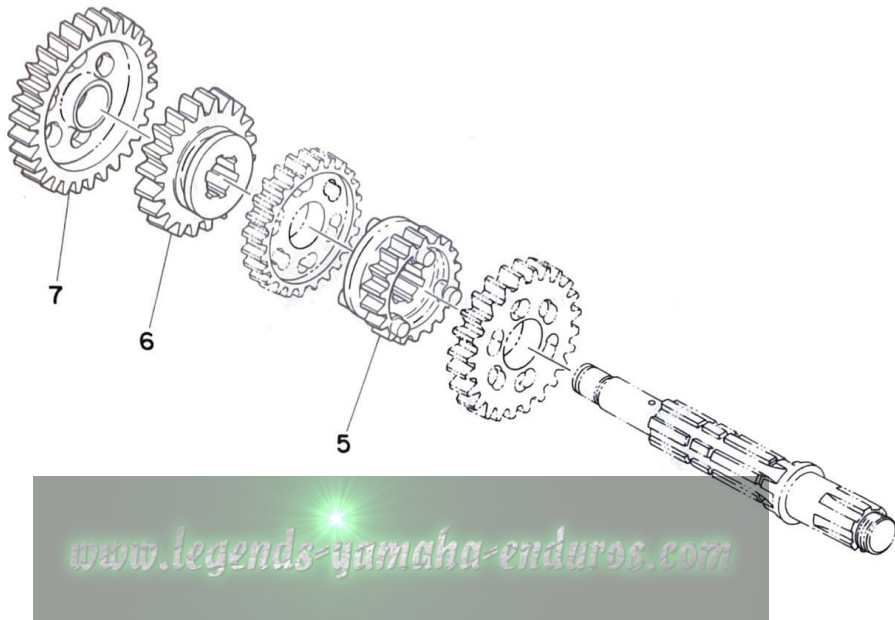

# TRANSMISSION

| Ref. No. | Part No.     | Description                   | Q'ty |    | Applicable<br>Machine No. | Remarks |
|----------|--------------|-------------------------------|------|----|---------------------------|---------|
|          |              |                               | 2M   | MX |                           |         |
| 3- 0-1   | 265-17401-00 | MAIN AXLE ASS'Y .....         | 1    |    |                           |         |
|          | 315-17401-01 | MAIN AXLE ASS'Y .....         |      | 1  |                           |         |
| 3- 1     | 265-17411-00 | . AXLE, main (12T) .....      | 1    |    |                           |         |
|          | 265-17411-01 | . AXLE, main (12T) .....      | 1    | 1  |                           |         |
| 3- 2     | 265-17141-00 | . GEAR, 4th pinion (22T) .... | 1    | 1  |                           |         |
| 3- 3     | 265-17151-00 | . GEAR, 5th pinion (23T) .... | 1    | 1  |                           |         |
| 3- 4     | 265-17121-01 | . GEAR, 2nd pinion (16T) .... | 1    |    |                           |         |
|          | 315-17121-00 | . GEAR, 2nd pinion (16T) .... |      | 1  |                           |         |
| 3- 5     | 315-17251-00 | GEAR, 5th wheel (22T) .....   | 1    | 1  |                           |         |
| 3- 6     | 265-17241-00 | GEAR, 4th wheel (24T) .....   | 1    | 1  |                           |         |
| 3- 7     | 265-17211-00 | GEAR, 1st wheel (34T) .....   | 1    | 1  |                           |         |

[www.legends-yamaha-enduros.com](http://www.legends-yamaha-enduros.com)



Fig. 4 INTAKE

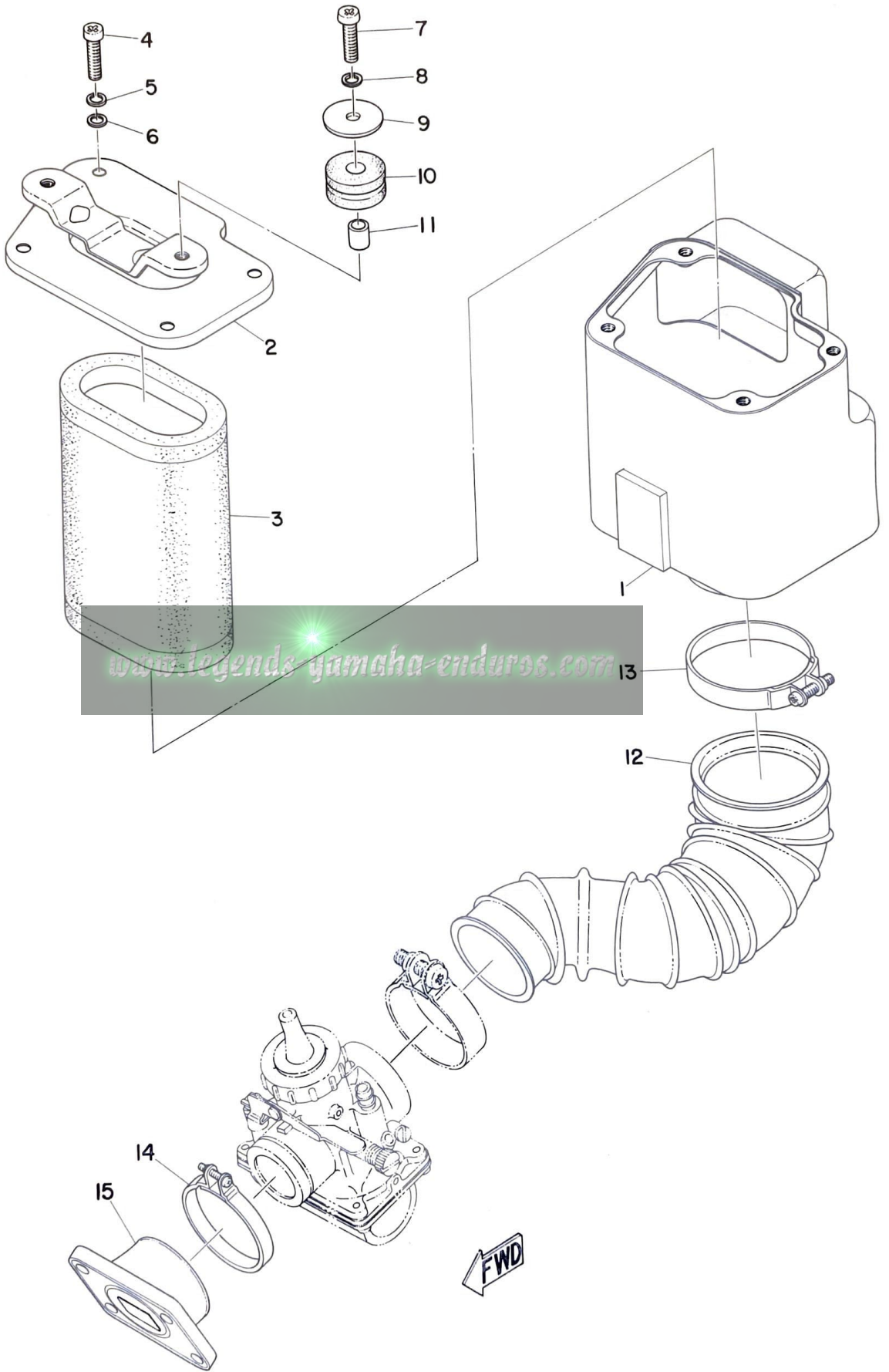

# INTAKE

| Ref. No. | Part No.     | Description                               | Q'ty |    | Applicable<br>Machine No. | Remarks |
|----------|--------------|---|------|----|---------------------------|---------|
|          |              |   | 2M   | MX |                           |         |
| 4- 1     | 318-14411-00 | CASE, air cleaner .....                   | 1    | 1  |                           |         |
| 4- 2     | 318-14412-00 | CAP, cleaner case .....                   | 1    | 1  |                           |         |
| 4- 3     | 318-14451-00 | ELEMENT, air cleaner .....                | 1    | 1  |                           |         |
| 4- 4     | 92501-06010  | SCREW, panhead .....                      | 4    | 4  |                           |         |
| 4- 5     | 92901-06100  | WASHER, spring .....                      | 4    | 4  |                           |         |
| 4- 6     | 92901-06200  | WASHER, plain .....                       | 4    | 4  |                           |         |
| 4- 7     | 92501-06025  | SCREW, panhead .....                      | 2    | 2  |                           |         |
| 4- 8     | 92901-06100  | WASHER, spring .....                      | 2    | 2  |                           |         |
| 4- 9     | 248-21757-00 | WASHER, special (6.5-28-1.6) ..           | 2    | 2  |                           |         |
| 4-10     | 248-21717-00 | DAMPER, battery box .....                 | 2    | 2  |                           |         |
| 4-11     | 214-21633-00 | COLLAR, fender mount<br>(7-10-11.5) ..... | 2    | 2  |                           |         |
| 4-12     | 318-14453-00 | JOINT, air cleaner .....                  | 1    | 1  |                           |         |
| 4-13     | 285-14455-00 | BAND .....                                | 1    | 1  |                           |         |
| 4-14     | 304-14455-70 | BAND .....                                | 1    | 1  |                           |         |
| 4-15     | 318-13565-00 | JOINT .....                               | 1    | 1  |                           |         |

Fig. 5 CARBURETOR

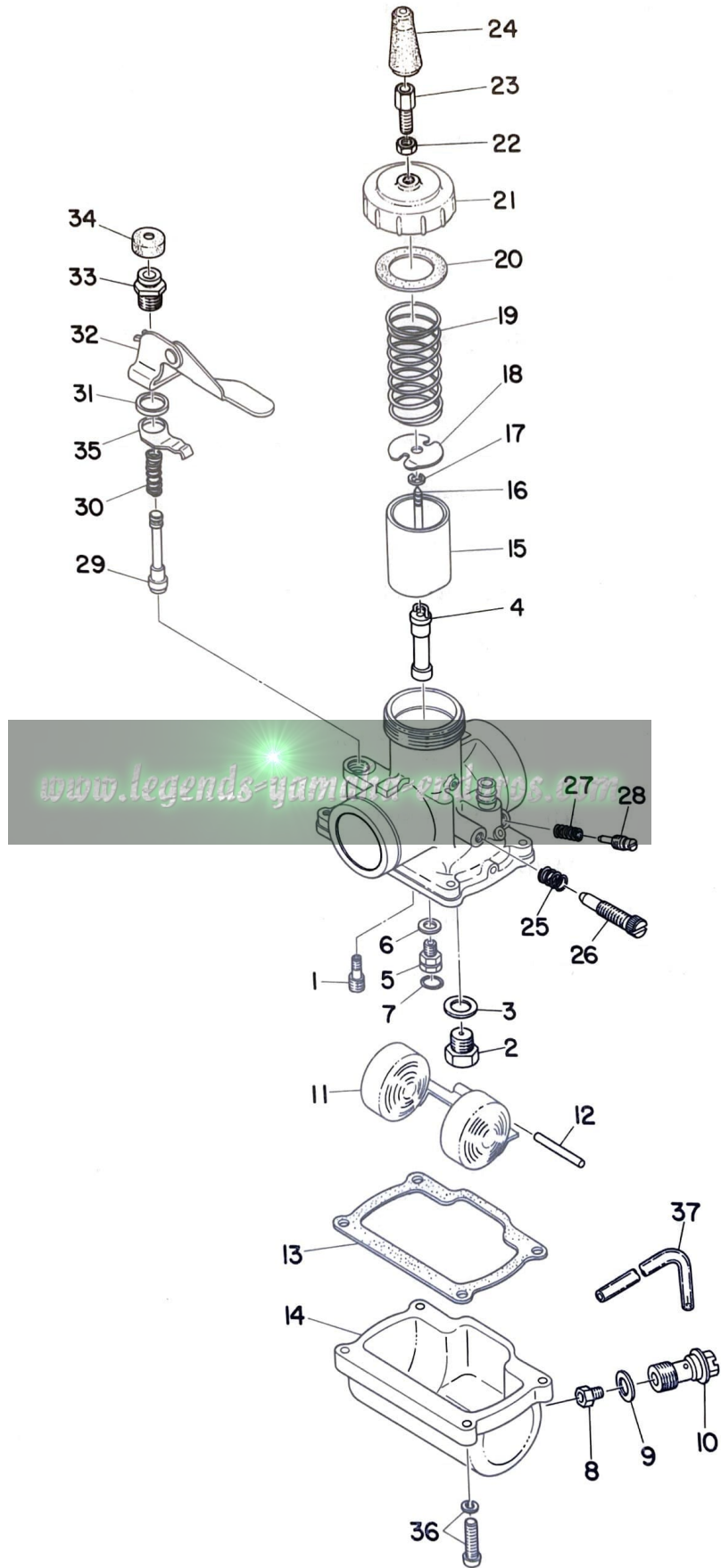

# CARBURETOR

| Ref. No. | Part No.        | Description               | Q'ty |    | Applicable<br>Machine No. | Remarks |
|----------|-----------------|---------------------------|------|----|---------------------------|---------|
|          |                 |                           | 2M   | MX |                           |         |
| 5- 0-1   | 318-14101-00    | CARBURETOR ASS'Y          | 1    | 1  |                           | VM26SC  |
| 5- 1     | 193-14142-60    | . JET, pilot (#60)        | 1    | 1  |                           |         |
| 5- 2     | 168-14190-25    | . VALVE SEAT ASS'Y (#2.5) | 1    | 1  |                           |         |
| 5- 3     | 214-14195-00    | . WASHER, valve seat      | 1    | 1  |                           |         |
| 5- 4     | 261-14141-28    | . NOZZLE, main (N-8)      | 1    | 1  |                           |         |
| 5- 5     | 248-14145-01    | . SETTER, needle jet      | 1    | 1  |                           |         |
| 5- 6     | 137-14153-00    | . WASHER, main jet        | 1    | 1  |                           |         |
| 5- 7     | 93210-04121     | . O-RING (1.78-4.47)      | 1    | 1  |                           |         |
| 5- 8     | 137-14143-36    | . JET, main (#180)        | 1    | 1  | U.R                       | STD     |
|          | 137-14143-38    | . JET, main (#190)        |      |    |                           |         |
|          | 137-14143-40    | . JET, main (#200)        |      |    |                           |         |
| 5- 9     | 248-14198-70    | . GASKET                  | 1    | 1  |                           |         |
| 5-10     | 248-14166-00-33 | . BOLT, banjo             | 1    | 1  |                           |         |
| 5-11     | 156-14185-00    | . FOLAT                   | 1    | 1  |                           |         |
| 5-12     | 137-14186-00    | . PIN, float              | 1    | 1  |                           |         |
| 5-13     | 156-14184-00    | . GASKET, float chamber   | 1    | 1  |                           |         |
| 5-14     | 248-14181-01-33 | . BODY, float chamber     | 1    | 1  |                           |         |
| 5-15     | 204-14112-25    | . VALVE, throttle (#2.5)  | 1    | 1  |                           |         |
| 5-16     | 152-14116-15    | . NEEDLE (4F15-3)         | 1    | 1  |                           |         |
| 5-17     | 164-14137-00    | . CLIP                    | 1    | 1  |                           |         |
| 5-18     | 246-14132-00    | . STOPPER, cable          | 1    | 1  |                           |         |
| 5-19     | 248-14131-00    | . SPRING, throttle valve  | 1    | 1  |                           |         |
| 5-20     | 246-14126-000   | . PACKING                 | 1    | 1  |                           |         |
| 5-21     | 802-14158-00-33 | . TOP, mixing chamber     | 1    | 1  |                           |         |

Fig. 5 CARBURETOR

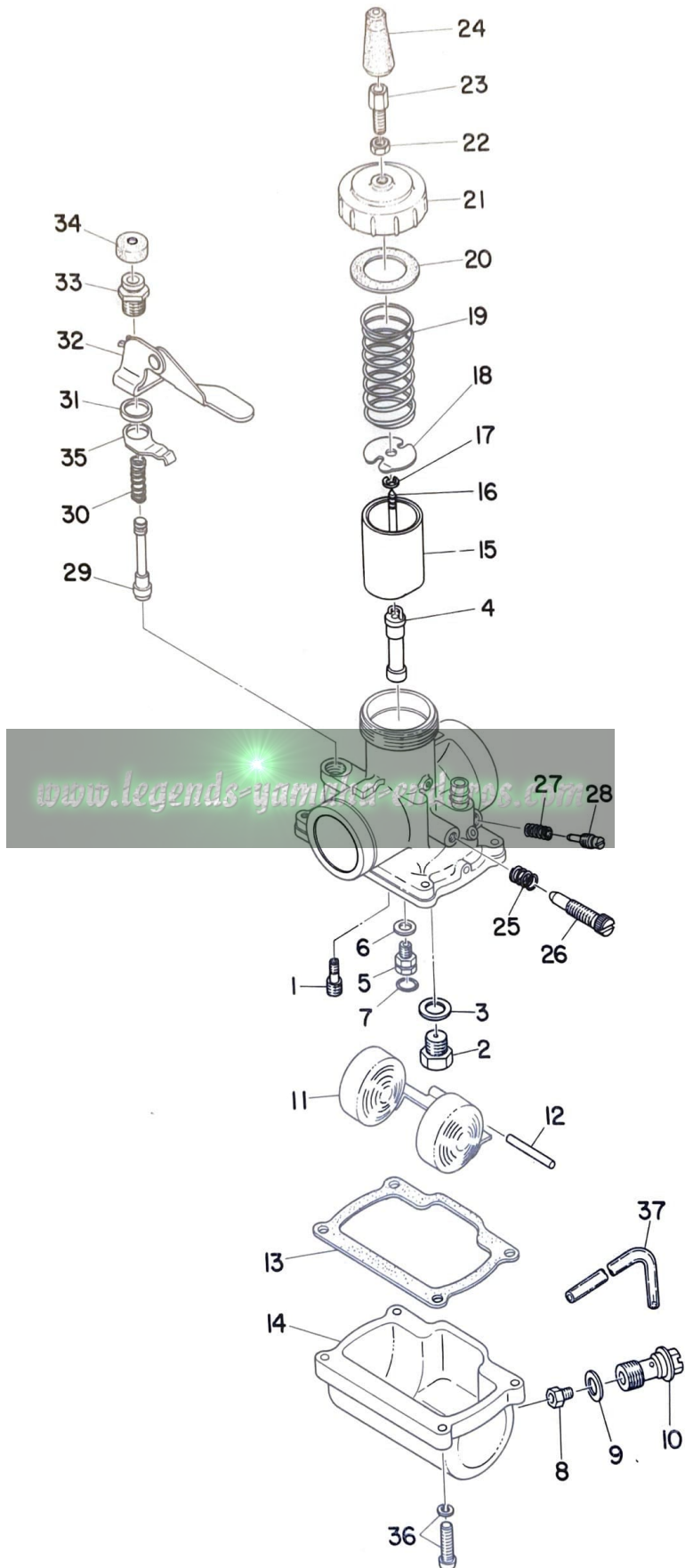



# CARBURETOR

| Ref. No. | Part No.        | Description               | Q'ty |    | Applicable<br>Machine No. | Remarks |
|----------|-----------------|---------------------------|------|----|---------------------------|---------|
|          |                 |                           | 2M   | MX |                           |         |
| 5-22     | 802-14161-00    | . NUT, wire adjusting     | 1    | 1  |                           |         |
| 5-23     | 127-14124-20    | . SCREW, wire adjusting   | 1    | 1  |                           |         |
| 5-24     | 802-14169-00    | . CAP                     | 1    | 1  |                           |         |
| 5-25     | 137-14133-00-33 | . SPRING, throttle stop   | 1    | 1  |                           |         |
| 5-26     | 204-14122-00-33 | . SCREW, throttle stop    | 1    | 1  |                           |         |
| 5-27     | 127-14134-00    | . SPRING, air adjusting   | 1    | 1  |                           |         |
| 5-28     | 152-14123-00-33 | . SCREW, air adjusting    | 1    | 1  |                           |         |
| 5-29     | 132-14171-00    | . PLUNGER, starter        | 1    | 1  |                           |         |
| 5-30     | 156-14135-00    | . SPRING, plunger         | 1    | 1  |                           |         |
| 5-31     | 132-14179-00    | . WASHER, starter lever   | 1    | 1  |                           |         |
| 5-32     | 214-14175-00-33 | . LEVER, starter          | 1    | 1  |                           |         |
| 5-33     | 132-14174-00-33 | . CAP, plunger            | 1    | 1  |                           |         |
| 5-34     | 132-14173-00    | . COVER, plunger cap      | 1    | 1  |                           |         |
| 5-35     | 170-14178-00-33 | . PLATE, starter lever    | 1    | 1  |                           |         |
| 5-36     | 308-14567-00    | . SCREW, panhead          | 4    | 4  |                           |         |
| 5-37     | 183-14196-00    | . PIPE, over flow (3-160) | 1    | 1  |                           |         |



Fig. 6 FLYWHEEL MAGNETO

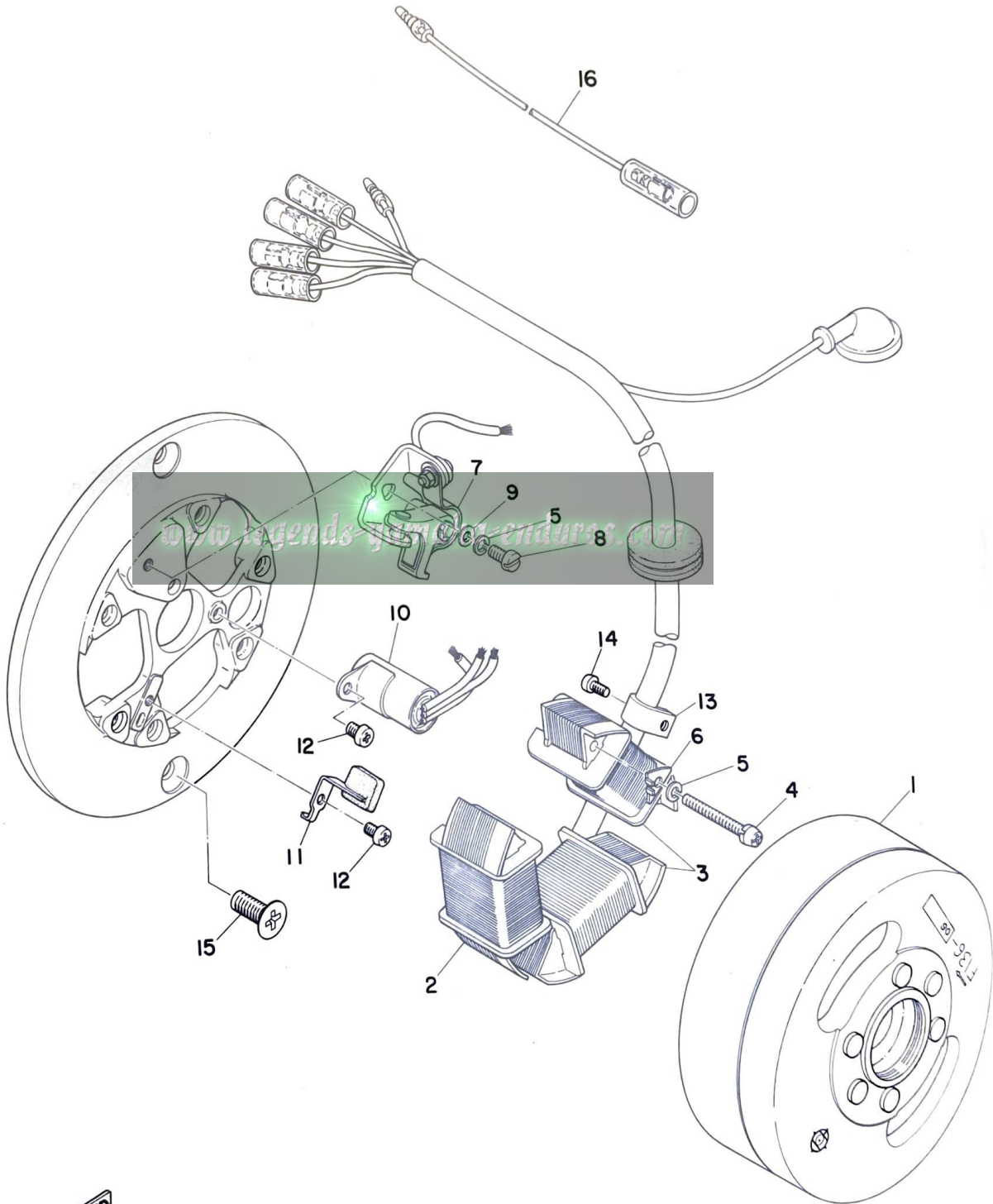

# FLYWHEEL MAGNETO

| Ref. No. | Part No.     | Description                  | Q'ty |    | Applicable<br>Machine No. | Remarks |
|----------|--------------|------------------------------|------|----|---------------------------|---------|
|          |              |                              | 2M   | MX |                           |         |
| 6- 0-1   | 314-81300-10 | FLYWHEEL MAGNETO ASS'Y ..    | 1    | 1  |                           |         |
| 6- 1     | 314-81350-10 | . ROTOR ASS'Y .....          | 1    | 1  |                           |         |
| 6- 2     | 277-81312-10 | . COIL, source .....         | 1    | 1  |                           |         |
| 6- 3     | 314-81313-10 | . LIGHTING COIL ASS'Y ....   | 1    | 1  |                           |         |
| 6- 4     | 110-81348-20 | . SCREW, panhead (4-25) ...  | 6    | 6  |                           |         |
| 6- 5     | 92901-04100  | . WASHER, spring .....       | 7    | 7  |                           |         |
| 6- 6     | 277-81332-10 | . PLATE, timing .....        | 1    | 1  |                           |         |
| 6- 7     | 207-81321-10 | . CONTACT BREAKER ASS'Y ..   | 1    | 1  |                           |         |
| 6- 8     | 110-81347-20 | . SCREW, panhead (4-12) .... | 1    | 1  |                           |         |
| 6- 9     | 92901-04200  | . WASHER, plain .....        | 1    | 1  |                           |         |
| 6-10     | 277-81326-10 | . CONDENSER .....            | 1    | 1  |                           |         |
| 6-11     | 207-81331-10 | . LUBRICATOR .....           | 1    | 1  |                           |         |
| 6-12     | 110-81345-20 | . SCREW, panhead (4-6) ....  | 2    | 2  |                           |         |
| 6-13     | 109-81328-10 | . CLAMP, lead .....          | 1    | 1  |                           |         |
| 6-14     | 110-81345-20 | . SCREW, panhead (4-6) ....  | 1    | 1  |                           |         |
| 6-15     | 98701-06012  | SCREW, flathead .....        | 2    | 2  |                           |         |
| 6-16     | 263-82319-00 | WIRE, sub lead .....         | 1    | 1  |                           |         |

[www.legends-yamaha-enduros.com](http://www.legends-yamaha-enduros.com)

Fig. 7 FRAME · REAR FENDER · SEAT

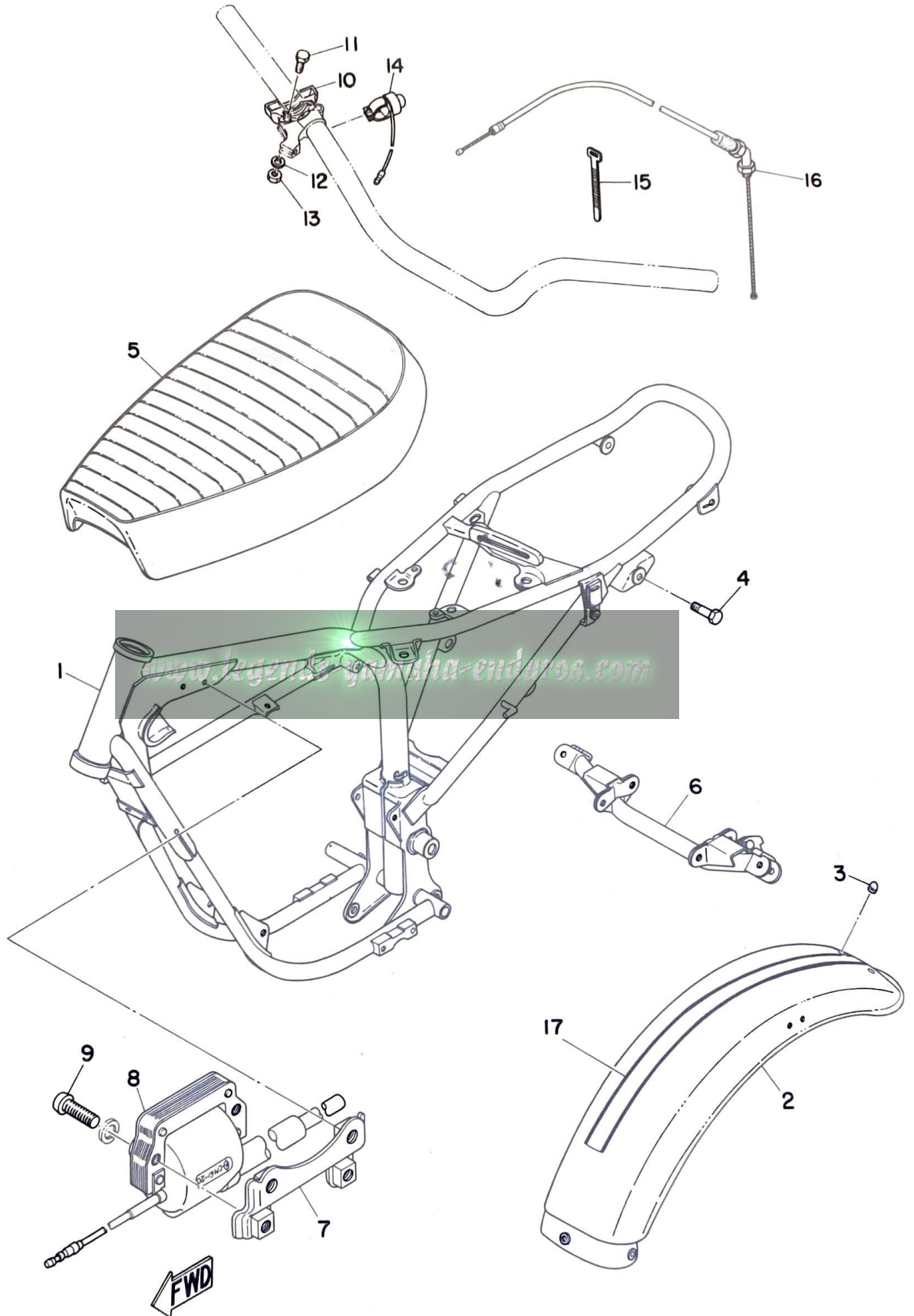

# FRAME · REAR FENDER · SEAT

| Ref. No. | Part No.        | Description                  | Q'ty |    | Applicable<br>Machine No. | Remarks     |
|----------|-----------------|------------------------------|------|----|---------------------------|-------------|
|          |                 |                              | 2M   | MX |                           |             |
| 7- 1     | 318-21110-00-33 | FRAME COMP. ....             | 1    | 1  |                           |             |
| 7- 2     | 248-21610-00-35 | REAR FENDER COMP. ....       | 1    |    |                           |             |
|          | 318-21610-00-Y1 | REAR FENDER COMP. ....       |      | 1  |                           | Silver Dust |
| 7- 3     | 170-21746-00    | DAMPER, cleaner stop ....    | 2    | 2  |                           |             |
| 7- 4     | 214-22241-00    | BOLT, rear cushion ....      | 2    | 2  |                           |             |
| 7- 5     | 318-24770-00    | SEMI DOUBLE SEAT ASS'Y ...   | 1    | 1  |                           |             |
| 7- 5-1   | 318-24771-00    | COVER, semi double seat .... | 1    | 1  |                           |             |
| 7- 6     | 248-27411-00    | FOOTREST ....                | 1    | 1  |                           |             |
| 7- 7     | 315-82316-00    | BRACKET, ignition coil ....  | 1    | 1  |                           |             |
| 7- 8     | 304-82310-30    | IGNITION COIL ASS'Y ....     | 1    | 1  |                           |             |
| 7- 9     | 92501-06025     | SCREW, pan head ....         | 2    | 2  |                           |             |
| 7-10     | 214-26282-01    | CAP, grip under ....         | 1    | 1  |                           |             |
| 7-11     | 91203-06020     | BOLT ....                    | 1    | 1  |                           |             |
| 7-12     | 92901-06100     | WASHER, spring ....          | 1    | 1  |                           |             |
| 7-13     | 98801-06300     | NUT ....                     | 1    | 1  |                           |             |
| 7-14     | 322-83976-00    | SWITCH, handle 1 ....        | 1    | 1  |                           |             |
| 7-15     | 803-82591-00    | BAND ....                    | 1    | 1  |                           |             |
| 7-16     | 318-26321-00    | WIRE, pump ....              | 1    | 1  |                           |             |
| 7-17     | 318-21619-00    | STRIPE fender ....           |      | 1  |                           |             |

www.legendary-yamaha-enduros.com

Fig. 8 FRONT FORK · FRONT FENDER

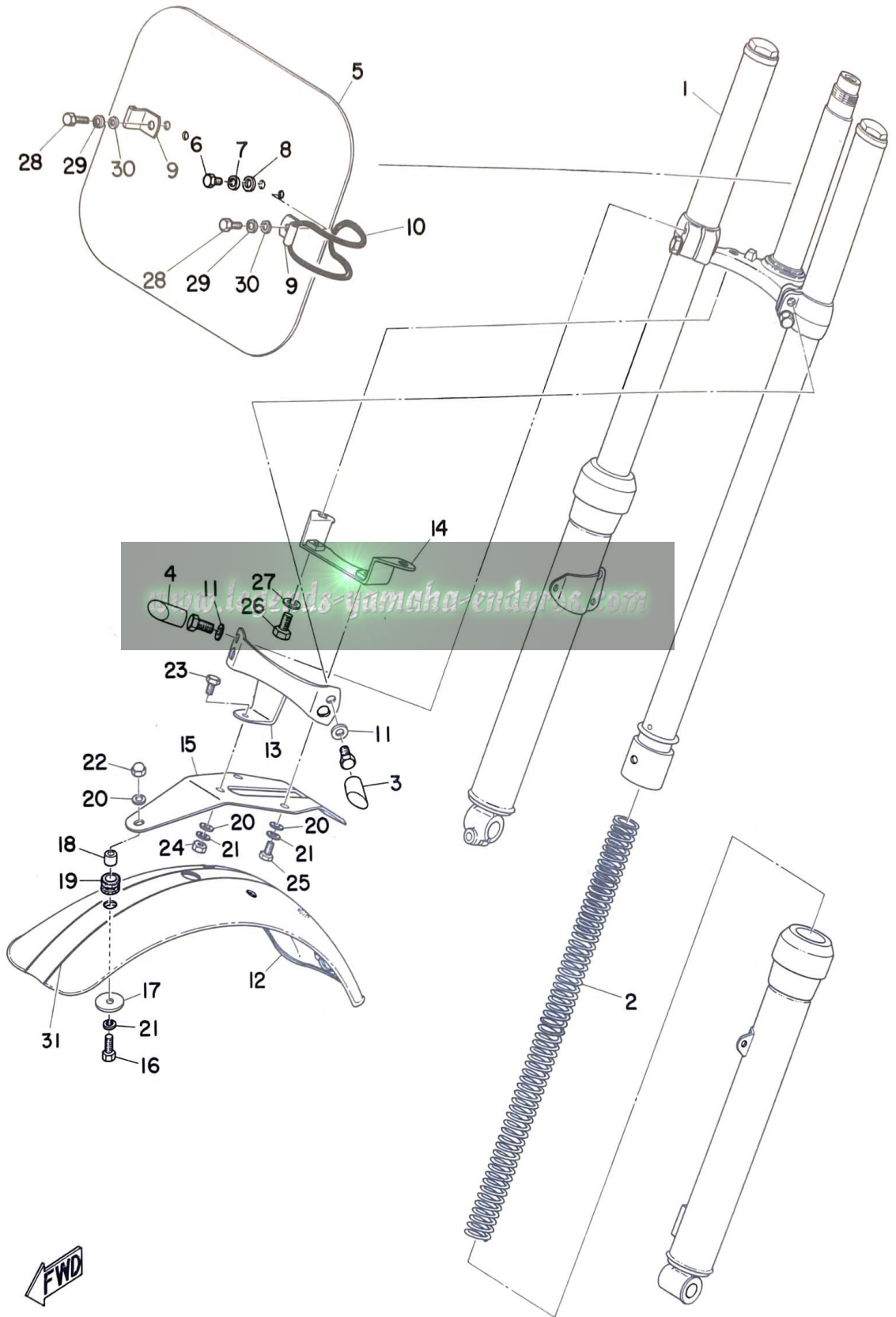



# FRONT FORK · FRONT FENDER

| Ref. No. | Part No.        | Description                     | Q'ty |    | Applicable<br>Machine No. | Remarks     |
|----------|-----------------|---------------------------------|------|----|---------------------------|-------------|
|          |                 |                                 | 2M   | MX |                           |             |
| 8- 1     | 318-23101-00    | FRONT FORK ASS'Y                | 1    | 1  |                           |             |
| 8- 2     | 318-23141-00    | . SPRING, fork                  | 2    | 2  |                           |             |
| 8- 3     | 263-21581-00    | . STAY, plate fitting left      | 1    | 1  |                           |             |
| 8- 4     | 263-21591-00    | . STAY, plate fitting right     | 1    | 1  |                           |             |
| 8- 5     | 263-23485-00    | PLATE, number                   | 1    | 1  |                           |             |
| 8- 6     | 91201-06015     | BOLT                            | 2    | 2  |                           |             |
| 8- 7     | 92901-06100     | WASHER, spring                  | 2    | 2  |                           |             |
| 8- 8     | 156-24187-00    | WASHER, special (6.5-26-166)    | 2    | 2  |                           |             |
| 8- 9     | 318-23487-00    | STAY, plate                     | 2    | 2  |                           |             |
| 8-10     | 93210-99103     | O-RING (3.1-99.4)               | 1    | 1  |                           |             |
| 8-11     | 92901-08200     | WASHER, plain                   | 2    | 2  |                           |             |
| 8-12     | 284-21510-00-35 | FRONT FENDER COMP.              | 1    |    |                           | Silver      |
|          | 284-21510-00-Y1 | FRONT FENDER COMP.              |      | 1  |                           | Silver Dust |
| 8-13     | 284-21513-00-35 | STAY, fender 1                  | 1    |    |                           | Silver      |
|          | 284-21513-00-Y1 | STAY, fender 1                  |      | 1  |                           | Silver Dust |
| 8-14     | 284-21514-00-35 | STAY, fender 2                  | 1    |    |                           | Silver      |
|          | 284-21514-00-Y1 | STAY, fender 2                  |      | 1  |                           | Silver Dust |
| 8-15     | 284-21512-00-35 | BRACKET, fender                 | 1    |    |                           | Silver      |
|          | 284-21512-00-Y1 | BRACKET, fender                 |      | 1  |                           | Silver Dust |
| 8-16     | 91201-06018     | BOLT                            | 2    | 2  |                           |             |
| 8-17     | 116-28324-00    | WASHER, leg shield (6.5-20-1.6) | 2    | 2  |                           |             |
| 8-18     | 256-21544-00    | COLLAR, fender mount            | 2    | 2  |                           |             |
| 8-19     | 256-21541-00    | DAMPER, fender mount            | 2    | 2  |                           |             |
| 8-20     | 92901-06200     | WASHER, plain                   | 5    | 5  |                           |             |



Fig. 8 FRONT FORK · FRONT FENDER

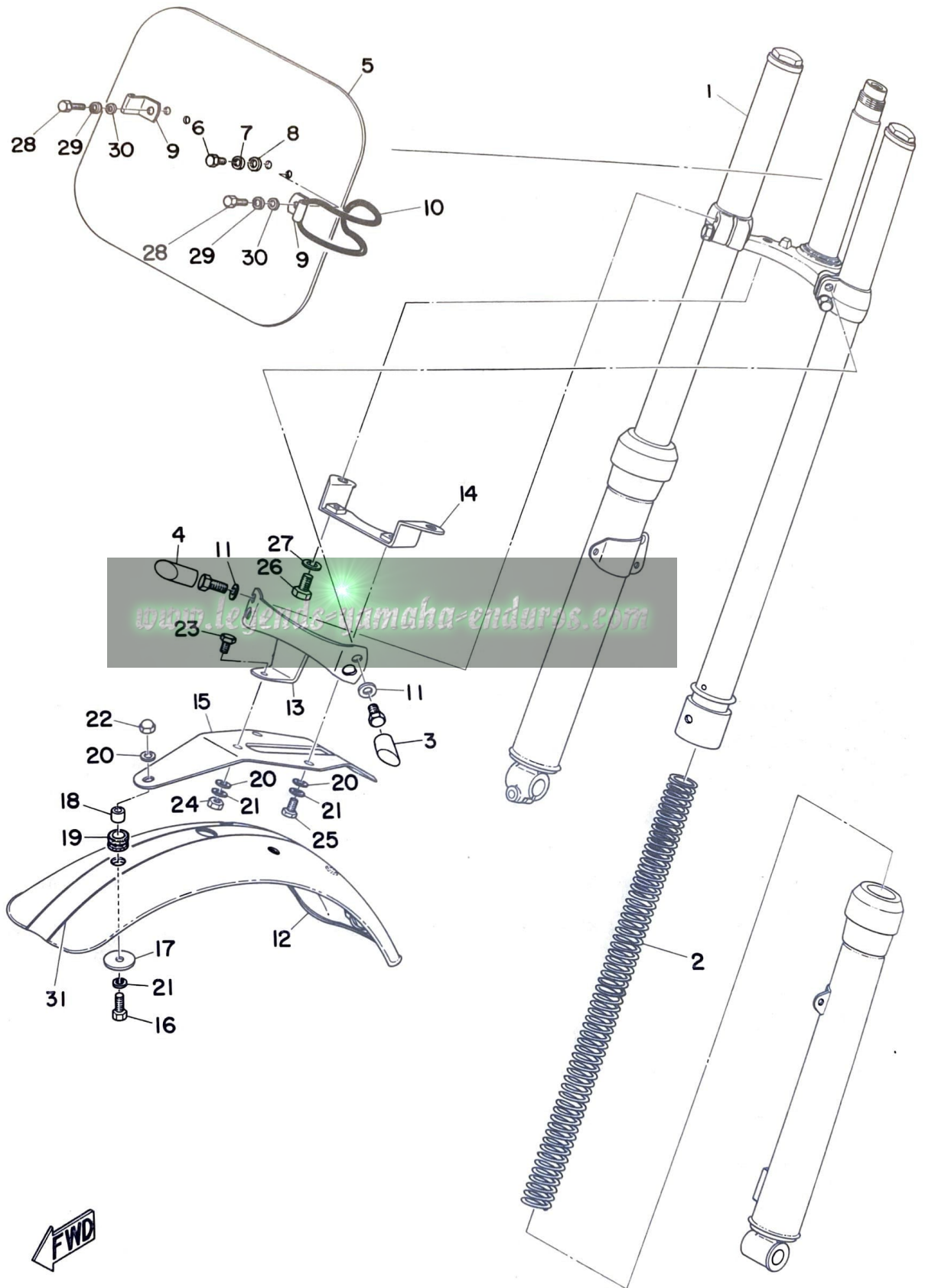

# FRONT FORK · FRONT FENDER

| Ref. No. | Part No.     | Description          | Q'ty |    | Applicable<br>Machine No. | Remarks |
|----------|--------------|----------------------|------|----|---------------------------|---------|
|          |              |                      | 2M   | MX |                           |         |
| 8-21     | 92901-06100  | WASHER, spring ..... | 5    | 5  |                           |         |
| 8-22     | 98802-06700  | NUT, crown .....     | 2    | 2  |                           |         |
| 8-23     | 91201-06012  | BOLT .....           | 1    | 1  |                           |         |
| 8-24     | 98801-06100  | NUT .....            | 1    | 1  |                           |         |
| 8-25     | 91201-06012  | BOLT .....           | 2    | 2  |                           |         |
| 8-26     | 97201-08015  | BOLT .....           | 2    | 2  |                           |         |
| 8-27     | 92901-08100  | WASHER, spring ..... | 2    | 2  |                           |         |
| 8-28     | 91201-06018  | BOLT .....           | 2    | 2  |                           |         |
| 8-29     | 92901-06100  | WASHER, spring ..... | 2    | 2  |                           |         |
| 8-30     | 92901-06200  | WASHER, plane .....  | 2    | 2  |                           |         |
| 8-31     | 318-21519-00 | STRIPE, fender ..... |      | 1  |                           |         |



Fig. 9 FUEL TANK · OIL TANK

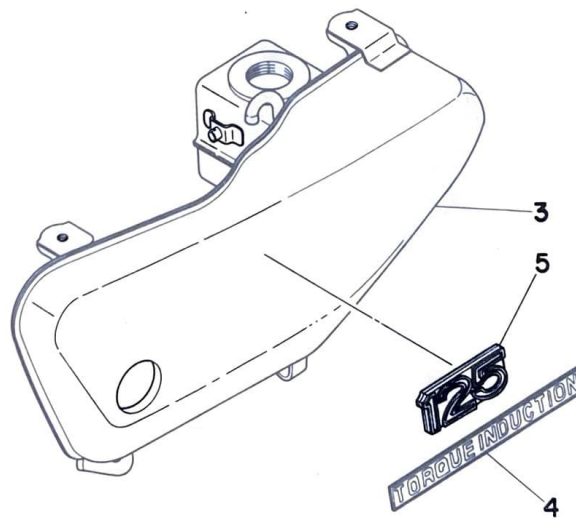
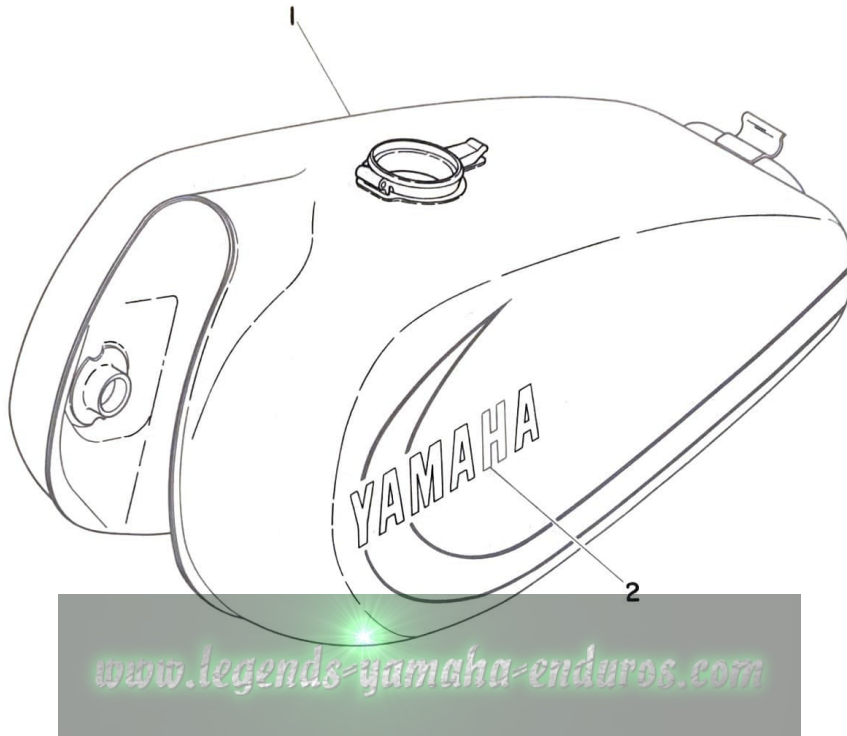

## FUEL TANK · OIL TANK

| Ref. No. | Part No.        | Description                 | Q'ty |    | Applicable<br>Machine No. | Remarks     |
|----------|-----------------|-----------------------------|------|----|---------------------------|-------------|
|          |                 |                             | 2M   | MX |                           |             |
| 9- 1     | 315-24110-00-04 | FUEL TANK COMP. ....        |      | 1  |                           | Silver Dust |
| 9- 2     | 322-24161-00    | EMBLEM, fuel-tank .....     |      | 2  |                           |             |
| 9- 3     | 315-21705-01-Y1 | TANK, oil .....             |      | 1  |                           | Silver Dust |
| 9- 4     | 308-21787-01    | EMBLEM, torque induction .. |      | 1  |                           |             |
| 9- 5     | 316-21786-00    | EMBLEM, 125 .....           |      | 1  |                           |             |

[www.legends-yamaha-enduros.com](http://www.legends-yamaha-enduros.com)

Fig. 10 FRONT , REAR WHEELS

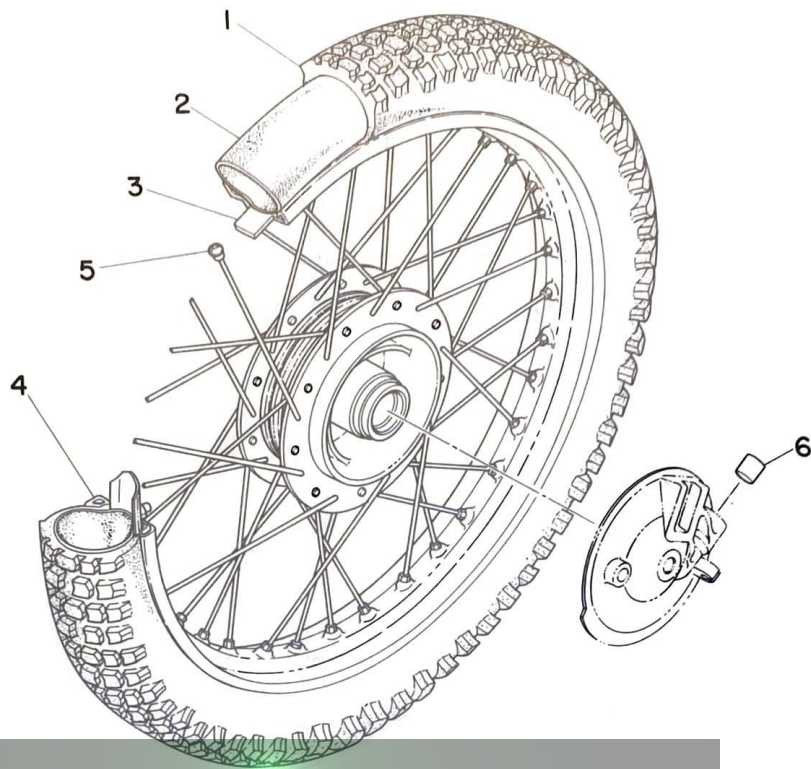

[www.legends-yamaha-enduros.com](http://www.legends-yamaha-enduros.com)

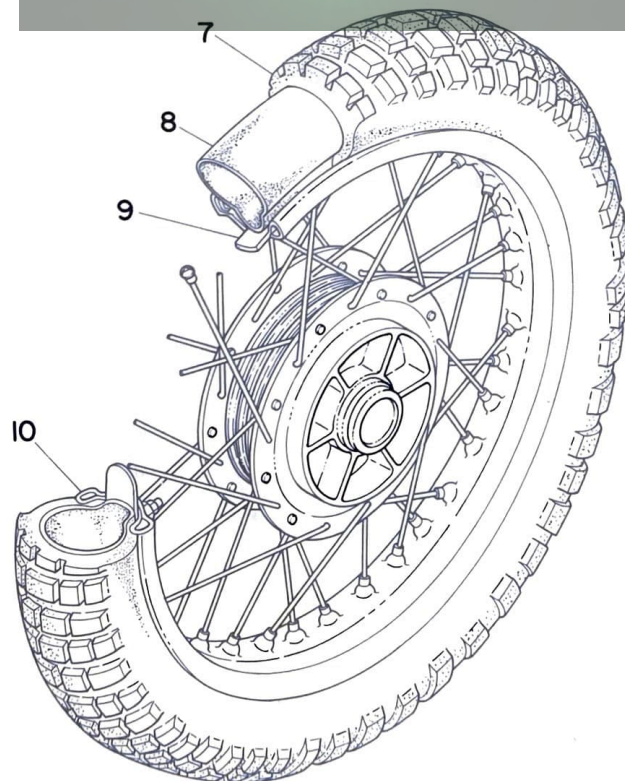



# FRONT , REAR WHEELS

| Ref. No. | Part No.     | Description                   | Q'ty |    | Applicable<br>Machine No. | Remarks        |
|----------|--------------|-------------------------------|------|----|---------------------------|----------------|
|          |              |                               | 2M   | MX |                           |                |
| 10- 1    | 94127-21071  | TIRE, front (2.75-21-4PR) ... | 1    | 1  |                           | Knobby pattern |
| 10- 2    | 94227-21031  | TUBE (2.75-21) .....          | 1    | 1  |                           |                |
| 10- 3    | 94327-21024  | BAND, rim (2.75-21) .....     | 1    | 1  |                           |                |
| 10- 4    | 94416-21044  | RIM (1.60A-21) .....          | 1    | 1  |                           |                |
| 10- 5    | 248-25104-10 | SPOKE SET .....               | 1s   | 1s |                           |                |
| 10- 6    | 152-25139-00 | PLUG, blind .....             | 1    | 1  |                           |                |
| 10- 7    | 94135-18094  | TIRE, rear (3.50-18-4PR) ...  | 1    | 1  |                           | Knobby pattern |
| 10- 8    | 94235-18022  | TUBE (3.50-18) .....          | 1    | 1  |                           |                |
| 10- 9    | 94335-18018  | BAND, rim (3.50-18) .....     | 1    | 1  |                           |                |
| 10-10    | 94418-18045  | RIM (1.80-18) .....           | 1    | 1  |                           |                |





# NUMERICAL INDEX

| Ref No. | Parts No.       | Ref No. | Parts No.       | Ref No. | Parts No.       |
|---------|-----------------|---------|-----------------|---------|-----------------|
| 6-13    | 109-81328-10    | 2- 6    | 214-11557-01    | 6- 2    | 277-81312-10    |
| 6-12    | 110-81345-20    | 5-32    | 214-14175-00-33 | 6-10    | 277-81326-10    |
| 6-14    | 110-81345-20    | 5- 3    | 214-14195-00    | 6- 6    | 277-81332-10    |
| 6- 8    | 110-81347-20    | 4-11    | 214-21633-00    | 8-12    | 284-21510-00-Y1 |
| 6- 4    | 110-81348-20    | 7- 4    | 214-22241-00    | 8-15    | 284-21512-00-35 |
| 8-17    | 116-28324-00    | 7-10    | 214-26282-01    | 8-15    | 284-21512-00-Y1 |
| 5-23    | 127-14124-20    | 5-20    | 246-14126-000   | 8-13    | 284-21513-00-35 |
| 5-27    | 127-14134-00    | 5-18    | 246-14132-00    | 8-13    | 284-21513-00-Y1 |
| 5-29    | 132-14171-00    | 2- 4    | 248-11611-70    | 8-14    | 284-21514-00-35 |
| 5-34    | 132-14173-00    | 2- 4    | 248-11611-80    | 8-14    | 284-21514-00-Y1 |
| 5-33    | 132-14174-00-33 | 2- 4    | 248-11611-90    | 4-13    | 285-14455-00    |
| 5-31    | 132-14179-00    | 5-19    | 248-14131-00    | 1- 7    | 288-18588-00    |
| 1- 8    | 136-82543-00    | 5- 5    | 248-14145-01    | 4-14    | 304-14455-70    |
| 5-25    | 137-14133-00-33 | 5-10    | 248-14166-00-33 | 7- 8    | 304-82310-30    |
| 5- 8    | 137-14143-36    | 5-14    | 248-14181-01-33 | 5-36    | 308-14567-00    |
| 5- 8    | 137-14143-38    | 5- 9    | 248-14198-70    | 9- 4    | 308-21787-01    |
| 5- 8    | 137-14143-40    | 2- 9    | 248-18111-00-93 | 2- 0-1  | 314-11400-00    |
| 5- 6    | 137-14153-00    | 8-12    | 284-21510-00-35 | 2- 5    | 314-11412-00    |
| 5-12    | 137-14186-00    | 7- 2    | 248-21610-00-35 | 1- 6    | 314-15415-00    |
| 5-16    | 152-14116-15    | 4-10    | 248-21717-00    | 6- 0-1  | 314-81300-10    |
| 5-28    | 152-14123-00-33 | 4- 9    | 248-21757-00    | 6- 3    | 314-81313-10    |
| 10- 6   | 152-25139-00    | 10- 5   | 248-25104-10    | 6- 1    | 314-81350-10    |
| 5-30    | 156-14135-00    | 7- 6    | 248-27411-00    | 3- 4    | 315-17121-00    |
| 5-13    | 156-14184-00    | 8-19    | 256-21541-00    | 3- 5    | 315-17251-00    |
| 5-11    | 156-14185-00    | 8-18    | 256-21544-00    | 3- 0-1  | 315-17401-01    |
| 8- 8    | 156-24187-00    | 5- 4    | 261-14141-28    | 9- 3    | 315-21705-01-Y1 |
| 5-17    | 164-14137-00    | 8- 3    | 263-21581-00    | 9- 1    | 315-24110-00-04 |
| 5- 2    | 168-14190-25    | 8- 4    | 263-21591-00    | 7- 7    | 315-82316-00    |
| 1- 9    | 168-17481-00    | 8- 5    | 263-23485-00    | 9- 5    | 316-21786-00    |
| 5-35    | 170-14178-00-33 | 6-16    | 263-82319-00    | 2- 2    | 318-11111-00    |
| 7- 3    | 170-21746-00    | 3- 4    | 265-17121-01    | 2- 2    | 318-11111-01    |
| 5-37    | 183-14196-00    | 3- 2    | 265-17141-00    | 2- 1    | 318-11311-00    |
| 5- 1    | 193-14142-60    | 3- 3    | 265-17151-00    | 2- 1    | 318-11311-01    |
| 5-15    | 204-14112-25    | 3- 7    | 265-17211-00    | 2- 3    | 318-11631-00-96 |
| 5-26    | 204-14122-00-33 | 3- 6    | 265-17241-00    | 2- 3    | 318-11631-00-98 |
| 6- 7    | 207-81321-10    | 3- 0-1  | 265-17401-00    | 2- 3    | 318-11635-00    |
| 6-11    | 207-81331-10    | 3- 1    | 265-17411-00    | 2- 3    | 318-11636-00    |
| 2- 8    | 214-11555-01    | 3- 1    | 265-17411-01    | 4-15    | 318-13565-00    |

# NUMERICAL INDEX

| Ref No. | Parts No.       | Ref No. | Parts No.   | Ref No. | Parts No. |
|---------|-----------------|---------|-------------|---------|-----------|
| 5- 0-1  | 318-14101-00    | 6- 9    | 92901-04200 |         |           |
| 4- 1    | 318-14411-00    | 4- 5    | 92901-06100 |         |           |
| 4- 2    | 318-14412-00    | 4- 8    | 92901-06100 |         |           |
| 4- 3    | 318-14451-00    | 7-12    | 92901-06100 |         |           |
| 4-12    | 318-14453-00    | 8- 7    | 92901-06100 |         |           |
| 2-10    | 318-14610-00    | 8-21    | 92901-06100 |         |           |
| 1- 1    | 318-15111-00    | 8-29    | 92901-06100 |         |           |
| 1- 3    | 318-15121-00    | 4- 6    | 92901-06200 |         |           |
| 1- 2    | 318-15411-00    | 8-20    | 92901-06200 |         |           |
| 1- 6    | 318-15415-00    | 8-30    | 92901-06200 |         |           |
| 1- 5    | 318-15416-00    | 8-27    | 92901-08100 |         |           |
| 1- 4    | 318-15421-00    | 8-11    | 92901-08200 |         |           |
| 7- 1    | 318-21110-00-33 | 2- 7    | 92901-12100 |         |           |
| 8-31    | 318-21519-00    | 5- 7    | 93210-04121 |         |           |
| 7- 2    | 318-21610-00-Y1 | 8-10    | 93210-99103 |         |           |
| 7-17    | 318-21619-00    | 10- 1   | 94127-21071 |         |           |
| 8- 1    | 318-23101-00    | 10- 7   | 94135-18094 |         |           |
| 8- 2    | 318-23141-00    | 10- 2   | 94227-21031 |         |           |
| 8- 9    | 318-23487-00    | 10- 8   | 94235-18022 |         |           |
| 7- 5    | 318-24770-00    | 10- 3   | 94327-21024 |         |           |
| 7- 5-1  | 318-24771-00    | 10- 9   | 94335-18018 |         |           |
| 7-16    | 318-26321-00    | 10- 4   | 94416-21044 |         |           |
| 9- 2    | 322-24161-00    | 10-10   | 94418-18045 |         |           |
| 7-14    | 322-83976-00    | 2-11    | 94701-00016 |         |           |
| 5-21    | 802-14158-00-33 | 8-26    | 97201-08015 |         |           |
| 5-22    | 802-14161-00    | 6-15    | 98701-06012 |         |           |
| 5-24    | 802-14169-00    | 8-24    | 98801-06100 |         |           |
| 7-15    | 803-82591-00    | 7-13    | 98801-06300 |         |           |
| 8-23    | 91201-06012     | 8-22    | 98802-06700 |         |           |
| 8-25    | 91201-06012     |         |             |         |           |
| 8- 6    | 91201-06015     |         |             |         |           |
| 8-16    | 91201-06018     |         |             |         |           |
| 8-28    | 91201-06018     |         |             |         |           |
| 7-11    | 91203-06020     |         |             |         |           |
| 4- 4    | 92501-06010     |         |             |         |           |
| 4- 7    | 92501-06025     |         |             |         |           |
| 7- 9    | 92501-06025     |         |             |         |           |
| 6- 5    | 92901-04100     |         |             |         |           |

[www.legends-yamaha-enduros.com](http://www.legends-yamaha-enduros.com)



**YAMAHA MOTOR CO., LTD.**

**PRINTED IN JAPAN**  
**Second edition Jul, 1972**  
**(LIT-10013-18-01)**  
**(318-82)**