

MODEL AT2M

www.legends-yamaha-enduros.com

This Parts List is for the exclusive parts for the AT2M.
Please refer to AT2 Parts List for the parts not listed in
this publication.

CONTENTS

Fig. 1	Engine	1
Fig. 2	Transmission	3
Fig. 3	Air Cleaner	5
Fig. 4	Carburetor	7
Fig. 5	Flywheel Magneto	11
Fig. 6	Frame · Rear Fender · Seat	13
Fig. 7	Front Fork · Front Fender	15
Fig. 8	Front, Rear Wheels	19

NUMERICAL INDEX

Fig. 1 ENGINE

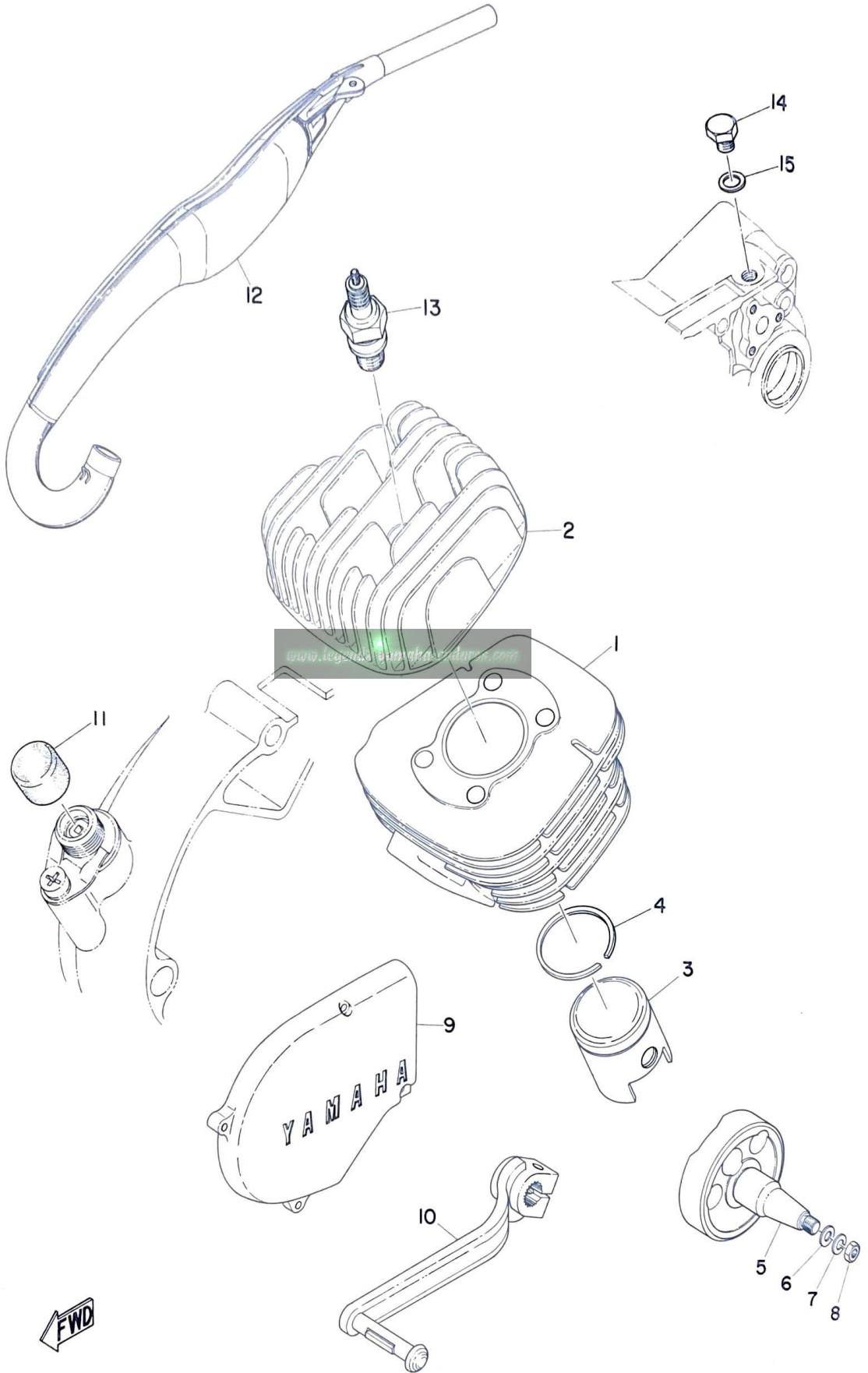

ENGINE

Ref. No.	Parts No.	Description	Q'ty	Applicable Machine No.	Remarks
1 -1	318-11311-00	CYLINDER	1		
1- 2	318-11111-00	HEAD, cylinder	1		
1- 3	318-11631-00-96	PISTON (STD 55.96mm)	} U.R 1		
	318-11631-00-97	PISTON (STD 55.97mm)			
	318-11631-00-98	PISTON (STD 55.98mm)			
	318-11635-00	PISTON (1st O.S 56.25mm) ...	1		Alternate parts
	318-11636-00	PISTON (2nd O.S 56.50mm) ...	1		Alternate parts
1- 4	248-11611-70	RING, piston top (STD)	1		
	248-11611-80	RING, piston top (1st O.S)	1		Alternate parts
	248-11611-90	RING, piston top (2nd O.S)	1		Alternate parts
1- 0-1	314-11410-00	CRANK ASS'Y	1		
1- 5	314-11412-00	CRANK, left	1		
		www.legends-yamaha-enduros.com			
1- 6	214-11557-01	WASHER 1 (12.2-22-3.2)	1		
1- 7	92901-12100	WASHER, spring	1		
1- 8	214-11555-01	NUT, crankshaft	1		
1- 9	314-15415-00	COVER, generator	1		
1-10	248-18111-00-93	PEDAL, change	1		
1-11	168-17481-00	PLUG, blind	1		
1-12	318-14610-00	EXHAUST PIPE ASS'Y	1		
1-13	94701-00016	PLUG, spark (B-9EN)	1		
1-14	288-18588-00	PLUG, blind	1		
1-15	136-82543-00	GASKET	1		

Fig. 2 TRANSMISSION

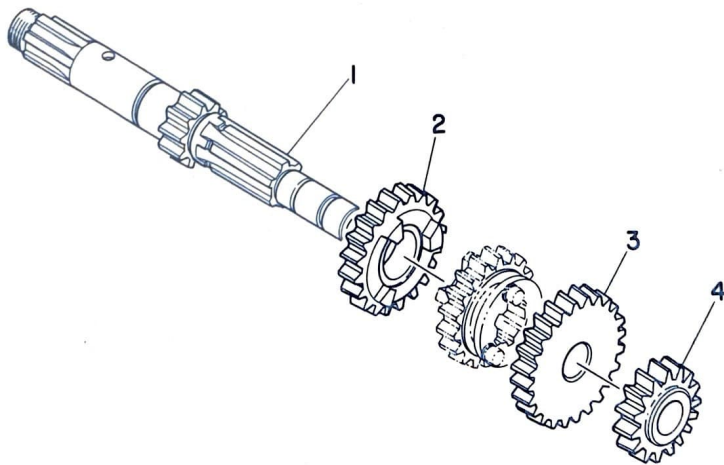
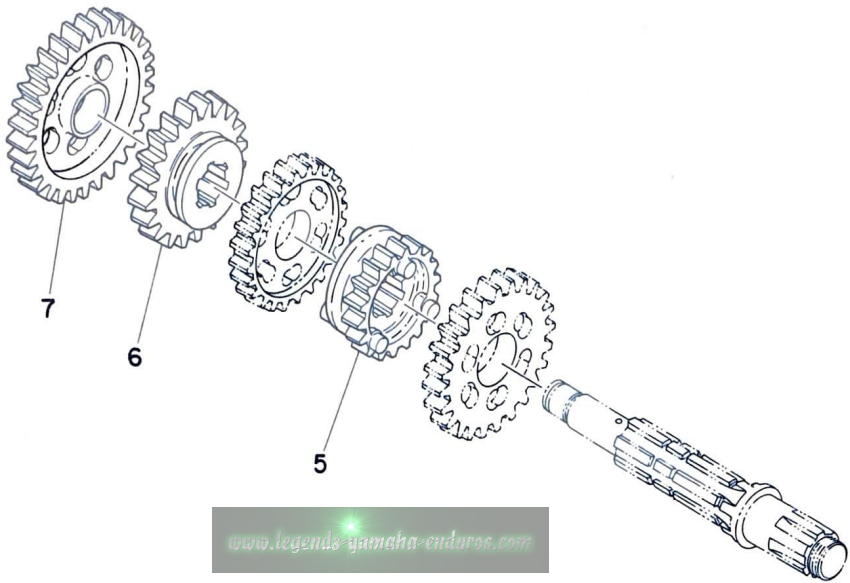

TRANSMISSION

Ref. No.	Parts No.	Description	Q'ty	Applicable Machine No.	Remarks
2- 1	265-17411-00	AXLE, main (12T)	1		
2- 2	265-17141-00	GEAR, 4th pinion (22T)	1		
2- 3	265-17151-00	GEAR, 5th pinion (23T)	1		
2- 4	265-17121-01	GEAR, 2nd pinion (16T)	1		
2- 5	315-17251-00	GEAR, 5th wheel (22T)	1		
2- 6	265-17241-00	GEAR, 4th wheel (24T)	1		
2- 7	265-17211-00	GEAR, 1st wheel (34T)	1		

www.legends-yamaha-enduros.com

Fig. 3 AIR CLEANER

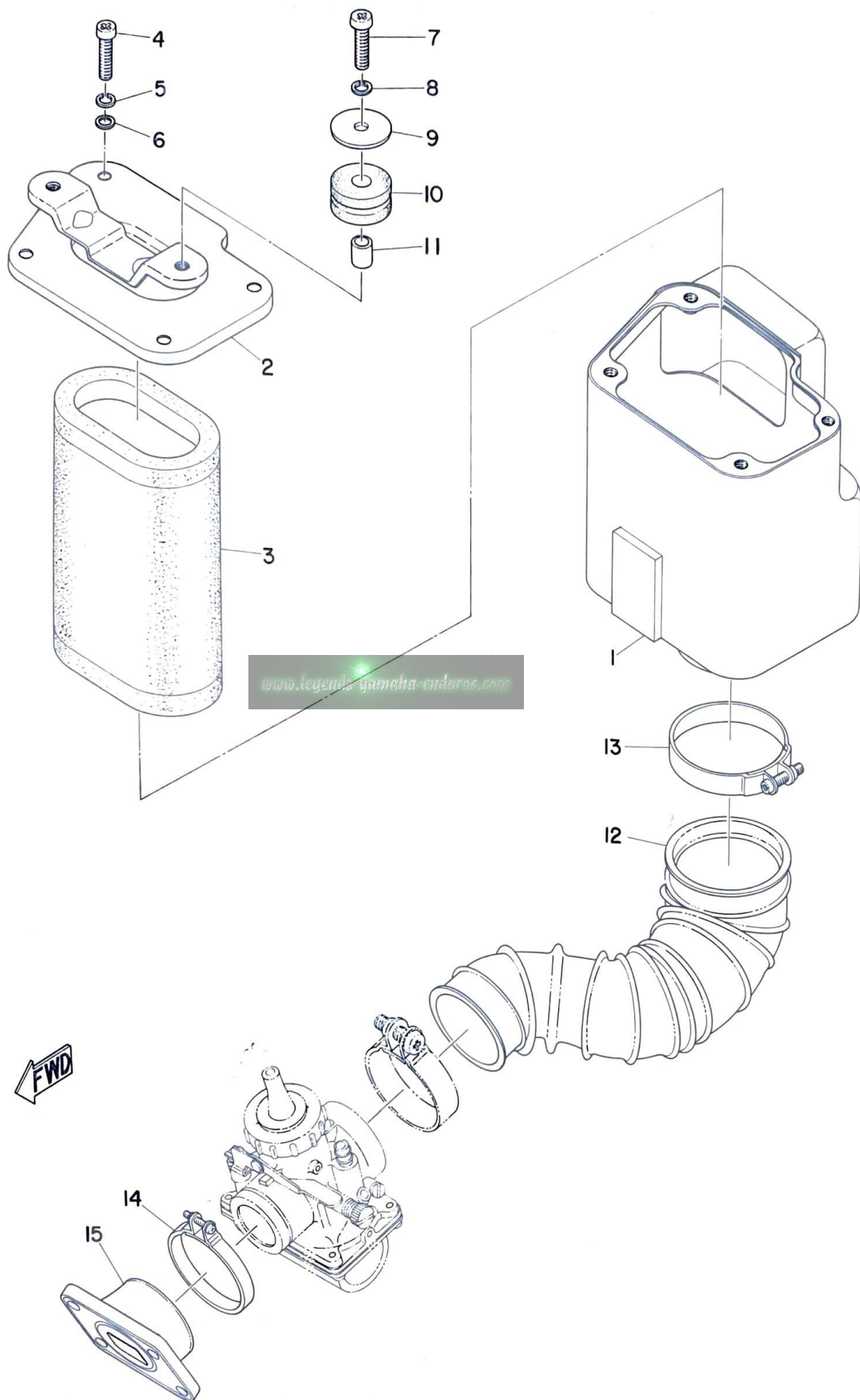

FWD

AIR CLEANER

Ref. No.	Parts No.	Description	Q'ty	Applicable Machine No.	Remarks
3- 1	318-14411-00	CASE, air cleaner	1		
3- 2	318-14412-00	CAP, cleaner case	1		
3- 3	318-14451-00	ELEMENT, air cleaner	1		
3- 4	92501-06010	SCREW, pan head	4		
3- 5	92901-06100	WASHER, spring	4		
3- 6	92901-06200	WASHER, plain	4		
3- 7	92501-06025	SCREW, pan head	2		
3- 8	92901-06100	WASHER, spring	2		
3- 9	248-21757-00	WASHER, special (6.5-28-1.6) ..	2		
3-10	248-21717-00	DAMPER, battery box	2		
3-11	214-21633-00	COLLAR, fender mount (7-10-11.5)	2		
3-12	318-14453-00	JOINT, air cleaner	1		
3-13	285-14455-00	BAND	1		
3-14	304-14455-70	BAND	1		
3-15	318-13565-00	JOINT	1		

www.legends-yamaha-enduros.com

Fig. 4 CARBURETOR

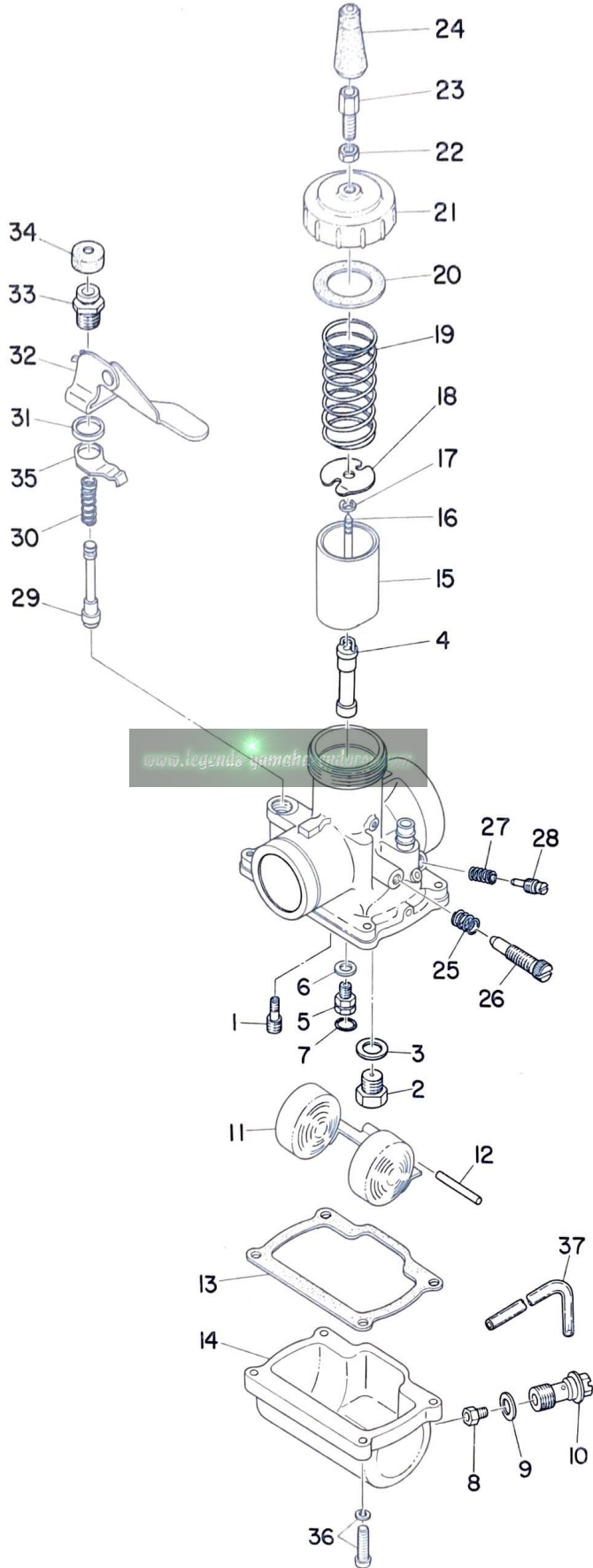

CARBURETOR

Ref. No.	Parts No.	Description	Q'ty	Applicable Machine No.	Remarks
4- 0-1	318-14101-00	CARBURETOR ASS'Y	1		VM26SC
4- 1	193-14142-60	. JET, pilot (#60)	1		
4- 2	168-14190-25	. VALVE SEAT ASS'Y (#2.5)	1		
4- 3	214-14195-00	. WASHER, valve seat	1		
4- 4	261-14141-28	. NOZZLE, main (N-8)	1		
4- 5	248-14145-01	. SETTER, needle jet	1		
4- 6	137-14153-00	. WASHER, main jet	1		
4- 7	93210-04121	. O-RING (1.78-4.47)	1		
4- 8	137-14143-36	. JET, main (#180)	} U. R 1		STD
	137-14143-38	. JET, main (#190)			
	137-14143-40	. JET, main (#200)			
4- 9	248-14198-70	. GASKET www.legends-yamaha-riders.com	1		
4-10	248-14166-00-33	. BOLT, banjo	1		
4-11	156-14185-00	. FOLAT	1		
4-12	137-14186-00	. PIN, float	1		
4-13	156-14184-00	. GASKET, float chamber	1		
4-14	248-14181-01-33	. BODY, float chamber	1		
4-15	204-14112-25	. VALVE, throttle (#2.5)	1		
4-16	152-14116-15	. NEEDLE (4F15-3)	1		
4-17	164-14137-00	. CLIP	1		
4-18	246-14132-00	. STOPPER, cable	1		
4-19	248-14131-00	. SPRING, throttle valve	1		
4-20	246-14126-00	. PACKING	1		
4-21	802-14158-00-33	. TOP, mixing chamber	1		

Fig. 4 CARBURETOR

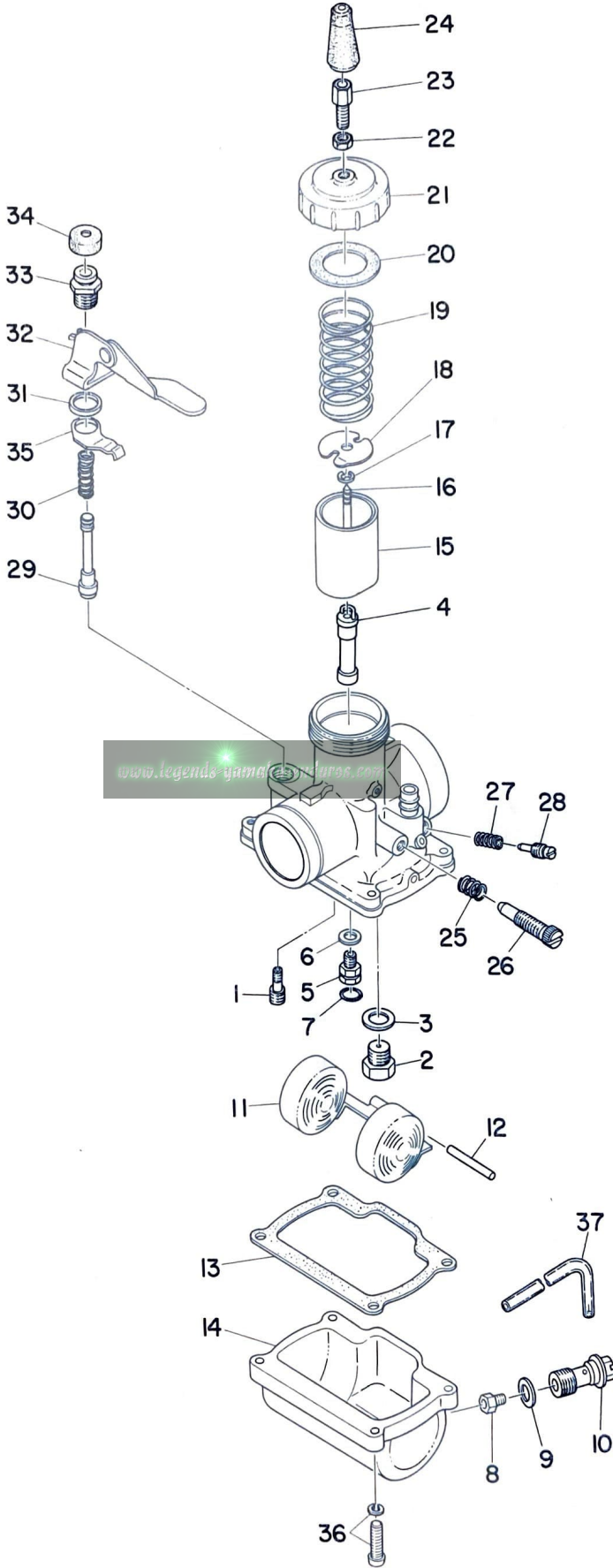

CARBURETOR

Ref. No.	Parts No.	Description	Q'ty	Applicable Machine No.	Remarks
4-22	802-14161-00	. NUT, wire adjusting	1		
4-23	127-14124-20	. SCREW, wire adjusting	1		
4-24	802-14169-00	. CAP	1		
4-25	137-14133-00-33	. SPRING, throttle stop	1		
4-26	204-14122-00-33	. SCREW, throttle stop	1		
4-27	127-14134-00	. SPRING, air adjusting	1		
4-28	152-14123-00-33	. SCREW, air adjusting	1		
4-29	132-14171-00	. PLUNGER, starter	1		
4-30	156-14135-00	. SPRING, plunger	1		
4-31	132-14179-00	. WASHER, starter lever	1		
4-32	214-14175-00-33	. LEVER, starter	1		
4-33	132-14174-00-33	. CAP, plunger	1		
4-34	132-14173-00	. COVER, plunger cap	1		
4-35	170-14178-00-33	. PLATE, starter lever	1		
4-36	308-14567-00	. SCREW, pan head	4		
4-37	183-14196-00	. PIPE, over flow (3-160)	1		

Fig. 5 FLYWHEEL MAGNETO

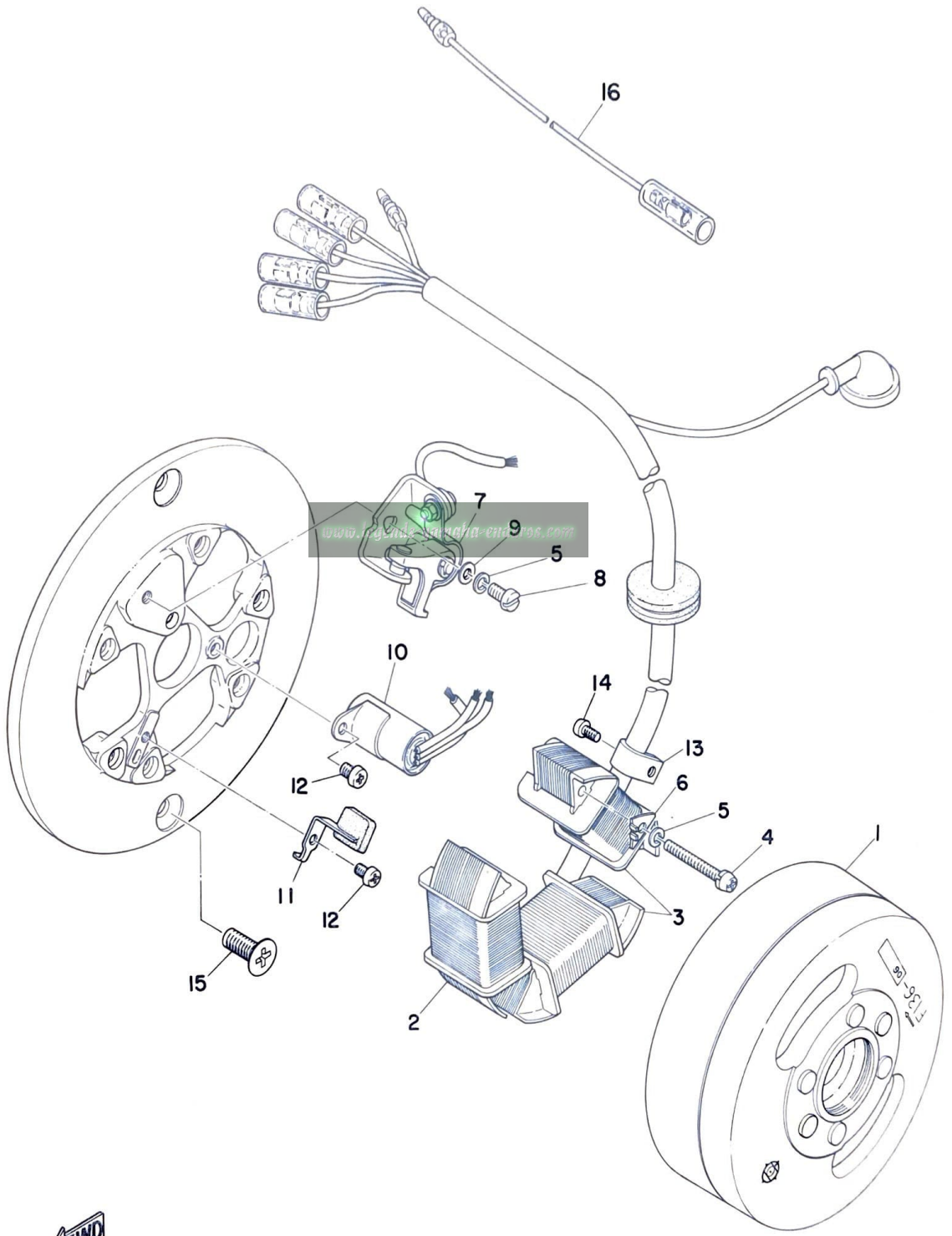

FLYWHEEL MAGNETO

Ref. No.	Parts No.	Description	Q'ty	Applicable Machine No.	Remarks
5- 0-1	314-81300-10	FLYWHEEL MAGNETO ASS'Y	1		
5- 1	314-81350-10	. ROTOR ASS'Y	1		
5- 2	277-81312-10	. COIL, source	1		
5- 3	314-81313-10	. LIGHTING COIL ASS'Y	1		
5- 4	110-81348-20	. SCREW, pan head (4-25)	6		
5- 5	92901-04100	. WASHER, spring	7		
5- 6	277-81332-10	. PLATE, timing	1		
5- 7	207-81321-10	. CONTACT BREAKER ASS'Y	1		
5- 8	110-81347-20	. SCREW, pan head (4-12)	1		
5- 9	92901-04200	. WASHER, plain	1		
5-10	277-81326-10	. CONDENSER	1		
www.legends-yamaha-enduros.com					
5-11	207-81331-10	. LUBRICATOR	1		
5-12	110-81345-20	. SCREW, pan head (4-6)	2		
5-13	109-81328-10	. CLAMP, lead	1		
5-14	110-81345-20	. SCREW, pan head (4-6)	1		
5-15	98701-06012	SCREW, flat head	2		
5-16	263-82319-00	WIRE, sub lead	1		

Fig. 6 FRAME · REAR FENDER · SEAT

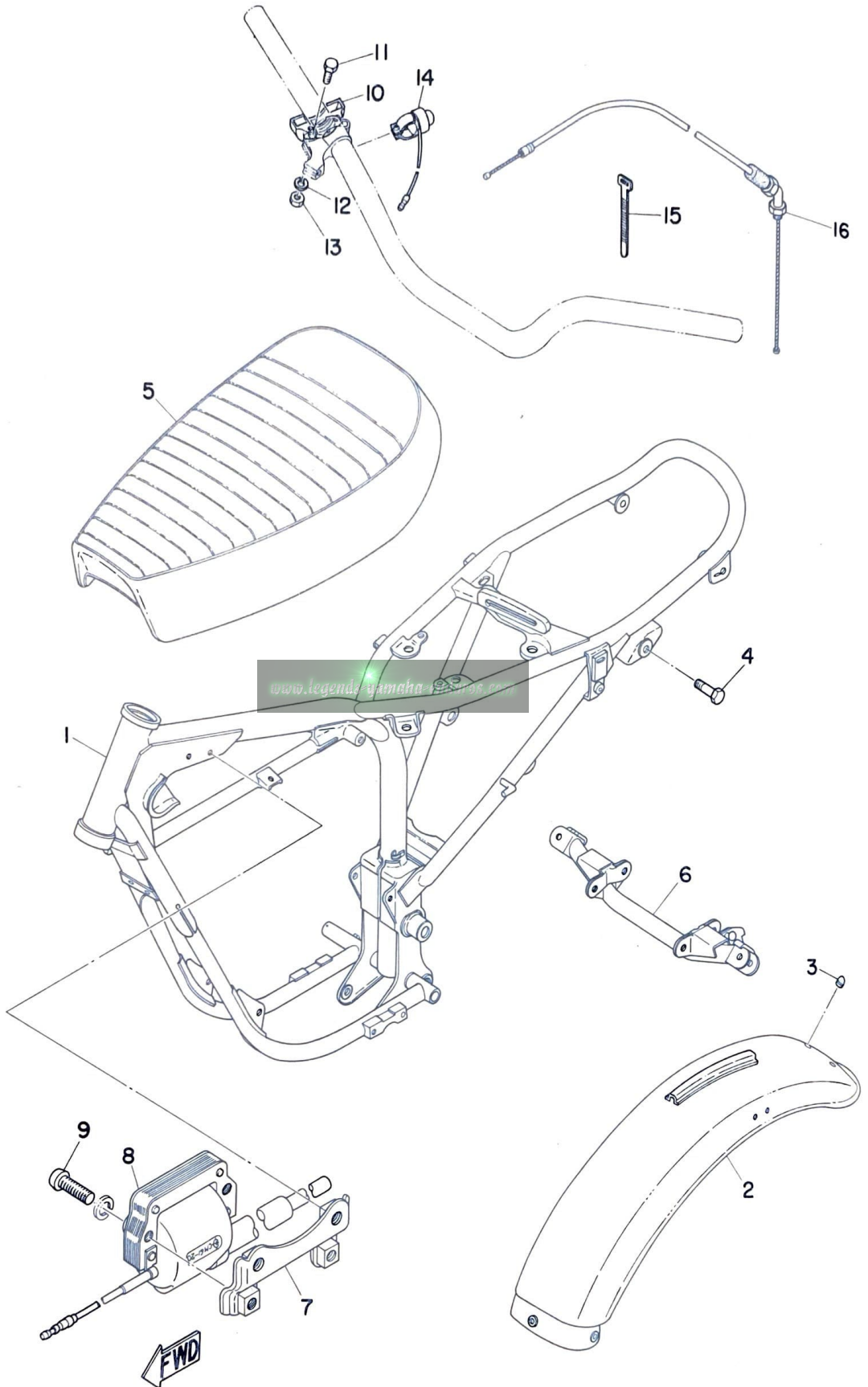

FRAME · REAR FENDER · SEAT

Ref. No.	Parts No.	Description	Q'ty	Applicable Machine No.	Remarks
6- 1	318-21110-00-33	FRAME COMP.	1		
6- 2	248-21610-00-35	REAR FENDER COMP.	1		
6- 3	170-21746-00	DAMPER, cleaner stop	2		
6- 4	214-22241-00	BOLT, rear cushion	2		
6- 5	318-24770-00	SEMI DOUBLE SEAT ASS'Y	1		
6- 5-1	318-24771-00	COVER, semi double seat	1		
6- 6	248-27411-00	FOOTREST	1		
6- 7	315-82316-00	BRACKET, ignition coil	1		
6- 8	304-82310-30	IGNITION COIL ASS'Y	1		
6- 9	92501-06025	SCREW, pan head	2		
6-10	214-26282-01	CAP, grip under	1		
www.legends-yamaha-enduros.com					
6-11	91203-06020	BOLT	1		
6-12	92901-06100	WASHER, spring	1		
6-13	98801-06300	NUT	1		
6-14	322-83976-00	SWITCH, handle 1	1		
6-15	803-82591-00	BAND	1		
6-16	318-26321-00	WIRE, pump	1		

Fig. 7 FRONT FORK - FRONT FENDER

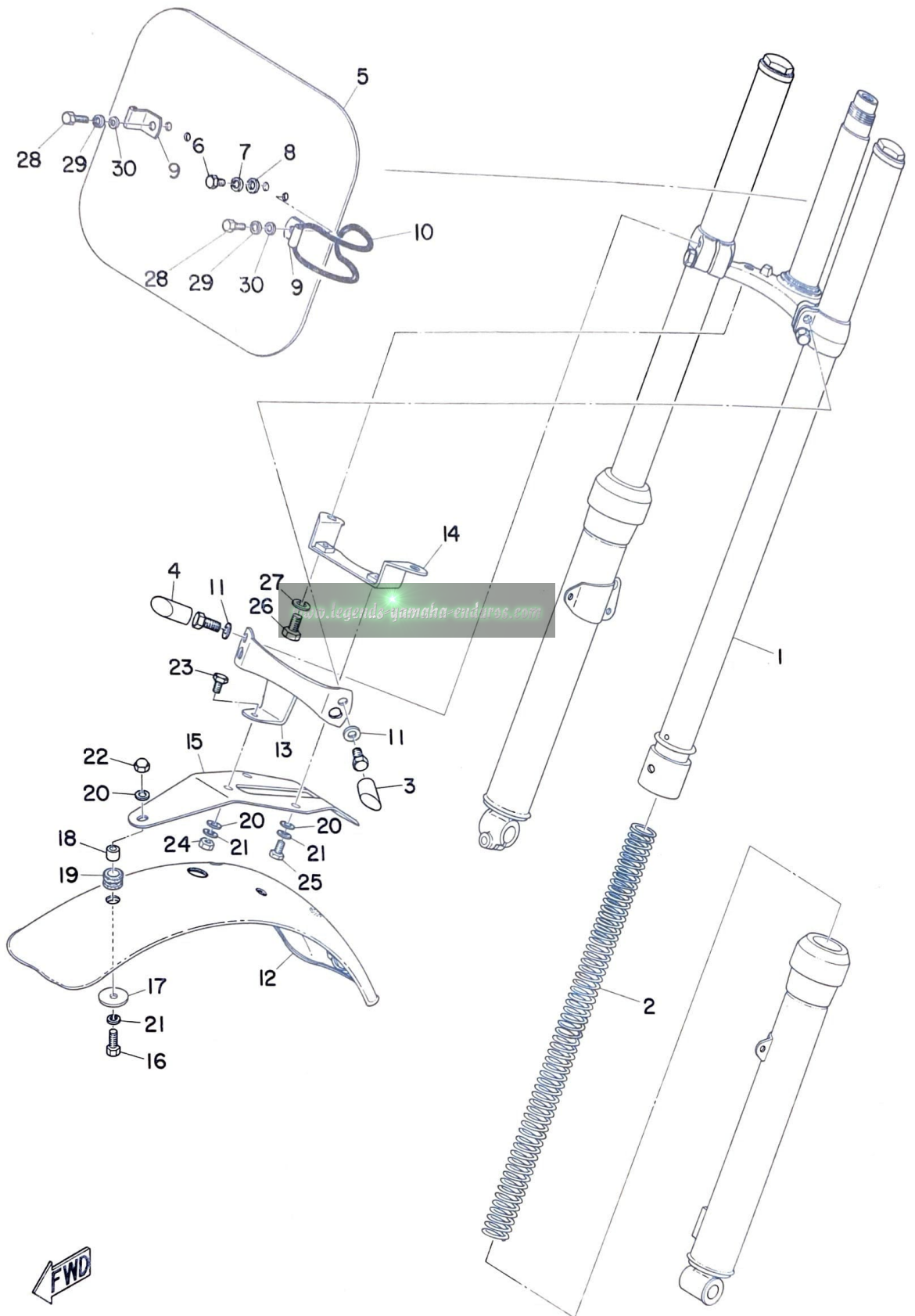

FRONT FORK · FRONT FENDER

Ref. No.	Parts No.	Description	Q'ty	Applicable Machine No.	Remarks
7- 1	318-23100-00	FRONT FORK ASS'Y	1		
7- 2	318-23141-00	. SPRING, fork	2		
7- 3	263-21581-00	. STAY, plate fitting left	1		
7- 4	263-21591-00	. STAY, plate fitting right	1		
7- 5	263-23485-00	PLATE, number	1		
7- 6	91201-06015	BOLT	2		
7- 7	92901-06100	WASHER, spring	2		
7- 8	156-24187-00	WASHER, special (6.5-26-166) ...	2		
7- 9	318-23487-00	STAY, plate	2		
7-10	93210-99103	O-RING (3.1-99.4)	1		
7-11	92901-08200	WASHER, plain	2		
7-12	284-21510-00-35	FRONT FENDER COMP.	1		
7-13	284-21513-00-35	STAY, fender 1	1		
7-14	284-21514-00-35	STAY, fender 2	1		
7-15	284-21512-00-35	BRACKET, fender	1		
7-16	91201-06018	BOLT	2		
7-17	116-28324-00	WASHER, leg shield (6.5-20-1.6) .	2		
7-18	256-21544-00	COLLAR, fender mount	2		
7-19	256-21541-00	DAMPER, fender mount	2		
7-20	92901-06200	WASHER, plain	5		
7-21	92901-06100	WASHER, spring	5		
7-22	98802-06700	NUT, crown	2		
7-23	91201-06012	BOLT	1		
7-24	98801-06100	NUT	1		

Fig. 7 FRONT FORK · FRONT FENDER

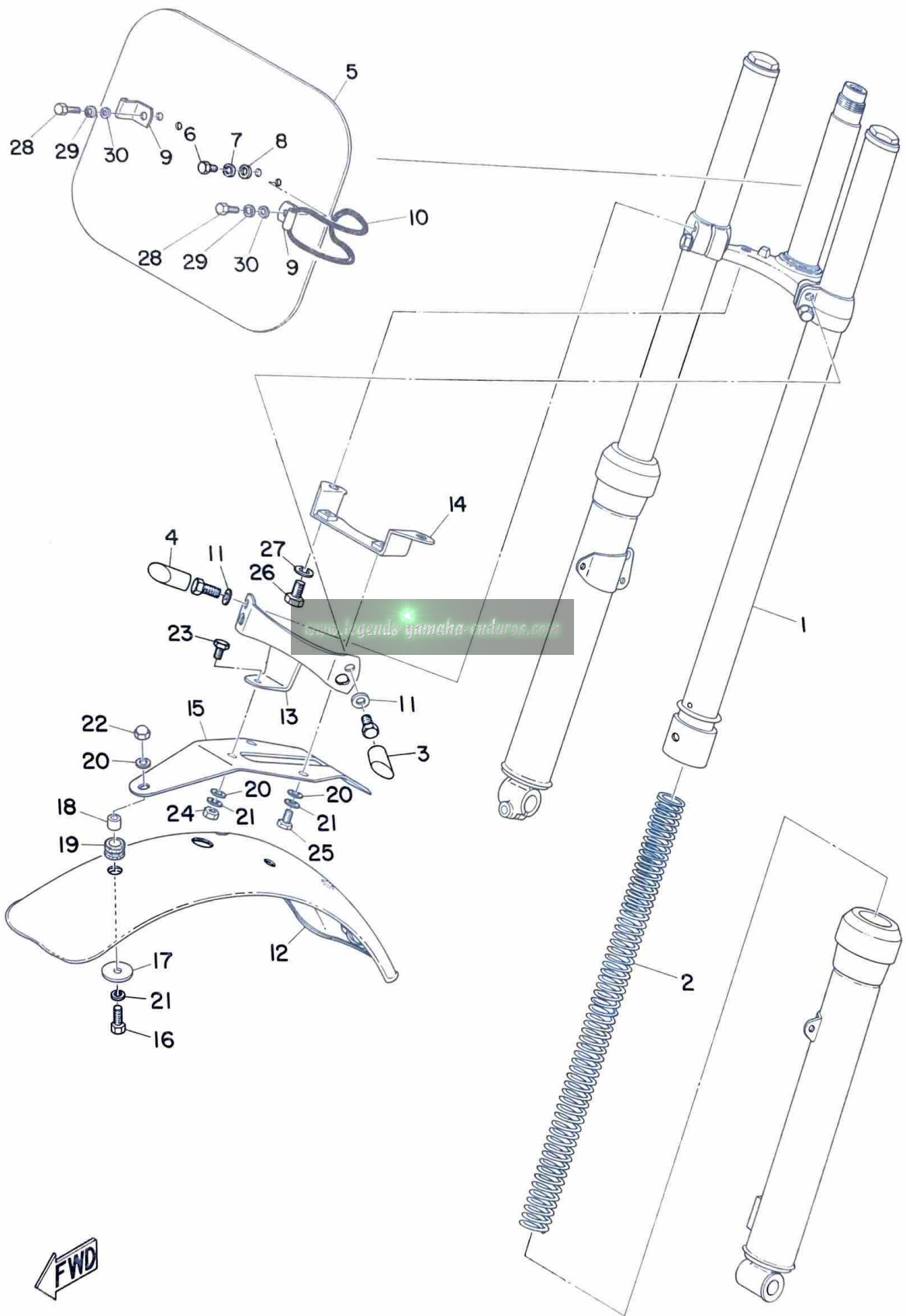

FWD

FRONT FORK · FRONT FENDER

Ref. No.	Parts No.	Description	Q'ty	Applicable Machine No.	Remarks
7-25	91201-06012	BOLT	2		
7-26	97201-08015	BOLT	2		
7-27	92901-08100	WASHER, spring	2		
7-28	91201-06018	BOLT	2		
7-29	92901-06100	WASHER, spring	2		
7-30	92901-06200	WASHER, plane	2		

www.legends-yamaha-enduros.com

Fig. 8 FRONT, REAR WHEEL

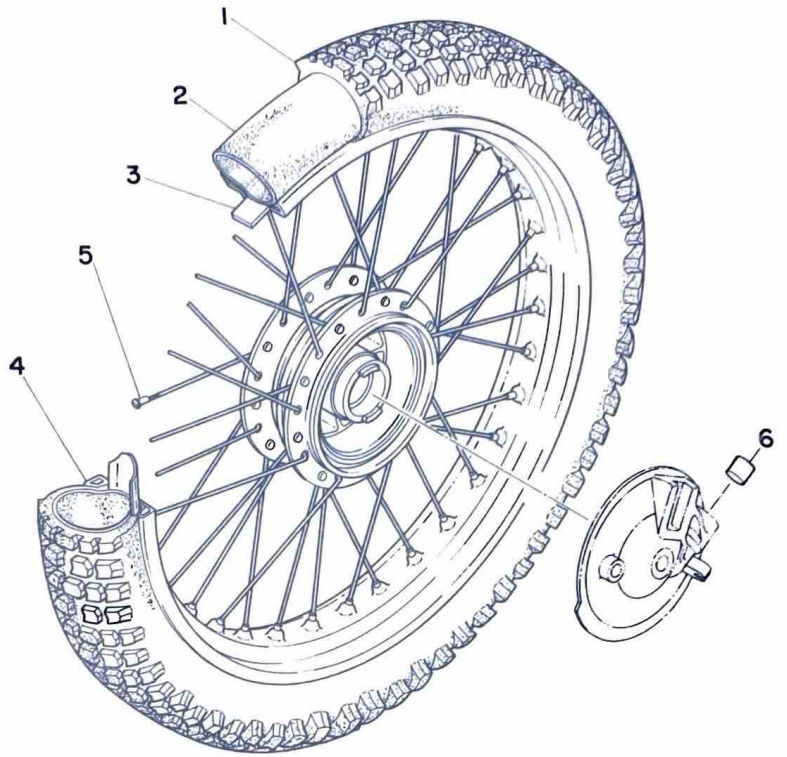

www.legends-yamaha-enduros.com

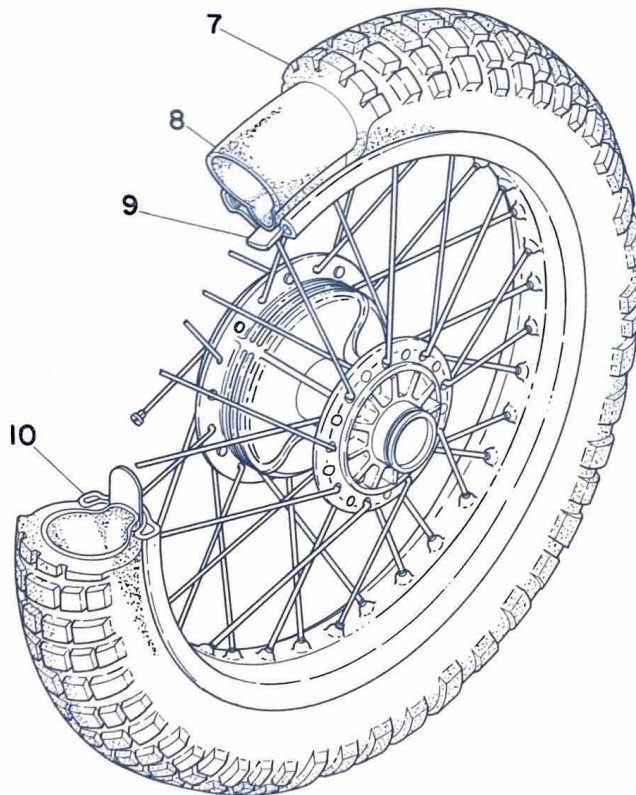

FRONT, REAR WHEEL

Ref. No.	Parts No.	Description	Q'ty	Applicable Machine No.	Remarks
8- 1	94127-21071	TIRE (2.75-21-4PR)	1		Knobby pattern
8- 2	94227-21031	TUBE (2.75-21)	1		
8- 3	94327-21024	BAND, rim (2.75-21)	1		
8- 4	94416-21044	RIM (1.60A-21)	1		
8- 5	248-25104-10	SPOKE SET	1s		
8- 6	152-25139-00	PLUG, blind	1		
8- 7	94135-18094	TIRE (3.50-18-4PR)	1		Knobby pattern
8- 8	94235-18022	TUBE (3.50-18)	1		
8- 9	94335-18018	BAND, rim (3.50-18)	1		
8-10	94418-18045	RIM (1.80-18)	1		

www.legends-yamaha-enduros.com

NUMERICAL INDEX

Ref No.	Parts No.	Ref No.	Parts No.	Ref No.	Parts No.
5-13	109-81328-10	1- 6	214-11557-01	7-12	284-21510-00-35
5-12	110-81345-20	4-32	214-14175-00-33	7-15	284-21512-00-35
5-14	110-81345-20	4- 3	214-14195-00	7-13	284-21513-00-35
5- 8	110-81347-20	3-11	214-21633-00	7-14	284-21514-00-35
5- 4	110-81348-20	6- 4	214-22241-00	3-13	285-14455-00
7-17	116-28324-00	6-10	214-26282-01	1-14	288-18588-00
4-23	127-14124-20	4-20	246-14126-00	3-14	304-14455-70
4-27	127-14134-00	4-18	246-14132-00	6- 8	304-82310-30
4-29	132-14171-00	1- 4	248-11611-70	4-36	308-14567-00
4-34	132-14173-00	1- 4	248-11611-80	1- 0-1	314-11410-00
4-33	132-14174-00-33	1- 4	248-11611-90	1- 5	314-11412-00
4-31	132-14179-00	4-19	248-14131-00	1- 9	314-15415-00
1-15	136-82543-00	4- 5	248-14145-01	5- 0-1	314-81300-10
4-25	137-14133-00-33	4-10	248-14166-00-33	5- 3	314-81313-10
4- 8	137-14143-36	4-14	248-14181-01-33	5- 1	314-81350-10
4- 8	137-14143-38	4- 9	248-14198-70	2- 5	315-17251-00
4- 8	137-14143-40	1-10	248-18111-00-93	6- 7	315-82316-00
4- 6	137-14153-00	6- 2	248-21610-00-35	1- 2	318-11111-00
4-12	137-14186-00	3-10	248-21717-00	1- 1	318-11311-00
4-16	152-14116-15	3- 9	248-21757-00	1- 3	318-11631-00-96
4-28	152-14123-00-33	8- 5	248-25104-10	1- 3	318-11631-00-97
8- 6	152-25139-00	6- 6	248-27411-00	1- 3	318-11631-00-98
4-30	156-14135-00	7-19	256-21541-00	1- 3	318-11635-00
4-13	156-14184-00	7-18	256-21544-00	1- 3	318-11636-00
4-11	156-14185-00	4- 4	261-14141-28	3-15	318-13565-00
7- 8	156-24187-00	7- 3	263-21581-00	4- 0-1	318-14101-00
4-17	164-14137-00	7- 4	263-21591-00	3- 1	318-14411-00
4- 2	168-14190-25	7- 5	263-23485-00	3- 2	318-14412-00
1-11	168-17481-00	5-16	263-83219-00	3- 3	318-14451-00
4-35	170-14178-00-33	2- 4	265-17121-01	3-12	318-14453-00
6- 3	170-21746-00	2- 2	265-17141-00	1-12	318-14610-00
4-37	183-14196-00	2- 3	265-17151-00	6- 1	318-21110-00-33
4- 1	193-14142-60	2- 7	265-17211-00	7- 1	318-23100-00
4-15	204-14112-25	2- 6	265-17241-00	7- 2	318-23141-00
4-26	204-14122-00-33	2- 1	265-17411-00	7- 9	318-23487-00
5- 7	207-81321-10	5- 2	277-81312-10	6- 5	318-24770-00
5-11	207-81331-10	5-10	277-81326-10	6- 5-1	318-24771-00
1- 8	214-11555-01	5- 6	277-81332-10	6-16	318-26321-00

NUMERICAL INDEX

Ref No.	Parts No.	Ref No.	Parts No.	Ref No.	Parts No.
6-14	322-83976-00	1-13	94701-00016		
4-21	802-14158-00-33	7-26	97201-08015		
4-22	802-14161-00	5-15	98701-06012,		
4-24	802-14169-00	7-24	98801-06100		
6-15	803-82591-00	6-13	98801-06300		
7-23	91201-06012	7-22	98802-06700		
7-25	91201-06012				
7- 6	91201-06015				
7-16	91201-06018				
7-28	91201-06018				
6-11	91203-06020				
3- 4	92501-06010				
3- 7	92501-06025				
6- 9	92501-06025				
5- 5	92901-04100				
5- 9	92901-04200				
3- 5	92901-06100				
3- 8	92901-06100				
6-12	92901-06100				
7- 7	92901-06100				
7-21	92901-06100				
7-29	92901-06100				
3- 6	92901-06200				
7-20	92901-06200				
7-30	92901-06200				
7-27	92901-08100				
7-11	92901-08200				
1- 7	92901-12100				
4- 7	93210-04121				
7-10	93210-99103				
8- 1	94127-21071				
8- 7	94135-18094				
8- 2	94227-21031				
8- 8	94235-18022				
8- 3	94327-21024				
8- 9	94335-18018				
8- 4	94416-21044				
8-10	94418-18045				

www.legends-yamaha-enduros.com

www.legends-yamaha-enduros.com



YAMAHA MOTOR CO., LTD.

PRINTED IN JAPAN

First edition July, 1971

(318-80)