

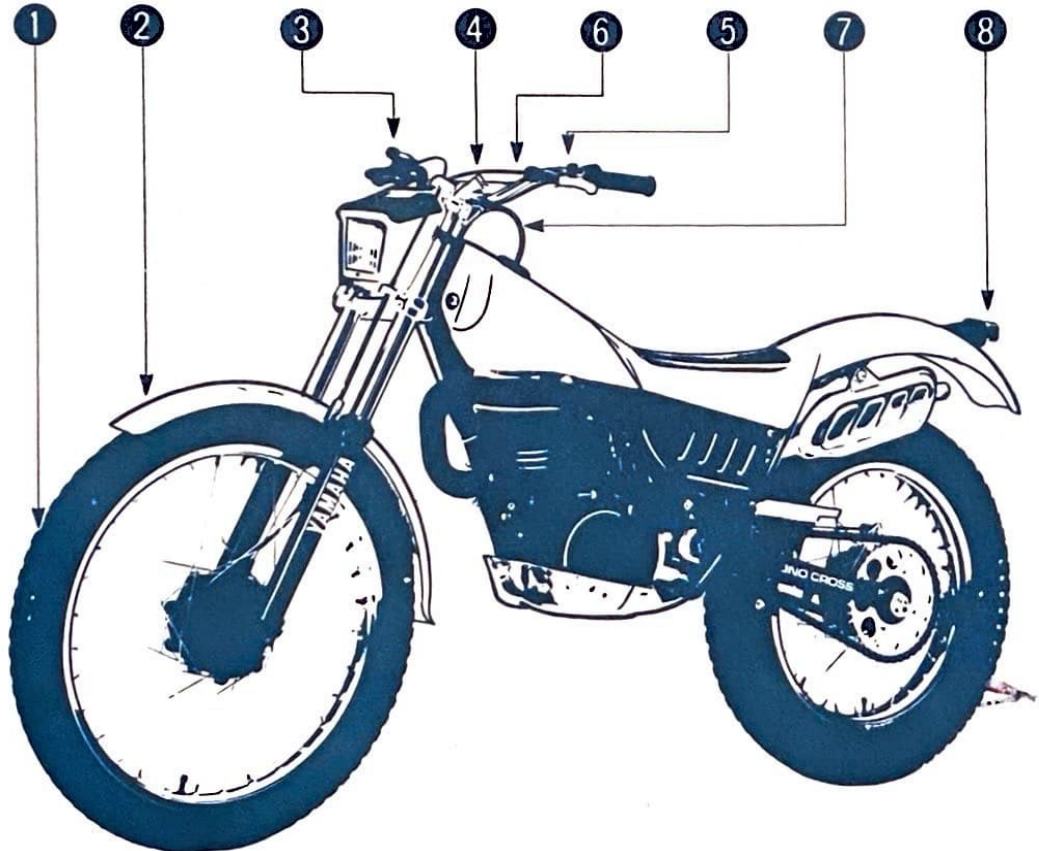

YAMAHA

www.legends-yamaha-enduros.com

TY350N SUPPLEMENTARY ASSEMBLY MANUAL



FOREWORD

This Supplementary assembly manual has been prepared to introduce the setup procedures and predelivery service for the TY350N. For complete information, it is necessary to use the YZ/IT series Basic assembly manual (LIT-11666-03-31) together with this Supplementary assembly manual.

NOTICE

The service specifications given in this Supplementary assembly manual are based on the model as manufactured. Modifications and significant changes in specifications and/or procedures will be forwarded to Authorized Yamaha Dealers. The procedures below are described in the order that the procedures are carried out correctly and completely. Failure to do so can result in poor performance and possible harm to the machine and/or rider.

CONCERNING CRATE DAMAGE:

Follow the instructions in the Dealer warranty handbook, Procedures section.

Particularly important information is distinguished in this manual by the following notations:

NOTE: A NOTE provides key information to make procedures easier or clearer.

CAUTION: A CAUTION indicates special procedures that must be followed to avoid damage to the machine.

WARNING: A WARNING indicates special procedures that must be followed to avoid injury to a machine operator or person inspecting or repairing the machine.

**OVERSEAS SERVICE
OVERSEAS OPERATIONS
YAMAHA MOTOR CO., LTD**

TY350N
SUPPLEMENTARY ASSEMBLY MANUAL
©1984 by Yamaha Motor Corporation, U.S.A.
1st edition, JULY 1984

All rights reserved. Any reprinting or
unauthorized use without the written permission
of Yamaha Motor Corporation, U.S.A., is
expressly prohibited.
Printed in U.S.A.
P/N LIT-11666-04-80

GLOSSARY

(Symbols most commonly used)

www.regulus-yamaha-enduros.com

- C: The "C" marked parts are contained in the carton box.
- S: The "S" marked parts are fixed inside the crate.
- V: The "V" marked parts are contained in the vinyl bag.
- *: The asterisk (*) parts are temporarily fitted on the machine.

SETUP PROCEDURES

NOTE:

Please read the following chapters in the Basic assembly manual before proceeding to the setup.

CHAPTER 1: INTRODUCTION

CHAPTER 2: SETUP AND PREDELIVERY CHECK

CHAPTER 3: TOOLS AND TORQUE SPECIFICATIONS

CHAPTER 4: CRATES

CHAPTER 5: INSTALLATION PROCEDURES

Parts list

No.	Part name	Q'ty	Locating mark	Remarks
1. Front wheel F.W-I				
1	Front wheel	1	S	
2	Front wheel axle	1	*	d = 14 mm (0.56 in)
3	Speedometer cable housing	1	S	
4	Brake shoe plate assembly	1	S	
5	Hexagon socket bolt	1	*	d = 8 mm (0.32 in)
2. Front fender F.F-F				
1	Front fender	1	S	
2	Front brake cable	1	*	
3	Speedometer assembly	1	S	
4	Special screw	1	V	d = 6 mm (0.24 in) ℓ = 20 mm (0.79 in)
5	Crossrecess screw	3	V	d = 6 mm (0.24 in) ℓ = 12 mm (0.47 in)
6	U nut	1	V	d = 6 mm (0.24 in)
3. Throttle grip T.G-B				
1	Throttle grip	1	*	
2	Panhead screw	2	*	d = 5 mm (0.20 in)
4. Handlebar H.B-C				
1	Handlebar	1	S	
2	Upper handlebar holder	4	V	d = 8 mm (0.32 in) ℓ = 30 mm (1.17 in)
3	Hexagon socket bolt	2	V	
4	Cap	2	V	Plastic

No.	Part name	Q'ty	Locating mark	Remarks
5. Engine stop switch E.S-C				
1	Engine stop switch	1	*	
2	Panhead screw	1	V	d = 3 mm (0.12 in) ℓ = 14 mm (0.55 in)
3	Spring washer	1	V	d = 3 mm (0.12 in)
4	Engine stop switch holder (Upper and lower)	2	V	
5	Handlebar band	2	V	Plastic
6. Brack and clutch cable B.C-A				
7. Fuel tank breather pipe F.B-G				
1	Fuel tank breather pipe	1	C	Rubber
8. Taillight assembly T.L-A				
1	Taillight assembly	1	S	
2	Hexagon nut	2	V	d = 5 mm (0.20 in)

Detachable sidestand

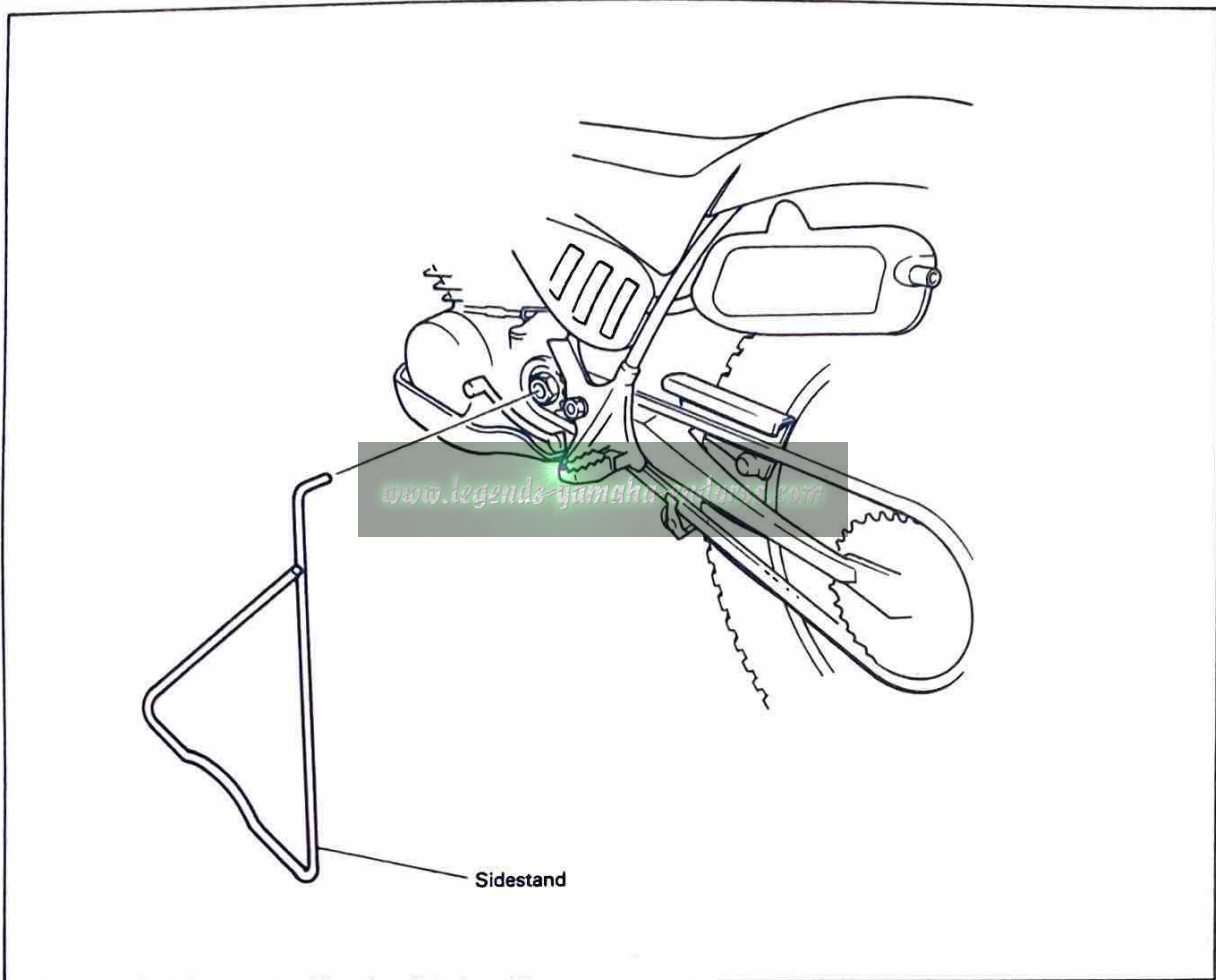

Detachable Sidestand

This sidestand is inserted into the drive sprocket shaft hole.

NOTE: _____

This sidestand is used to support only the machine when servicing or transporting it.

WARNING: _____

- Before starting the engine, shift into neutral.
- Remove this sidestand when racing the rear wheel or before starting out.

CABLE ROUTING

CAUTION:

Proper cable and lead routing is essential to insure safe vehicle operation.

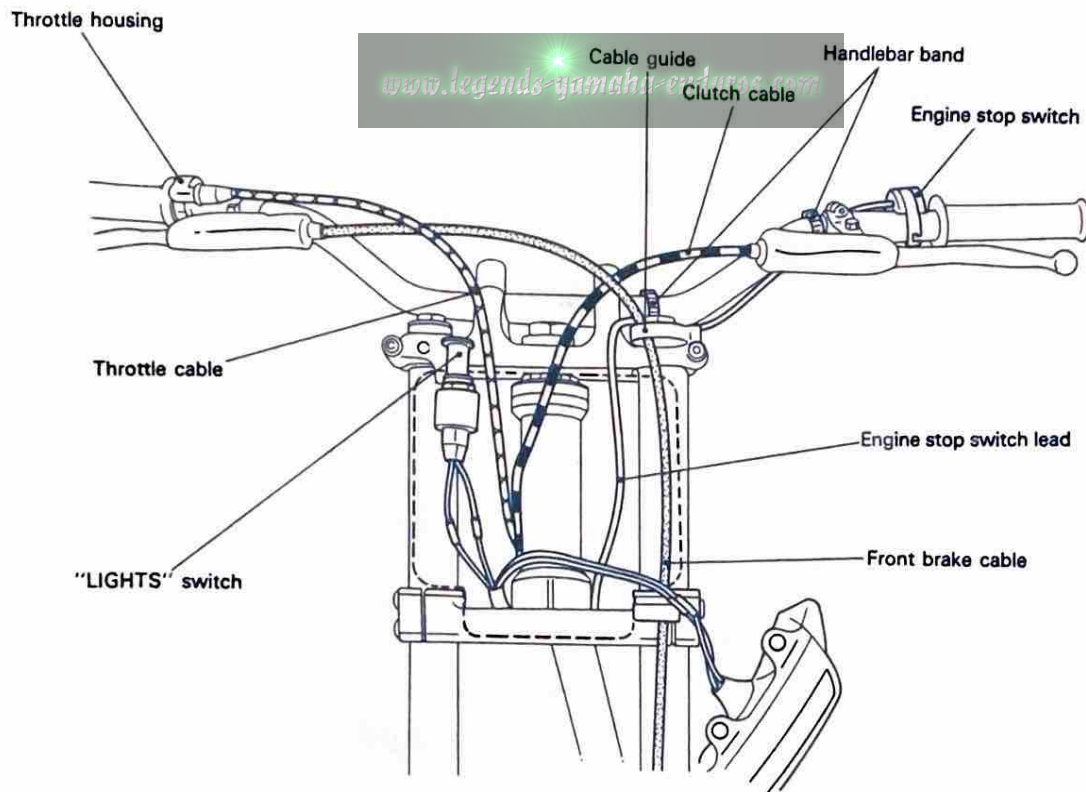

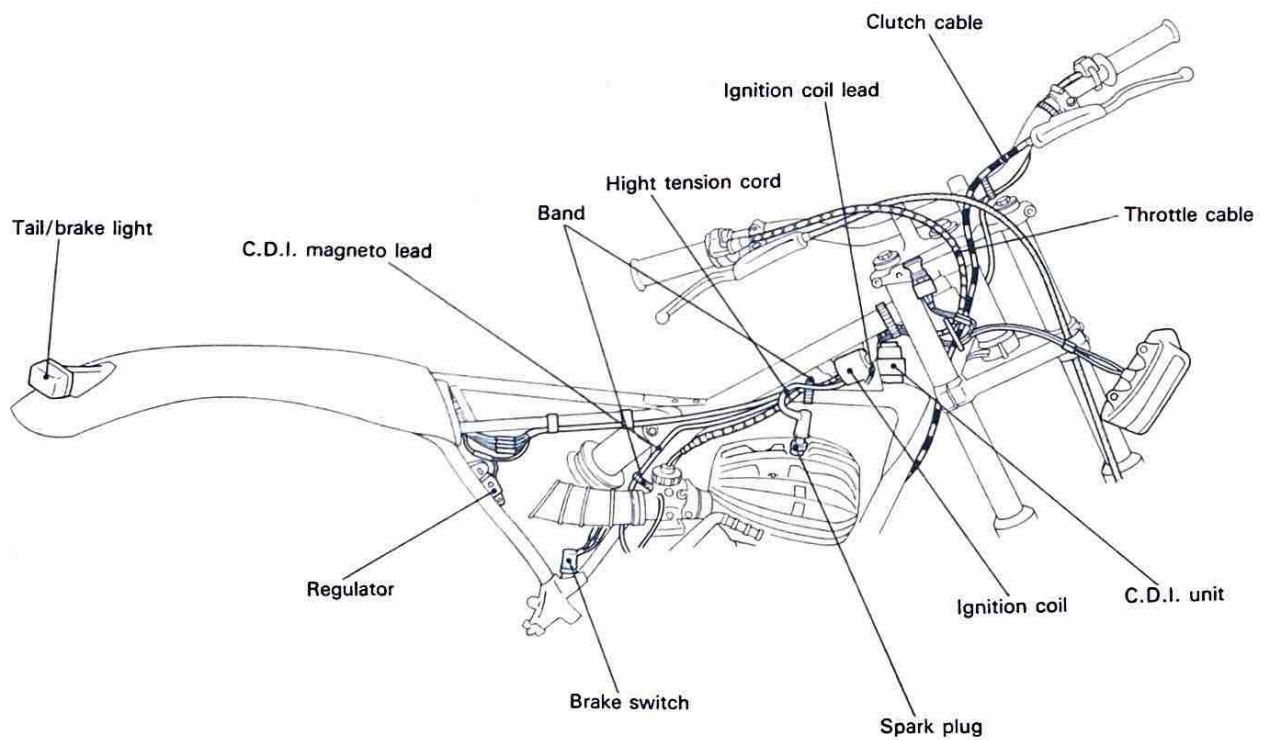
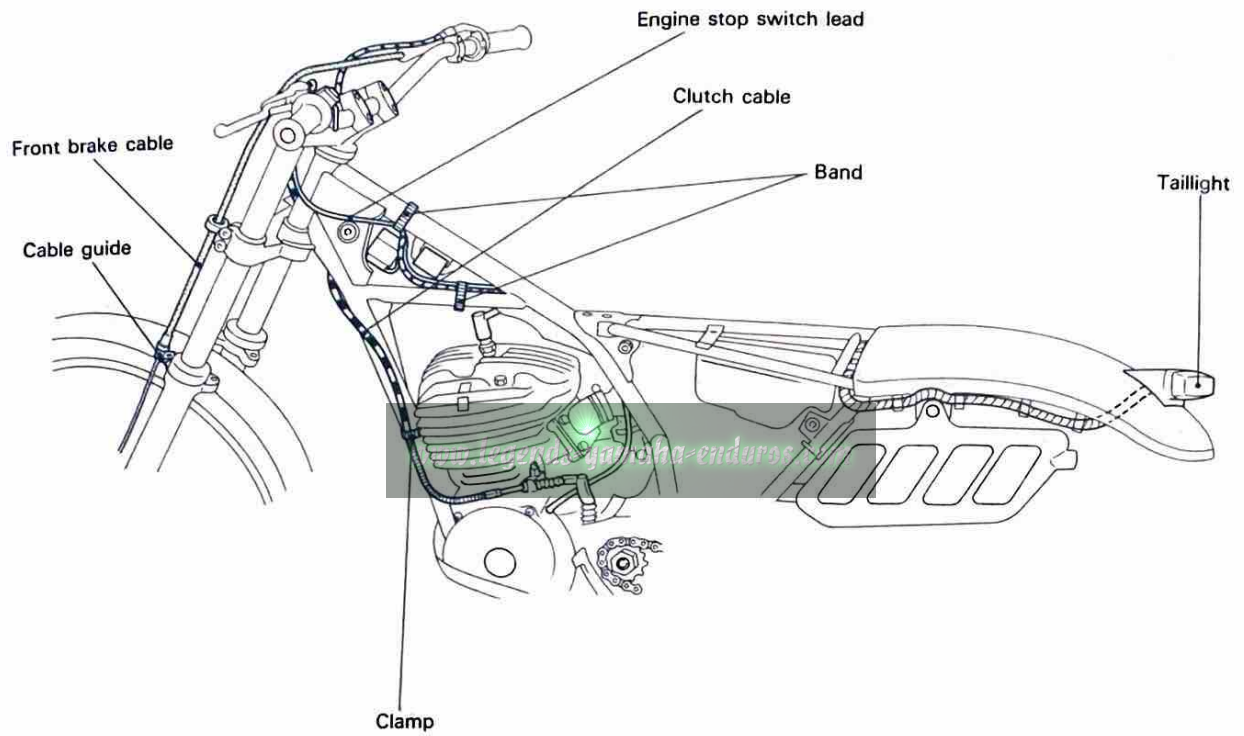

ADJUSTMENTS AND PREDELIVERY SERVICE

NOTE:

Please read the following chapter in the Basic assembly manual before proceeding to the adjustments and predelivery service.
CHAPTER 6: APPENDICES

1. Front brake adjustment

F.B-B

Front brake lever free play:
5~8 mm (0.2~0.3 in)

2. Rear brake pedal position adjustment

R.P-B

Brake pedal position:
Pedal top end is flush with the top of the Footrest.

3. Rear brake adjustment

R.B-B

Rear brake pedal free play:
10~15 mm (0.39~0.63 in)

4. Clutch adjustment

C.A-B

Clutch lever free play:
2~3 mm (0.08~0.12 in)

5. Throttle cable adjustment

T.C-B

Throttle cable free play:
3~5 mm (0.12~0.21 in)

6. Fuel draining

F.D-A

7. Transmission oil replacement

T.R-A

Recommended oil:

SAE 10W30 type SE motor oil

Oil capacity

Periodic oil change:

0.75 L (0.80 Imp qt, 0.66 US qt)

Total amount:

0.80 L (0.85 Imp qt, 0.70 US qt)

8. Drive chain slack check

D.C-C

Drive chain Slack:

20~30 mm (0.8~1.2 in)

APPENDICES

SERVICE DATA

Idling engine speed:	As desired	
Spark plug: Type Gap	BP6EV (N.G.K) 0.7 ~ 0.8 mm (0.027 ~ 0.031 in)	
Fuel: Recommended fuel Fuel tank capacity	Premium fuel with an octane rating of at least 90. 3.5 L (0.77 Imp gal, 0.93 US gal)	
Engine oil: Recommended oil	<p>Yamalube Racing 2-cycle oil, (Mixing ratio: 48 : 1)</p> <p>If for any reason you should use another type, select from the following list. (Mixing ratio: 50 : 1)</p> <ul style="list-style-type: none"> • Castrol R30 • Castrol A545 • Castrol A747 	
Tire pressure (Cold tire pressure):	Front	Rear
	39.2 kPa (0.4 kg/cm ² , 56 psi)	29.4 kPa (0.3 kg/cm ² , 42 psi)

Tightening torque

Parts name	Tightening torque		
	Nm	m•kg	ft•lb
Engine:			
Spark plug			
Transmission oil drain bolt	25	2.5	18
Chassis:			
Front wheel axle (F.W-I # 1)			
Handle crown and inner tube	58	5.8	42
Handle crown and steering shaft	23	2.3	17
Handle crown and handlebar holder (H.B-C # 1)	53	5.3	38
Steering fitting nut	23	2.3	17
Engine bracket and frame	10	1.0	7.2
Rear wheel axle	30	3.0	22
Sprocket wheel	85	8.5	61
Front fork and axle holder (F.W-I # 2)	30	3.0	22
Rear shock absorber and frame	20	2.0	14
Pivot shaft and frame	30	3.0	22
Brake cam lever	85	8.5	61
Relay arm and bracket relay	10	1.0	7.2
Relay arm and rear shock absorber	32	3.2	23
Relay arm and connecting rod	30	3.0	22
Swing arm and connecting rod	32	3.2	23
Bracket relay and frame	58	5.8	42
	30	3.0	22

OWNER'S TOOL KIT

No.	Part name	Q'ty
1	Owner's tool bag	1
2	Spanner (10-12)	1
3	Spanner (14-17)	1
4	Screwdriver grip	1
5	Screwdriver bit (Phillips head and slotted head)	1
6	Screwdriver bit (Phillips head)	1
7	Screwdriver grip cap	1
8	Pliers	1
9	Hexagon wrench (4)	1
10	Hexagon wrench (5)	1
11	Hexagon wrench (6)	1
12	Special spanner	1
13	Special spanner	1
14	Spoke nipple wrench	1
15	Air Gauge	1

www.legends-yamaha-enduros.com



YAMAHA MOTOR CO.,LTD.

IWATA, JAPAN

PRINTED IN U.S.A