

YAMAHA

PARTS LIST

MODEL DT125E'79

(MODEL CODE 1G0)

FOR EUROPE

COPY RIGHT: ALL RIGHTS RESERVED
NO PART OF THIS PUBLICATION MAY BE REPRODUCED WITHOUT PERMISSION.

1G0-28198-E7



FOREWORD

This Parts List is related to the parts in use for the Yamaha DT125E'79. When you are ordering replacement parts for the DT125E'79, refer to this Parts List and quote both part numbers and part names correctly.

1. Modifications or additions which have been made after issue of the Parts List will be announced in the Yamaha Parts News.
It is advisable that according to the Yamaha Parts News you make necessary corrections to the Parts List on hand to keep it up-to-date.

2. Abbreviations

The following abbreviations are used in this Parts List.

- U.R. Use size (thickness) and/or number as required.
U.N. Use as many as you need.
F# Frame No. (Applicable machine No.)

3. Parts, which are to be supplied in the form of assemblies, are listed with an indentation of one letter's space, and a dot (.) is put against the name of each part.

EXAMPLE CARBURETOR ASS'Y
. JET, pilot
. NOZZLE, main

4. Initial Serial No. and Color Code

(A) Frame Serial No.	1G0-120101 and following
(B) Engine Serial No.	1G0-120101 and following

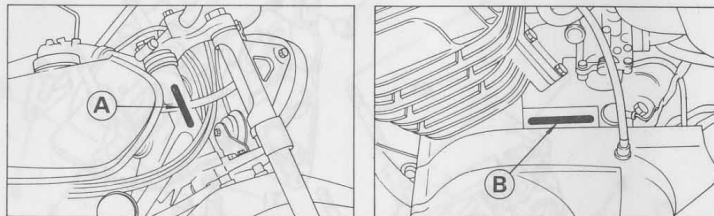

Color Code	Color Name
33	Yamaha Black
91	Uni-Chrome Plated
93	Chrome Plated
98	Low Gloss Black
R4	Heat Proof Black
G3	French Blue

CONTENTS

Part No.	Part Name	Page
ENGINE		
Fig. 1	Crankcase - Cylinder	1
Fig. 2	Crankcase Cover	2
Fig. 3	Crank - Piston	3
Fig. 4	Clutch	4
Fig. 5	Transmission	5
Fig. 6	Shifts 1	6
Fig. 7	Shifts 2	7
Fig. 8	Kick Starter	8
Fig. 9	Reductor Gear	9
Fig. 10	Idler	10
Fig. 11	Carductor	11
Fig. 12	Exhaust	12
Fig. 13	Oil Pump	13
Fig. 14	Starter Generator	14
CHASSIS		
Fig. 15	Frame	15
Fig. 16	Rear Arm - Rear Control - Chain Case	16
Fig. 17	Stand - Footrest - Handguard	17
Fig. 18	Front Forker - Seat Swivel	18
Fig. 19	Front Fork	19
Fig. 20	Swingarm	20
Fig. 21	Handle - Wire	21
Fig. 22	Fuel Tank	22
Fig. 23	Oil Tank	23
Fig. 24	Seat	24
Fig. 25	Front Wheel	25
Fig. 26	Rear Wheel	26

CONTENTS

ENGINE

Fig. 1	Crankcase · Cylinder	1
Fig. 2	Crankcase Cover	2
Fig. 3	Crank · Piston	3
Fig. 4	Clutch	5
Fig. 5	Transmission	6
Fig. 6	Shifter 1	8
Fig. 7	Shifter 2	9
Fig. 8	Kick Starter	10
Fig. 9	Tachometer Gear	11
Fig. 10	Intake	12
Fig. 11	Carburetor	13
Fig. 12	Exhaust	15
Fig. 13	Oil Pump	16
Fig. 14	Starter Generator	17

CHASSIS

Fig. 15	Frame	18
Fig. 16	Rear Arm · Rear Cushion · Chain Case	20
Fig. 17	Stand · Footrest · Brake Pedal	22
Fig. 18	Front Fender · Rear Fender	24
Fig. 19	Front Fork	26
Fig. 20	Steering	28
Fig. 21	Handle · Wire	29
Fig. 22	Fuel Tank	31
Fig. 23	Oil Tank	33
Fig. 24	Seat	34
Fig. 25	Front Wheel	35
Fig. 26	Rear Wheel	37

Fig. 27	Head Lamp 1	39
Fig. 28	Head Lamp 2 (England)	40
Fig. 29	Speedometer · Tachometer	41
Fig. 30	Tail Lamp 1	42
Fig. 31	Tail Lamp 2 (England)	44
Fig. 32	Flasher Lamp 1	45
Fig. 33	Flasher Lamp 2	46
Fig. 34	Electrical	47

REPAIR KIT

Fig. 35	Repair Kit	50
---------	------------------	----

NUMERICAL INDEX

davestestsandarticles.weebly.com

Fig. 1 CRANKCASE · CYLINDER

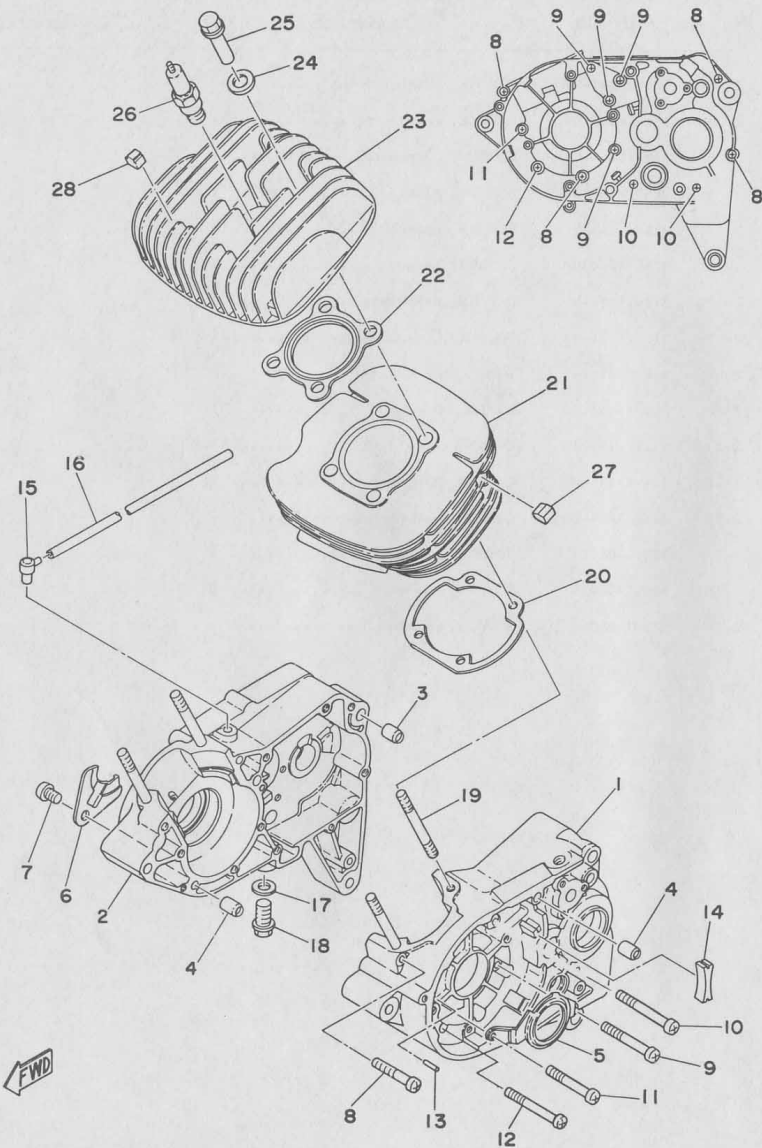

Ref. No.	Part No.	Description	Q'ty	Applicable Machine No.	Remarks
1- 1	248-15111-03	CASE, crank left	1		
1- 2	444-15121-02	CASE, crank right	1		
1- 3	91810-16016	PIN, dowel (10.5-14-16)	1		
1- 4	91830-21014	PIN, dowel (6.4-10-14)	3		
1- 5	444-15118-00	HOLDER, left	1		
1- 6	304-15128-00	HOLDER, right	1		
1- 7	92501-08012	SCREW, panhead	1		
1- 8	92501-06045	SCREW, panhead	4		
1- 9	92501-06055	SCREW, panhead	4		
1-10	92501-06065	SCREW, panhead	2		
1-11	92501-06050	SCREW, panhead	1		
1-12	92501-06060	SCREW, panhead	1		
1-13	93603-14026	PIN, dowel (3-14)	1		
1-14	248-15357-00	GROMMET	1		
1-15	498-15371-00	BREATHER	1		
1-16	90445-07176	HOSE (395-24317-00 4.2-200)	1		
1-17	90430-12038	GASKET (132-15353-00)	1		
1-18	90340-12005	PLUG, drain (132-15351-00)	1		
1-19	90116-08064	BOLT, stud (248-11361-00)	4		
1-20	248-11351-00	GASKET, cylinder	1		
1-21	560-11311-00	CYLINDER	1		
1-22	248-11181-00	GASKET, cylinder head	1		
1-23	560-11111-00	HEAD, cylinder	1		
1-24	90201-12362	WASHER, plate (278-11175-00)	4		
1-25	90179-08025	NUT (248-11171-01)	4		
1-26	94701-00045	PLUG, spark (B-8ES)	1		
1-27	577-11161-00	ABSORBER	15		
1-28	434-11161-00	ABSORBER	20		

Fig. 2 CRANKCASE COVER

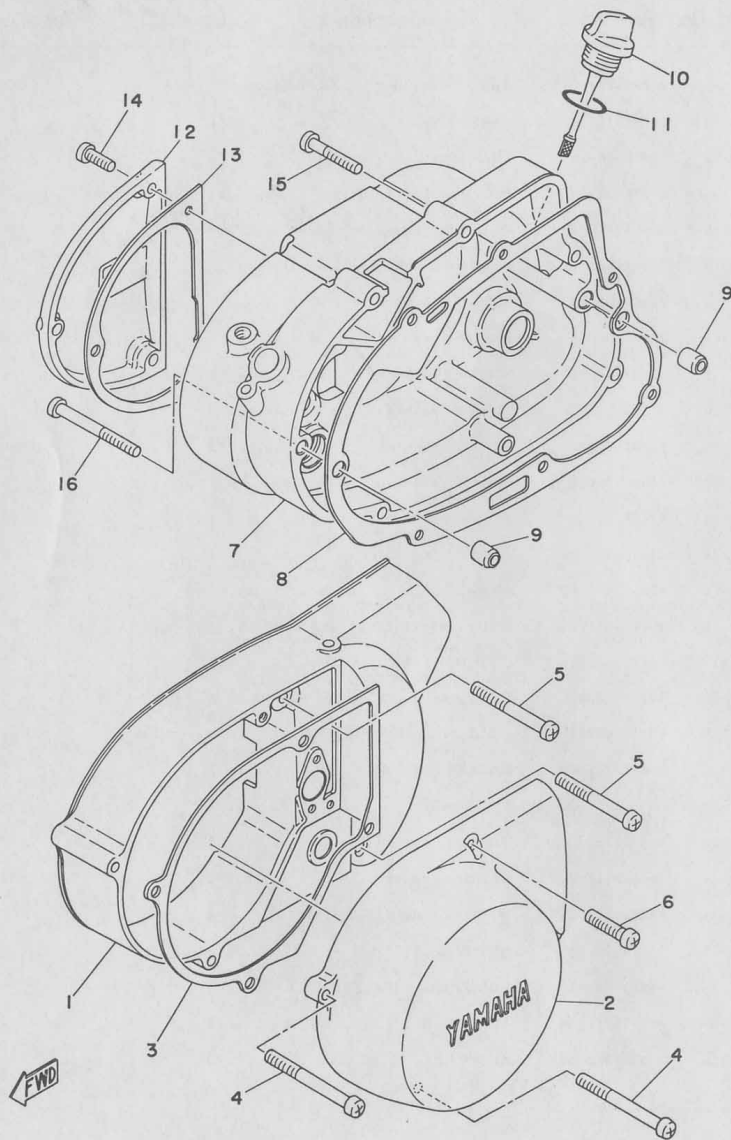

Ref. No.	Part No.	Description	Q'ty	Applicable Machine No.	Remarks
2- 1	314-15411-01	COVER, crankcase left	1		
2- 2	316-15415-00	COVER, generator	1		
2- 3	314-15455-00	GASKET, generator cover	1		
2- 4	92501-06065	SCREW, panhead	2		
2- 5	92501-06055	SCREW, panhead	2		
2- 6	92501-06030	SCREW, panhead	2		
2- 7	314-15421-00	COVER, crankcase right	1		
2- 8	315-15451-02	GASKET, crankcase cover	1		
2- 9	91830-21014	PIN, dowel (6.4-10-14)	2		
2-10	560-15362-00	PLUG, oil level	1		
2-11	93210-19123	O-RING (2.4-19.0)	1		
2-12	314-15416-00	COVER, oil pump	1		
2-13	444-15456-00	GASKET, oil pump cover	1		
2-14	92501-06020	SCREW, panhead	3		
2-15	92501-06035	SCREW, panhead	6		
2-16	92501-06060	SCREW, panhead	1		

Fig. 3 CRANK · PISTON

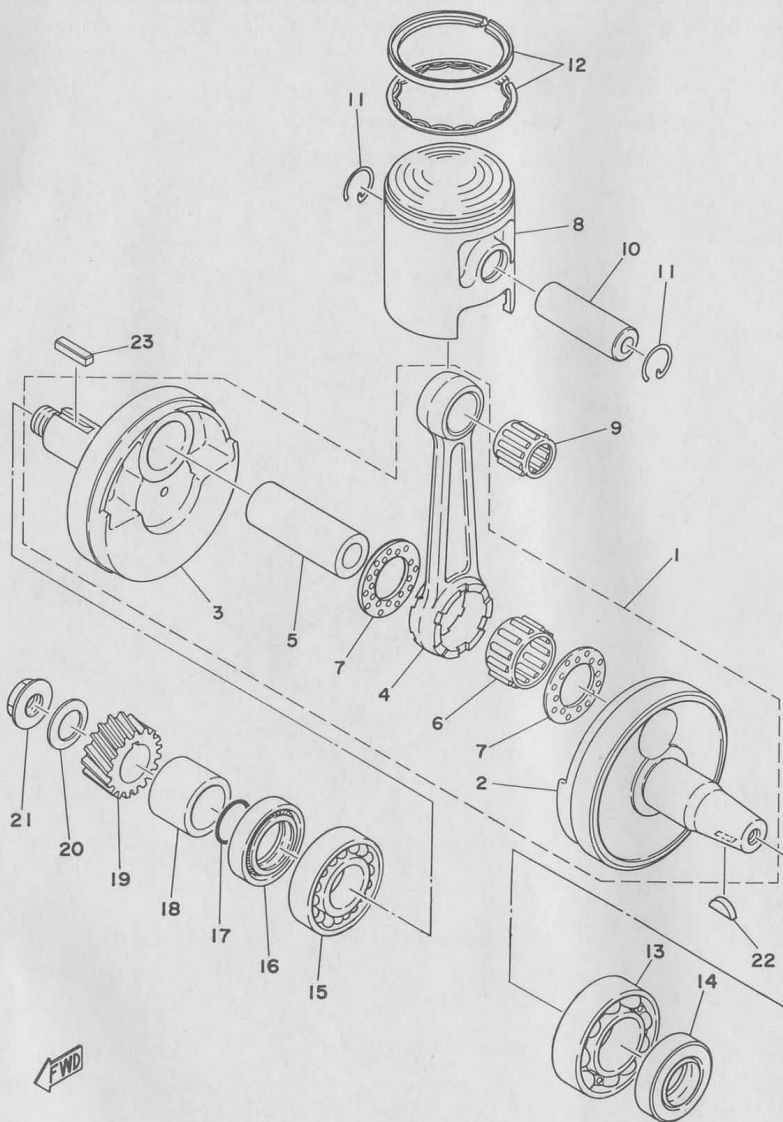

Ref. No.	Part No.	Description	Q'ty	Applicable Machine No.	Remarks
3- 1	560-11400-01	CRANK ASS'Y	1		
3- 2	560-11412-00	. CRANK, left	1		
3- 3	525-11422-00	. CRANK, right	1		
3- 4	559-11651-00	. ROD, connecting	1		
3- 5	248-11681-01	. PIN, crank	1		
3- 6	93310-42231	. BEARING, con-rod big end	1		
3- 7	90209-22071	. WASHER (164-11685-00) (22.2-37-1.0)	2		
3- 8	560-11631-00-96	PISTON (55.96mm STD)	} U.R 1		
	560-11631-00-98	PISTON (55.98mm STD)			
	560-11635-00	PISTON (56.25mm 1st O.S)			Alternate Parts
	560-11636-00	PISTON (56.50mm 2nd O.S)			Alternate Parts
	560-11637-00	PISTON (56.75mm 3rd O.S)			Alternate Parts
	560-11638-00	PISTON (57.00mm 4th O.S)		Alternate Parts	
3- 9	93310-216A3	BEARING, con-rod small end	1		
3-10	137-11633-00	PIN, piston	1		
3-11	93450-17025	CLIP, piston pin (137-11634-00)	2		
3-12	444-11610-00	PISTON RING SET (STD)	1s		
	444-11610-10	PISTON RING SET (1st O.S)	1s		Alternate Parts
	444-11610-20	PISTON RING SET (2nd O.S)	1s		Alternate Parts
	444-11610-30	PISTON RING SET (3rd O.S)	1s		Alternate Parts
	444-11610-40	PISTON RING SET (4th O.S)	1s		Alternate Parts
3-13	93306-20517	BEARING, crank (B6205C4)	1		
3-14	93102-25061	OIL SEAL (SD-25-40-8)	1		
3-15	93306-30405	BEARING, crank (B6304 C3)	1		
3-16	93103-28011	OIL SEAL (SW-28-40-8)	1		
3-17	93210-18023	O-RING (1.2-17.6)	1		
3-18	90387-20488	COLLAR (20-28-18.5)	1		
3-19	525-16111-00	GEAR, primary drive (19T)	1		
3-20	90208-12015	WASHER (164-16119-00)	1		

Fig. 3 CRANK · PISTON

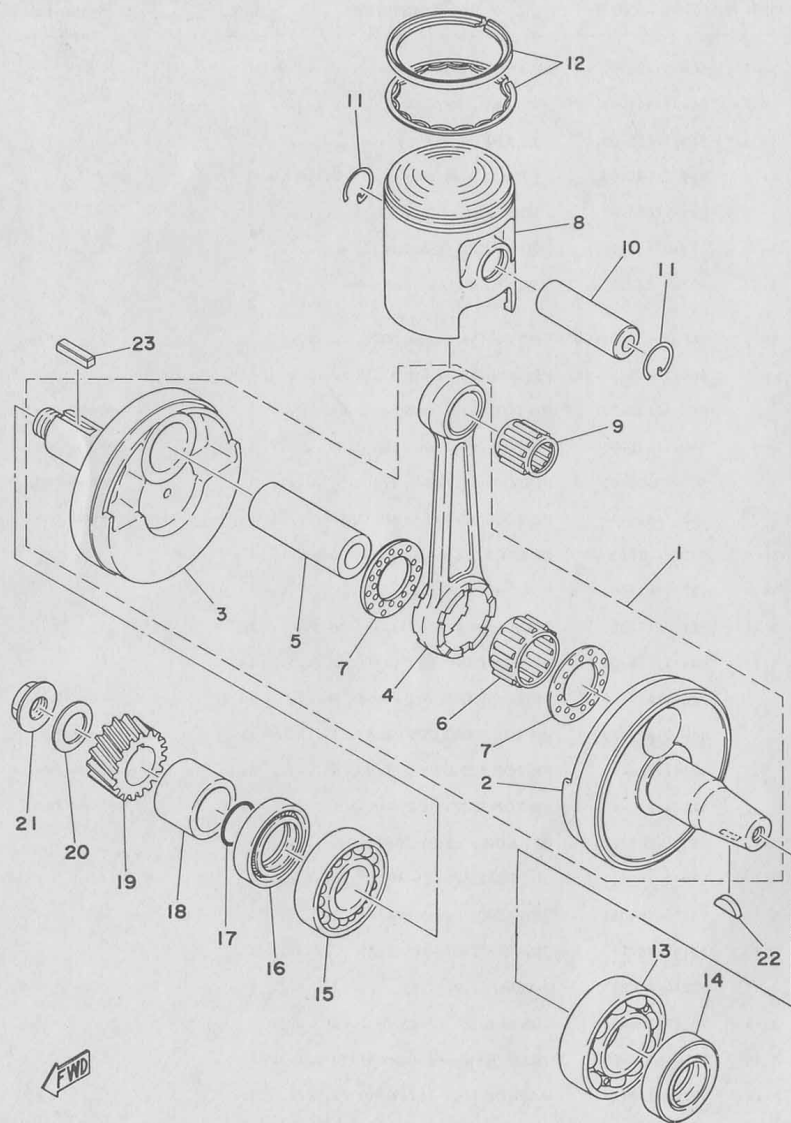

Ref. No.	Part No.	Description	Q'ty	Applicable Machine No.	Remarks
3-21	90179-12244	NUT	1		
3-22	90280-03017	KEY, woodruff (146-11545-00)	1		
3-23	90282-05005	KEY, straight (353-11546-00).....	1		

Fig. 4 CLUTCH

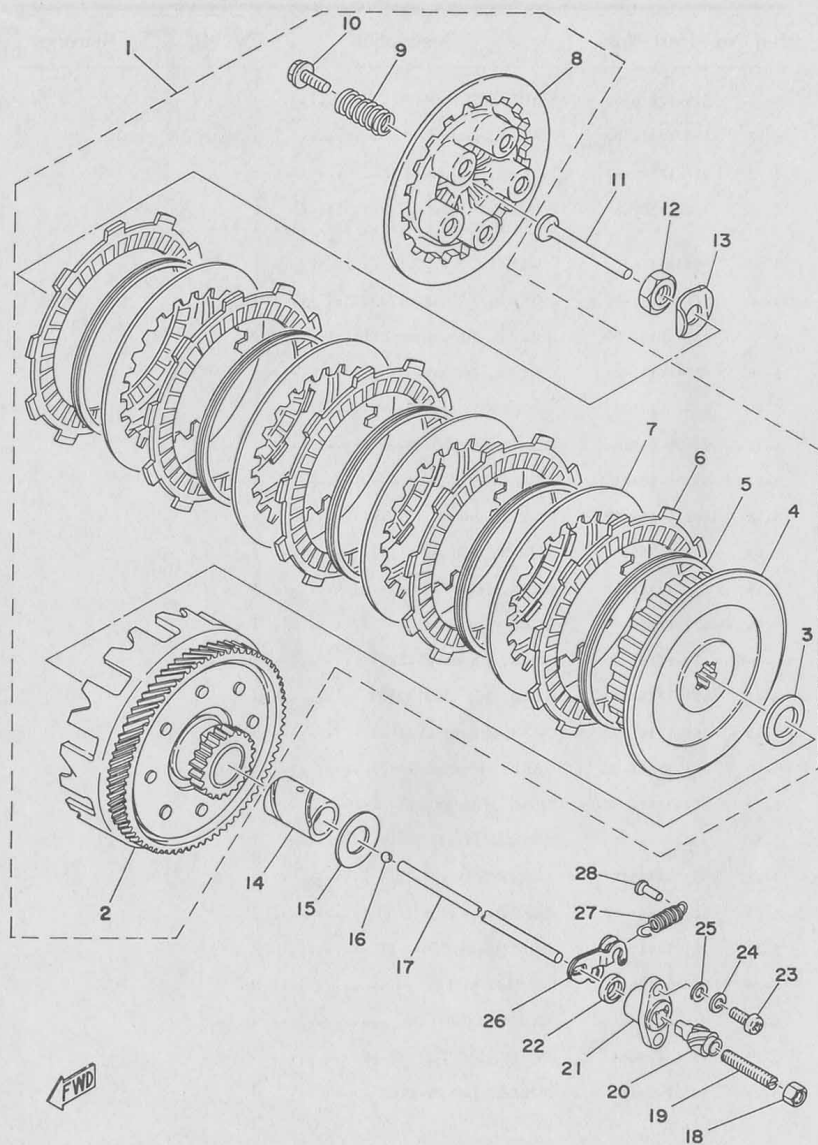

Ref. No.	Part No.	Description	Q'ty	Applicable Machine No.	Remarks
4- 1	559-16301-01	CLUTCH ASS'Y	1		
4- 2	525-16150-00	. PRIMARY DRIVEN GEAR COMP. (74T)	1		
4- 3	122-16164-00	. PLATE, thrust (17.2-30-2.0) ...	1		
4- 4	525-16371-02	. BOSS, clutch	1		
4- 5	307-16367-00	. RING, cushion	5		
4- 6	559-16321-01	. PLATE, friction	5		
4- 7	137-16325-70	. PLATE, clutch 2	4		
4- 8	525-16351-00	. PLATE, pressure	1		
4- 9	90501-20361	. SPRING, compression	5		
4-10	90159-05011	. BOLT, hexagon with washer ...	5		
4-11	137-16356-00	ROD, push 1	1		
4-12	90170-12060	NUT, hexagon (137-16377-00) ...	1		
4-13	90215-12007	WASHER, lock	1		
4-14	90560-17147	SPACER (17-23-34)	1		
4-15	90201-17550	WASHER, plate (17.3-33-3)	1		
4-16	93503-16010	BALL (3/16 inch)	1		
4-17	560-16357-00	ROD, push 2	1		
4-18	95301-06700	NUT, hexagon	1		
4-19	90113-06013	BOLT, set (241-16343-00)	1		
4-20	241-16341-01	SCREW, push	1		
4-21	314-16396-01	HOUSING, push screw	1		
4-22	93104-11028	OIL SEAL (SO-10.5-15-3)	1		
4-23	92501-06015	SCREW, panhead	2		
4-24	92901-06100	WASHER, spring	2		
4-25	92901-06600	WASHER, plate	2		
4-26	241-16342-00	LEVER, push	1		
4-27	90506-10019	SPRING, tension (132-16345-00) ..	1		
4-28	132-16346-00	HOOK, spring	1		

Fig. 5 TRANSMISSION

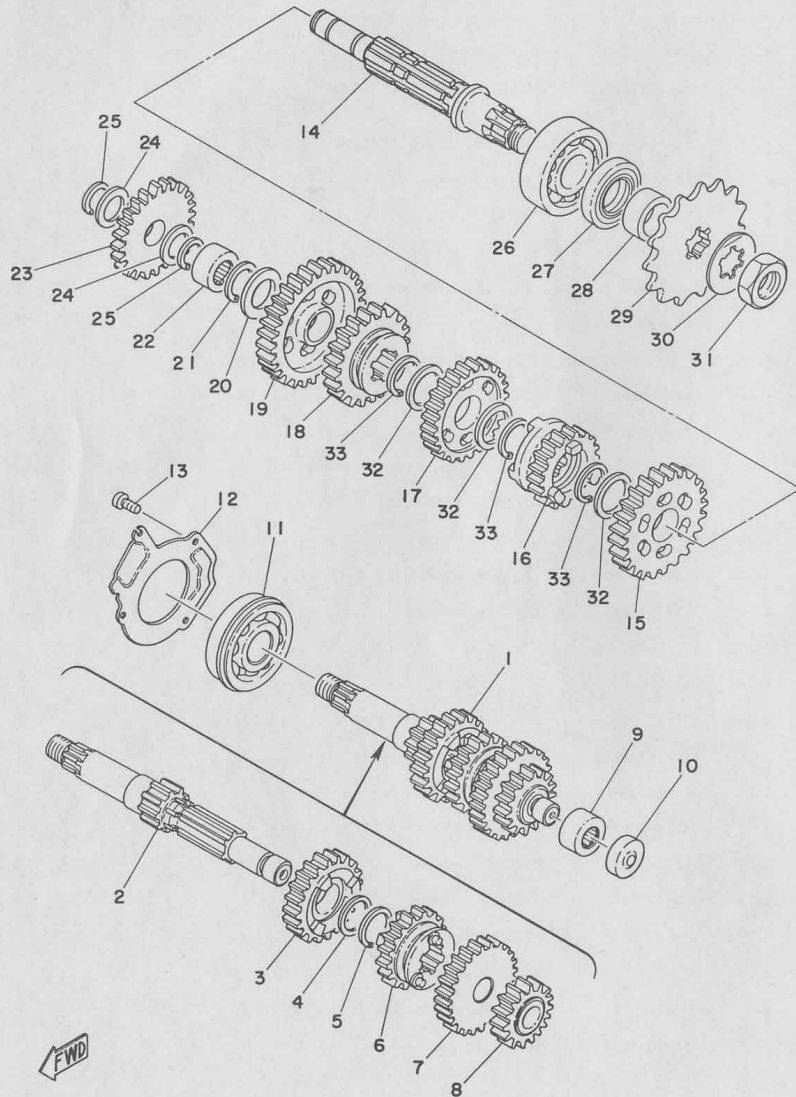

Ref. No.	Part No.	Description	Q'ty	Applicable Machine No.	Remarks
5- 1	578-17410-00	MAIN AXLE COMP.	1		
5- 2	578-17411-00	. AXLE, main (11T)	1		
5- 3	427-17141-00	. GEAR, 4th pinion (22T)	1		
5- 4	90201-20266	. WASHER, plate (132-17216-00) (20-25-1)	1		
5- 5	93410-20038	. CLIP	1		
5- 6	427-17131-00	. GEAR, 3rd pinion (19T)	1		
5- 7	427-17151-00	. GEAR, 5th pinion (23T)	1		
5- 8	427-17121-01	. GEAR, 2nd pinion (16T)	1		
5- 9	93315-31502	BEARING	1		
5-10	93109-05015	OIL SEAL (SDO-48-22-7)	1		
5-11	93306-30414	BEARING (B6304)	1		
5-12	401-17471-00	PLATE, cover	1		
5-13	98501-05012	SCREW, panhead	3		
5-14	558-17421-00	AXLE, drive	1		
5-15	427-17221-00	GEAR, 2nd wheel (30T)	1		
5-16	427-17251-00	GEAR, 5th wheel (22T)	1		
5-17	427-17231-00	GEAR, 3rd wheel (26T)	1		
5-18	265-17241-00	GEAR, 4th wheel (24T)	1		
5-19	265-17211-00	GEAR, 1st wheel (35T)	1		
5-20	164-17427-00-06	SHIM, drive axle (15.2-30-0.6) ...	1		
5-21	93440-15012	CIRCLIP (S-15)	1		
5-22	93311-31515	BEARING (15-25-12)	1		
5-23	525-15651-00	GEAR, kick idle (25T)	1		
5-24	137-17417-00-05	SHIM (15.5-22.0-0.5)	2		
5-25	93440-15012	CIRCLIP (S-15)	2		
5-26	93306-30401	BEARING (B6304)	1		
5-27	93102-26042	OIL SEAL (SD-26-38-5)	1		
5-28	90387-20491	COLLAR (20-26-10.3)	1		

Fig. 5 TRANSMISSION

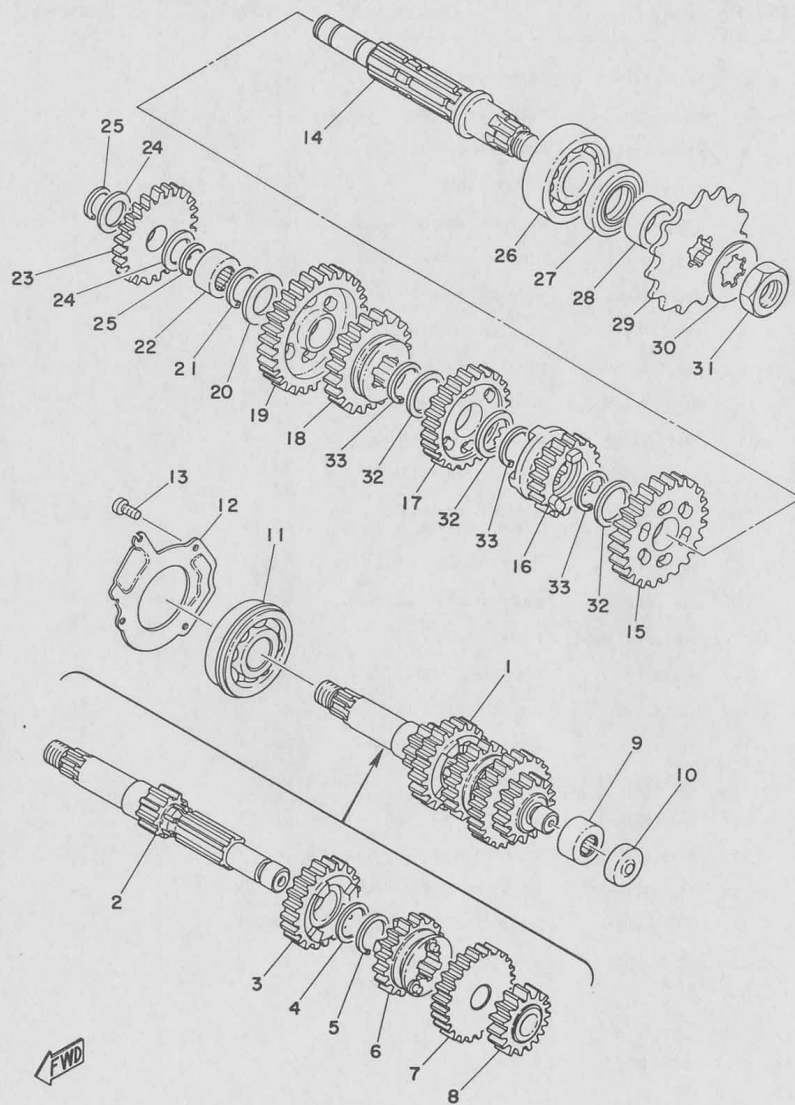

Ref. No.	Part No.	Description	Q'ty	Applicable Machine No.	Remarks
5-29	174-17461-50	SPROCKET, drive (15T)	1		
	174-17461-60	SPROCKET, drive (16T)	1		for FRANCE
5-30	90215-16020	WASHER, lock (102-17464-00)	1		
5-31	90179-16018	NUT, lock (102-17463-00)	1		
5-32	90201-20266	WASHER, plate (132-17216-00) ...	3		
5-33	93410-20038	CLIP	3		

Fig. 6 SHIFTER 1

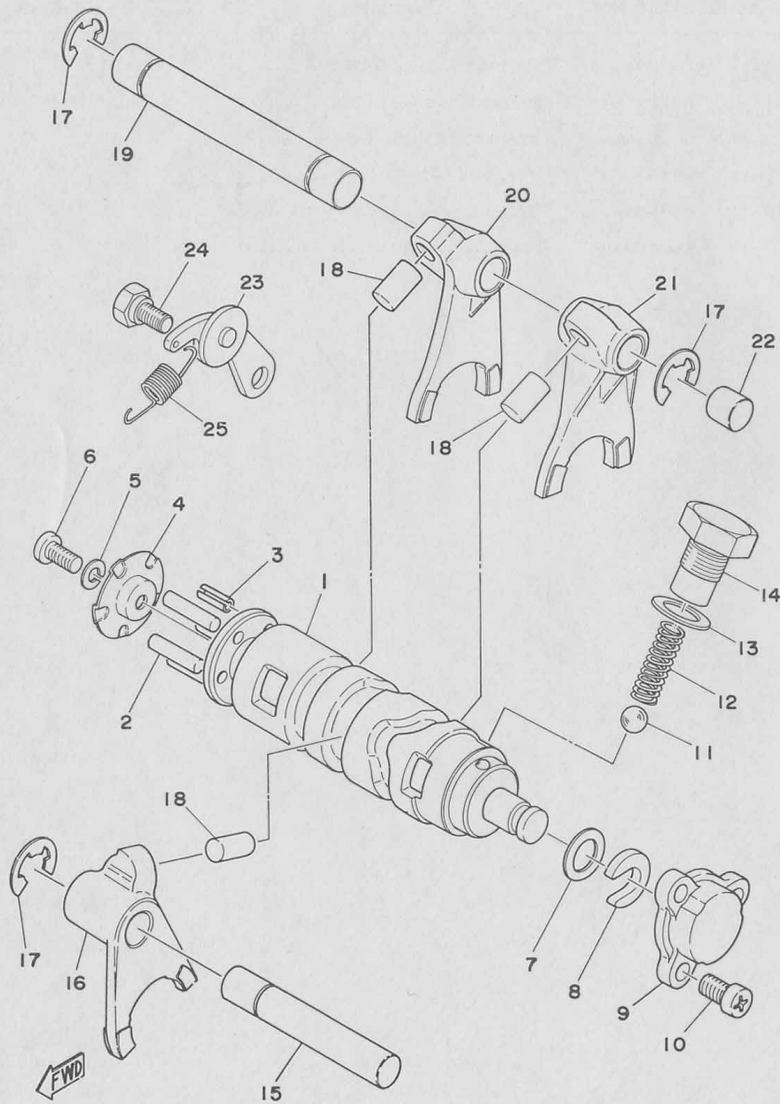

Ref. No.	Part No.	Description	Q'ty	Applicable Machine No.	Remarks
6- 1	315-18541-00	CAM, shift	1		
6- 2	93604-22050	PIN, dowel (4-21.8)	4		
6- 3	91609-40016	PIN, spring	1		
6- 4	164-18561-00	PLATE, side	1		
6- 5	92901-05100	WASHER, spring	1		
6- 6	98501-05012	SCREW, panhead	1		
6- 7	90201-12166	WASHER, plate (164-18572-00) ...	1		
6- 8	164-18571-01	HOLDER, shift cam	1		
6- 9	164-18589-00	PLUG, blind shift cam	1		
6-10	92501-06010	SCREW, panhead	3		
6-11	93505-16006	BALL (5/16 inch)	1		
6-12	90501-12083	SPRING (174-18558-00)	1		
6-13	137-15353-00	GASKET, drain plug (14.5-21-1.5)	1		
6-14	90109-14385	BOLT, hexagon	1		
6-15	248-18531-00	BAR, shift fork guide	1		
6-16	248-18512-01	FORK, shift 2	1		
6-17	93430-10017	CIRCLIP (E-10)	3		
6-18	90250-08017	PIN (278-18552-00)	3		
6-19	214-18531-00	BAR, shift fork guide	1		
6-20	248-18513-01	FORK, shift 3	1		
6-21	248-18511-02	FORK, shift 1	1		
6-22	214-15385-00	PLUG, blind	1		
6-23	132-18140-01	STOPPER LEVER ASS'Y	1		
6-24	90109-06001	BOLT (132-18177-00)	1		
6-25	90506-09112	SPRING, tension	1		

Fig. 7 SHIFTER 2

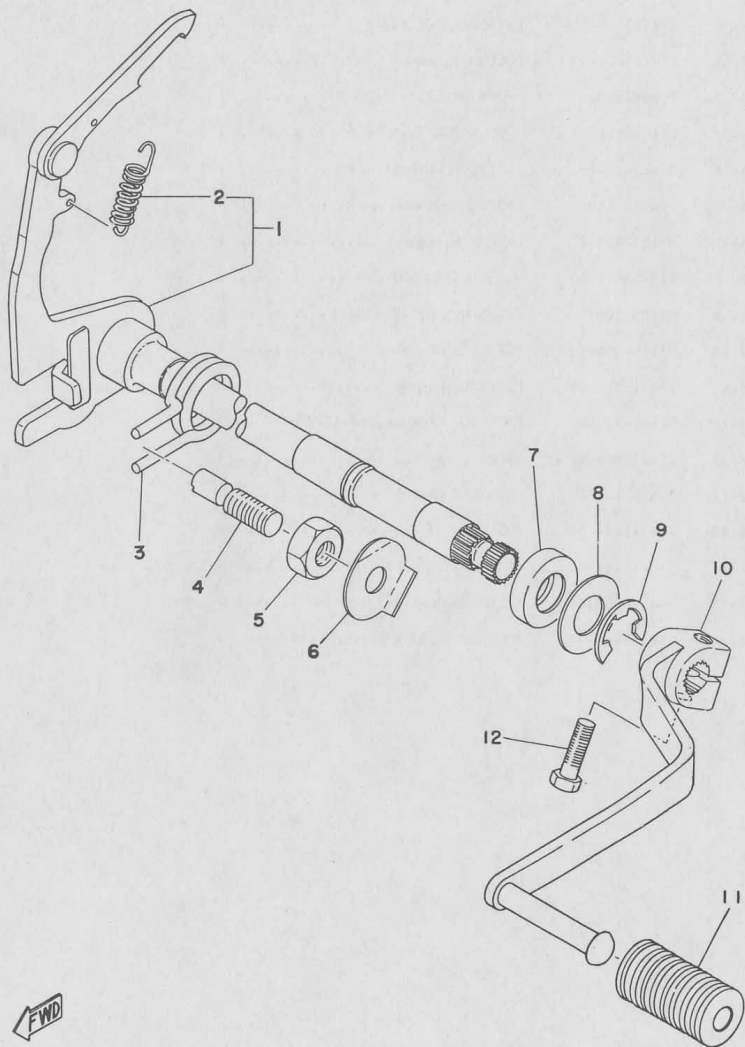

Ref. No.	Part No.	Description	Q'ty	Applicable Machine No.	Remarks
7- 1	248-18101-01	CHANGE SHAFT ASS'Y	1		
7- 2	90506-09009	. SPRING, tension (132-18123-00)	1		
7- 3	90508-32207	SPRING, torsion (132-18124-00) ..	1		
7- 4	90149-08094	SCREW, adjusting	1		
7- 5	90170-08029	NUT, hexagon (248-18134-00)	1		
7- 6	90215-08014	WASHER, lock (248-18139-00)	1		
7- 7	93109-14005	OIL SEAL (SDO-14-24-6)	1		
7- 8	90201-14586	WASHER, plate	1		
7- 9	93430-12009	CIRCLIP (E-12)	1		
7-10	560-18111-00-93	PEDAL, change	1		
7-11	132-18113-01	COVER, change pedal	1		
7-12	97321-06020	BOLT, hexagon	1		

Fig. 8 KICK STARTER

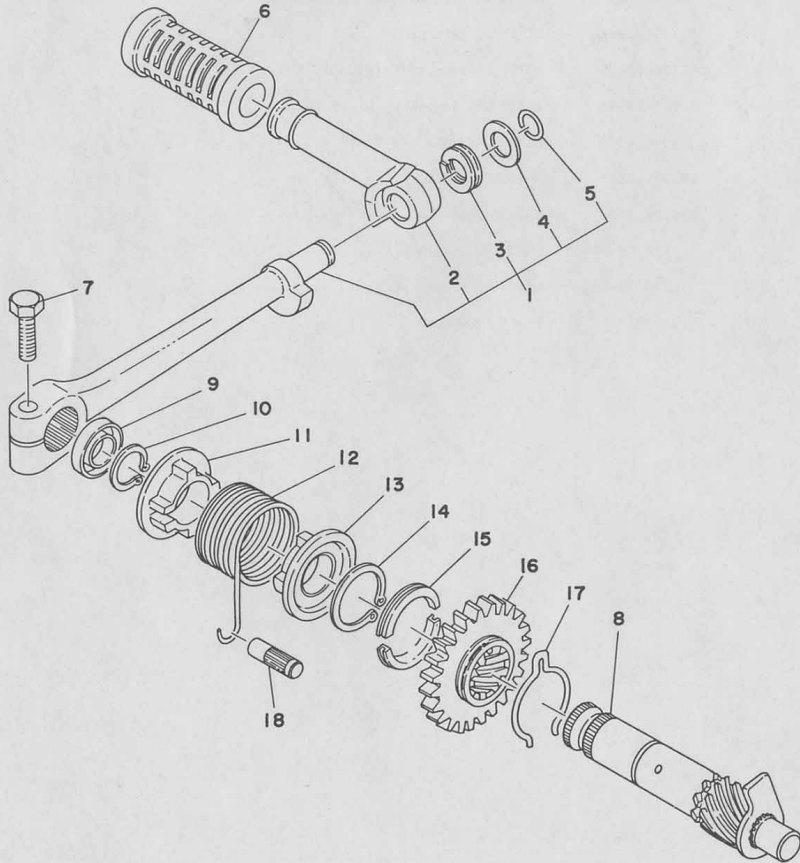

Ref. No.	Part No.	Description	Q'ty	Applicable Machine No.	Remarks
8- 1	248-15610-00-93	KICK CRANK ASS'Y	1		
8- 2	214-15612-01	. LEVER, kick	1		
8- 3	90504-18009	. SPRING (214-15625-01)	1		
8- 4	214-15616-00	. WASHER, kick lever	1		
8- 5	93440-11029	. CLIP (214-15617-00)	1		
8- 6	214-15618-00	COVER, kick lever	1		
8- 7	97321-08030	BOLT, hexagon	1		
8- 8	315-15660-00	KICK AXLE ASS'Y	1		
8- 9	93104-20017	OIL SEAL (SO-20-30-7)	1		
8-10	93410-20009	CIRCLIP (S-20)	1		
8-11	214-15676-00	COVER, spring	1		
8-12	90508-26040	SPRING, torsion (248-15665-00) ..	1		
8-13	214-15664-00	GUIDE, spring	1		
8-14	93410-30012	CIRCLIP (S-30)	1		
8-15	248-15654-00	HOLDER, kick gear	2		
8-16	315-15641-00	GEAR, kick (27T)	1		
8-17	90468-26048	CLIP, kick (315-15687-00)	1		
8-18	248-15668-00	STOPPER, kick spring	1		

FWD

Fig. 9 TACHOMETER GEAR

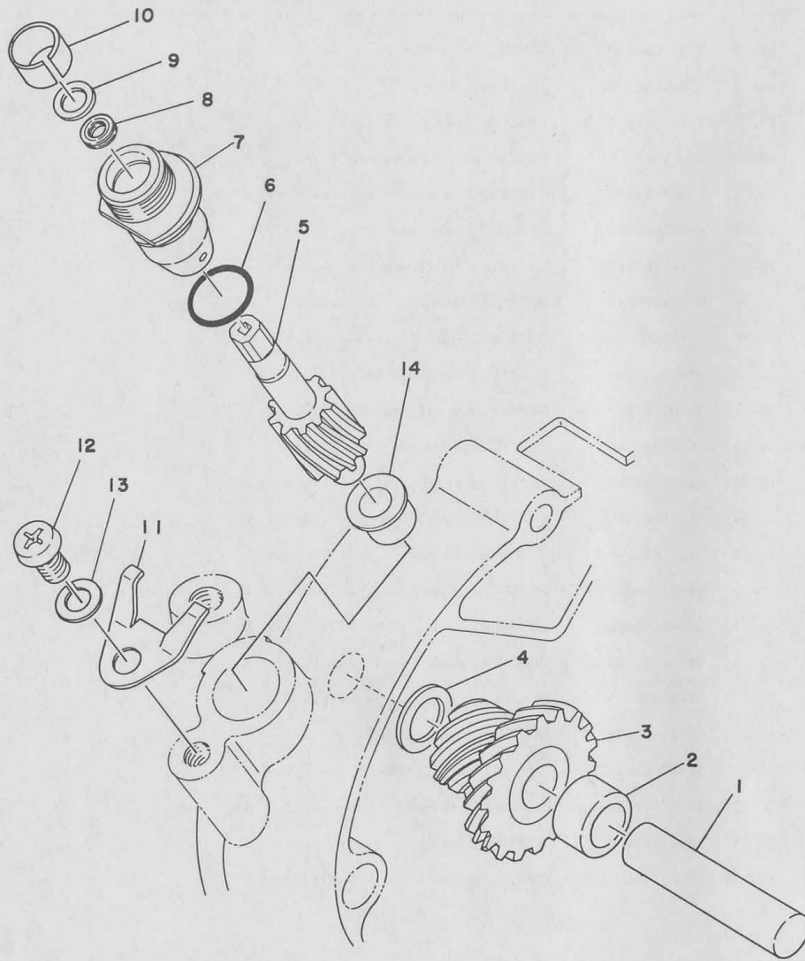

Ref. No.	Part No.	Description	Q'ty	Applicable Machine No.	Remarks
9- 1	248-17861-00	AXLE, drive gear	1		
9- 2	90387-10087	COLLAR (248-17839-01)	1		
9- 3	248-17831-02	GEAR, drive (3T)	1		
9- 4	248-17837-00	SHIM (10.2-16-1.0)	1		
9- 5	248-17841-00	GEAR, driven (15T)	1		
9- 6	93210-13016	O-RING (1.8-13)	1		
9- 7	214-17811-02	HOUSING	1		
9- 8	353-17816-00	SEAL, housing	1		
9- 9	214-17847-00	SHIM (7.5-10.8-0.4)	1		
9-10	90383-10005	BUSHING (214-17815-00)	1		
9-11	214-17812-00	STOPPER	1		
9-12	92501-06010	SCREW, panhead	1		
9-13	92901-06100	WASHER, spring	1		
9-14	90381-08002	BUSHING (214-17843-00)	1		

FWD

Fig. 10 INTAKE

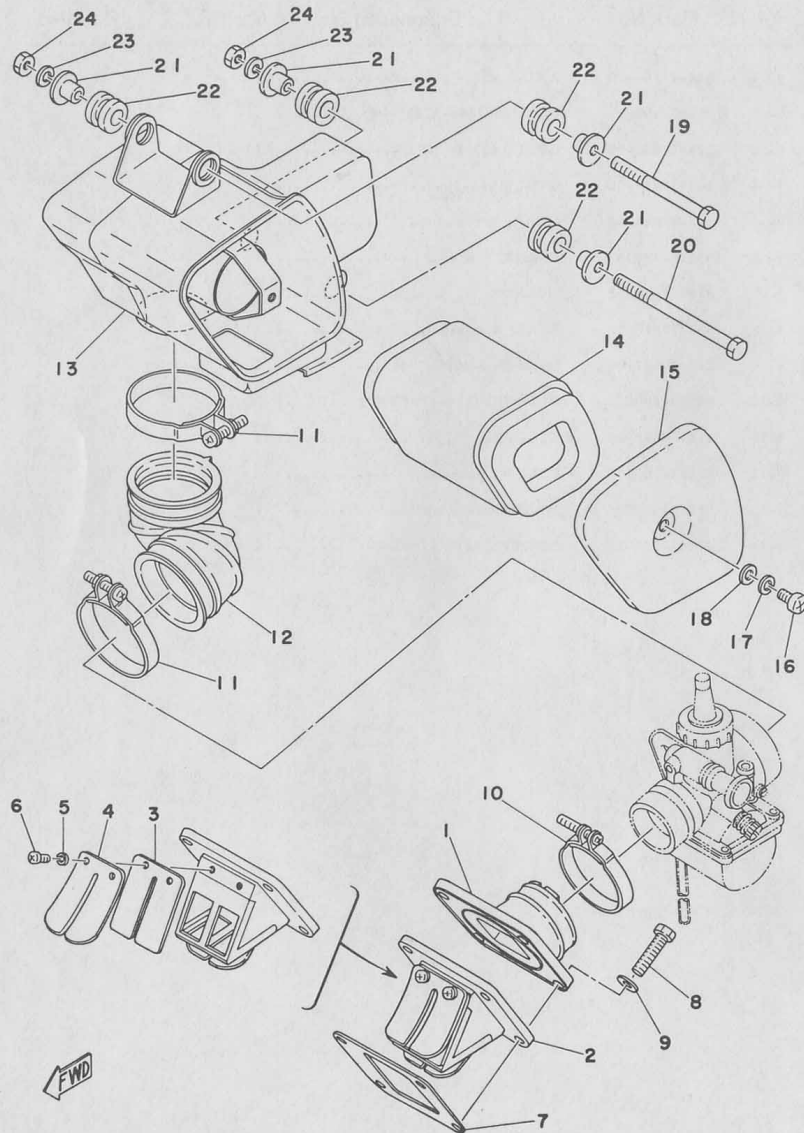

Ref. No.	Part No.	Description	Q'ty	Applicable Machine No.	Remarks
10- 1	560-13565-00	JOINT, carburetor	1		
10- 2	314-13610-01	REED VALVE ASS'Y	1		
10- 3	314-13613-00	. REED, valve	2		
10- 4	314-13616-01	. STOPPER, reed valve	2		
10- 5	92901-03100	. WASHER, spring	4		
10- 6	98512-03008	. SCREW, panhead	4		
10- 7	314-13621-02	PACKING, valve seat	1		
10- 8	97301-06025	BOLT, hexagon	4		
10- 9	92901-06600	WASHER, plate	4		
10-10	90460-43053	CLAMP, hose (304-14455-70)	1		
10-11	90460-49058	CLAMP, hose (278-14455-00)	2		
10-12	560-14453-00	JOINT, air cleaner	1		
10-13	560-14411-00	CASE, air cleaner	1		
10-14	560-14451-00	ELEMENT, air cleaner	1		
10-15	560-14412-00	CAP, cleaner case	1		
10-16	92501-06010	SCREW, panhead	1		
10-17	92901-06100	WASHER, spring	1		
10-18	92901-06600	WASHER, plate	1		
10-19	97321-06075	BOLT, hexagon	1		
10-20	97321-06095	BOLT, hexagon	1		
10-21	90387-07391	COLLAR (437-21633-00)	4		
10-22	90480-14102	GROMMET (214-21717-00)	4		
10-23	92901-06100	WASHER, spring	2		
10-24	95301-06600	NUT, hexagon	2		

Fig. 11 CARBURETOR

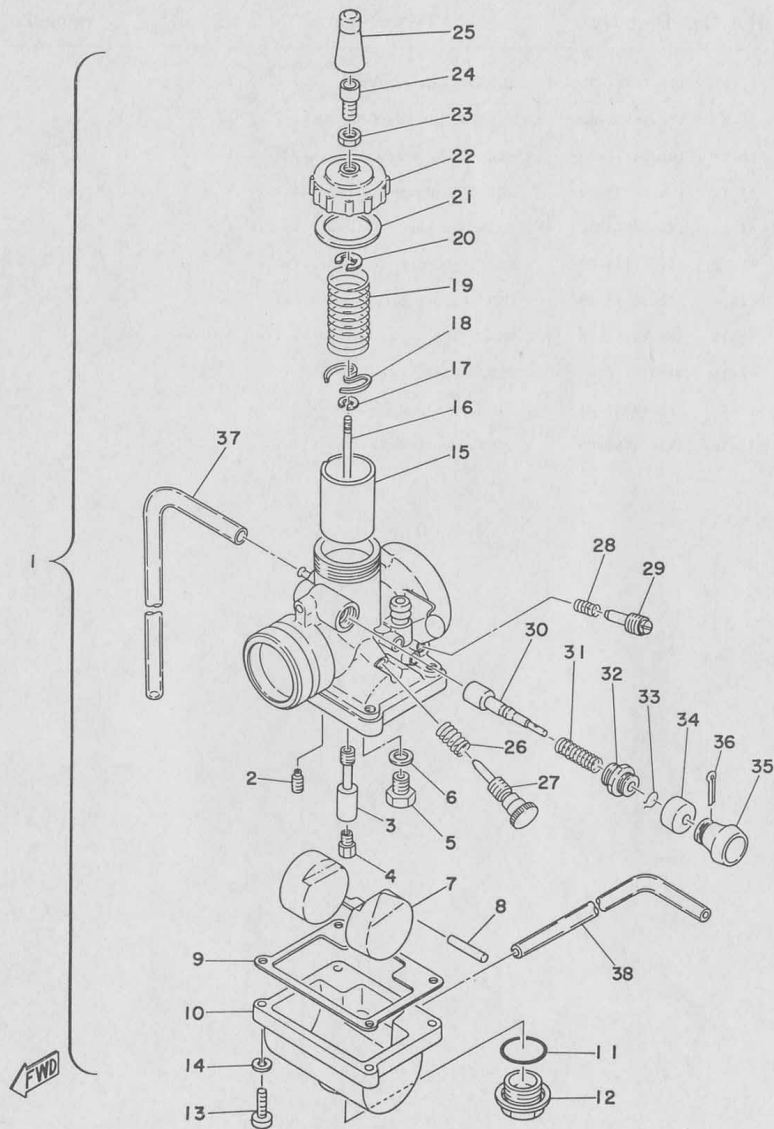

Ref. No.	Part No.	Description	Q'ty	Applicable Machine No.	Remarks
11- 1	560-14101-60	CARBURETOR ASS'Y	1		
11- 2	260-14142-25	. JET, pilot (#25)	1		
11- 3	558-14141-32	. NOZZLE, main (0-2)	1		
11- 4	137-14143-19	. JET, main (#95)	} U.R. 1		STD
	137-14143-20	. JET, main (#100)			
	137-14143-21	. JET, main (#105)			
11- 5	168-14190-25	. VALVE SEAT ASS'Y (#2.5)	1		
11- 6	214-14195-00	. WASHER, valve seat	1		
11- 7	314-14185-00	. FLOAT	1		
11- 8	137-14186-01	. PIN, float	1		
11- 9	304-14184-00	. GASKET, float chamber	1		
11-10	539-14181-08	. BODY, float chamber	1		
11-11	558-14147-00	. O-RING	1		
11-12	500-14115-00	. PLUG, screw	1		
11-13	98502-04014	. SCREW, panhead	4		
11-14	92901-04100	. WASHER, spring	4		
11-15	314-14112-20	. VALVE, throttle (#2.0)	1		
11-16	443-14116-02	. NEEDLE (4G2-2)	1		
11-17	164-14137-00	. CLIP	1		
11-18	246-14132-00	. STOPPER, cable	1		
11-19	248-14131-00	. SPRING, throttle valve	1		
11-20	363-14137-00	. CLIP	1		
11-21	246-14126-00	. PACKING	1		
11-22	802-14158-00	. TOP, mixing chamber	1		
11-23	802-14161-00	. NUT, wire adjusting	1		
11-24	360-14124-20	. SCREW, wire adjusting	1		
11-25	802-14169-00	. CAP	1		
11-26	493-14133-00	. SPRING, throttle stop	1		
11-27	493-14122-00	. SCREW, throttle	1		

Fig. 11 CARBURETOR

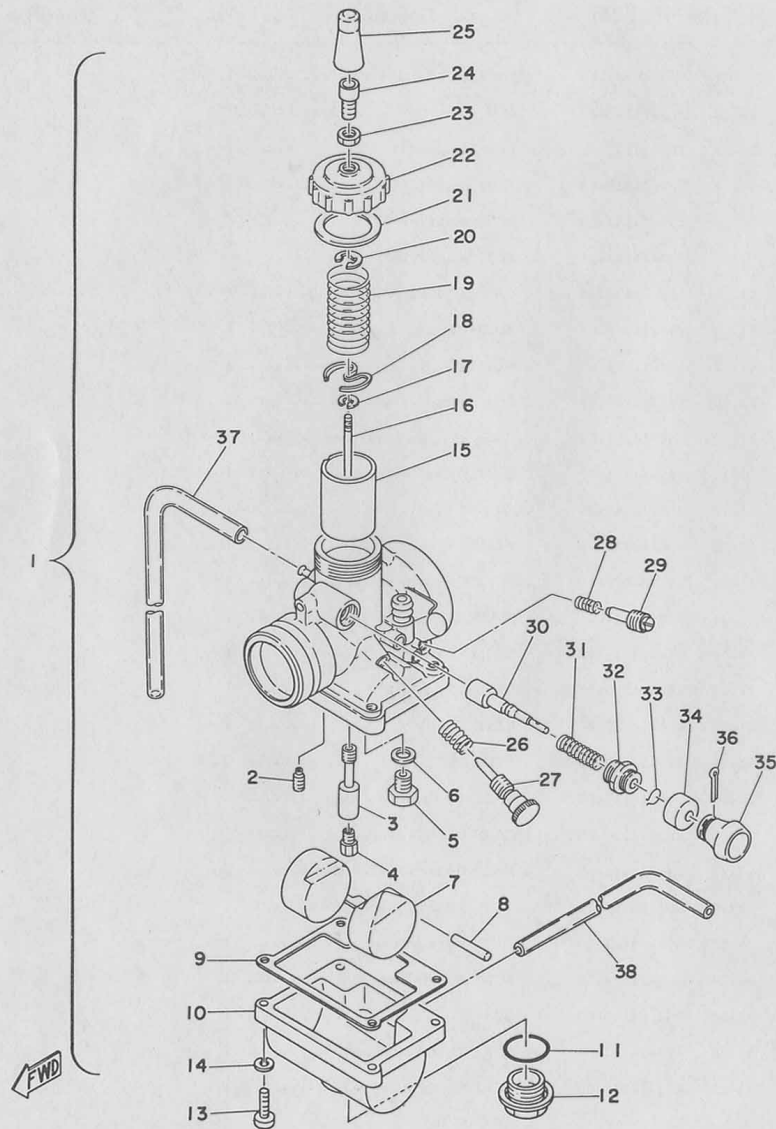

Ref. No.	Part No.	Description	Q'ty	Applicable Machine No.	Remarks
11-28	174-14134-00	. SPRING, air adjusting	1		
11-29	174-14123-00	. SCREW, air adjusting	1		
11-30	304-14171-00	. PLUNGER, starter	1		
11-31	156-14135-00	. SPRING, plunger	1		
11-32	152-14174-00	. CAP, plunger	1		
11-33	353-14138-00	. CLIP, plunger	1		
11-34	132-14173-00	. COVER, plunger cap	1		
11-35	304-14261-00	. HOLDER	1		
11-36	91401-16015	. PIN, cotter	1		
11-37	183-14197-01	. PIPE, air vent (3-220)	1		
11-38	183-14196-00	. PIPE, overflow (3-160)	1		

Fig. 12 EXHAUST

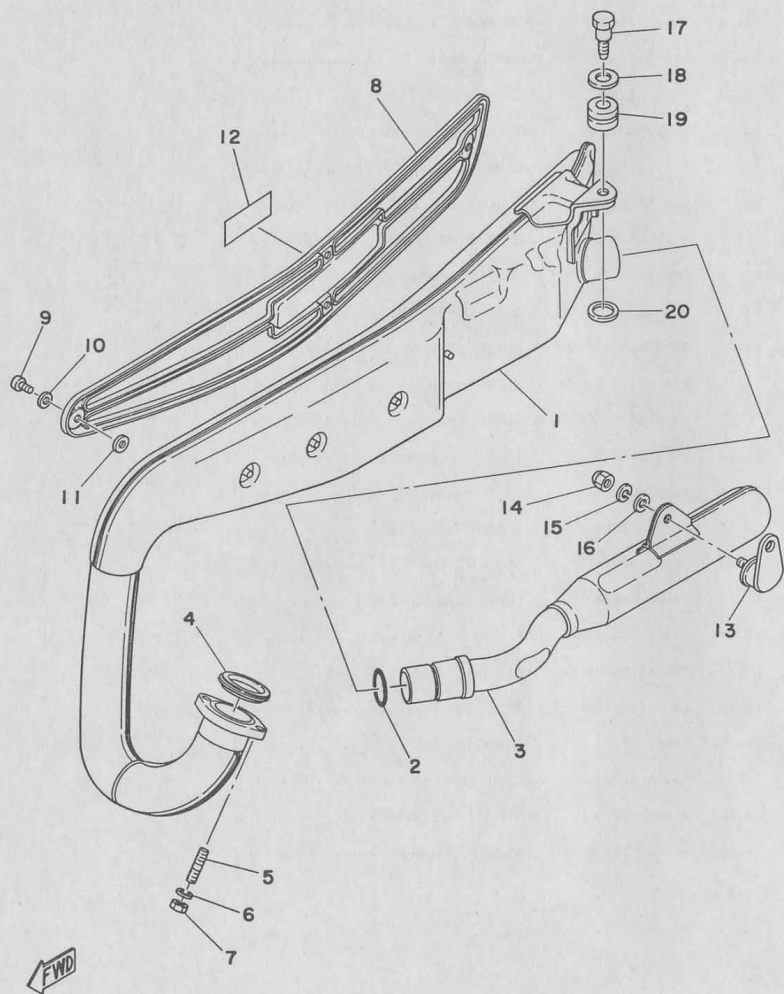

Ref. No.	Part No.	Description	Q'ty	Applicable Machine No.	Remarks
12- 1	577-14610-00	EXHAUST PIPE ASS'Y	1		
12- 2	93210-24235	O-RING (3.1-24.4)	1		
12- 3	577-14753-00	SILENCER	1		
12- 4	152-14613-00	GASKET, exhaust pipe	1		
12- 5	90116-06016	BOLT, stud (306-11179-00)	2		
12- 6	92901-06100	WASHER, spring	2		
12- 7	95301-06600	NUT, hexagon	2		
12- 8	560-14718-00	PROTECTOR, muffler	1		
12- 9	98903-06010	SCREW, bind	4		
12-10	90202-06010	WASHER, plate (178-14766-00) ...	4		
12-11	90202-05005	WASHER, plate (214-14766-00) ...	4		
12-12	1G0-14729-10	EMBLEM, protector	1		
12-13	560-14791-00	STAY, silencer	1		
12-14	95301-08800	NUT, crown	1		
12-15	92901-08100	WASHER, spring	1		
12-16	92901-08200	WASHER, plain	1		
12-17	90109-08391	BOLT	1		
12-18	90201-12190	WASHER, plate (122-22243-00) ...	1		
12-19	168-21638-00	DAMPER, front	1		
12-20	90201-18262	WASHER, plate (168-21758-00) ...	1		

Fig. 13 OIL PUMP

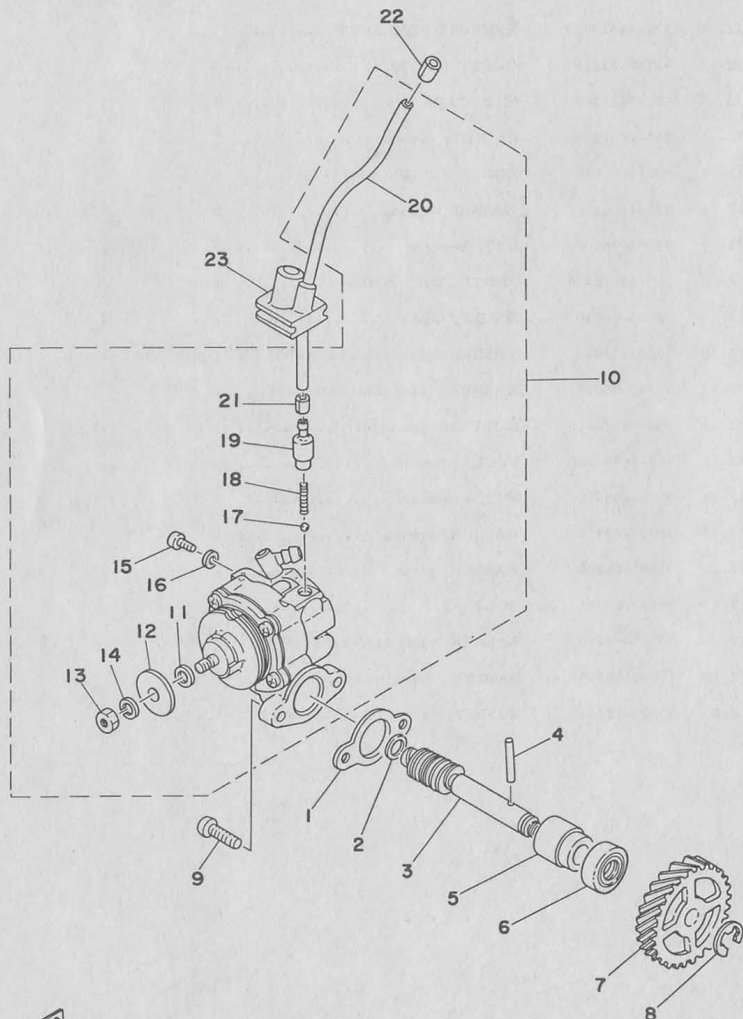

Ref. No.	Part No.	Description	Q'ty	Applicable Machine No.	Remarks
13- 1	126-13116-00	GASKET, pump case	1		
13- 2	90201-08624	WASHER	1		
13- 3	214-13175-02	SHAFT, worm	1		
13- 4	93603-22028	PIN, dowel (3-21.8)	1		
13- 5	1E7-13176-00	METAL, worm shaft outer	1		
13- 6	93101-10002	OIL SEAL (S-10-22-7)	1		
13- 7	248-13178-00	GEAR, drive (28T)	1		
13- 8	93430-08006	CIRCLIP (E-8)	1		
13- 9	98501-05016	SCREW, panhead	2		
13-10	1G0-13101-00	OIL PUMP ASS'Y	1		
13-11	137-13137-00-03	. SHIM, plunger (5.8-10-0.3)...	} U.R 1		
	137-13137-00-05	. SHIM, plunger (5.8-10-0.5)...			
	137-13137-00-10	. SHIM, plunger (5.8-10-1.0)...			
13-12	137-13138-01	. PLATE, adjusting	1		
13-13	95301-05600	. NUT, hexagon	1		
13-14	92901-05100	. WASHER, spring	1		
13-15	98901-04008	. SCREW, bind	1		
13-16	90430-04004	. GASKET (137-13187-00)	1		
13-17	93505-32002	. BALL (5/32 inch)	1		
13-18	278-13169-00	. SPRING	1		
13-19	402-13552-00	. NOZZLE	1		
13-20	90445-05278	. HOSE (3-200)	1		
13-21	90468-02033	. CLIP (214-13164-00)	1		
13-22	90468-02033	CLIP (214-13164-00)	1		
13-23	525-13174-00	HOLDER, oil pipe	1		

FWD

Fig. 14 STARTER GENERATOR

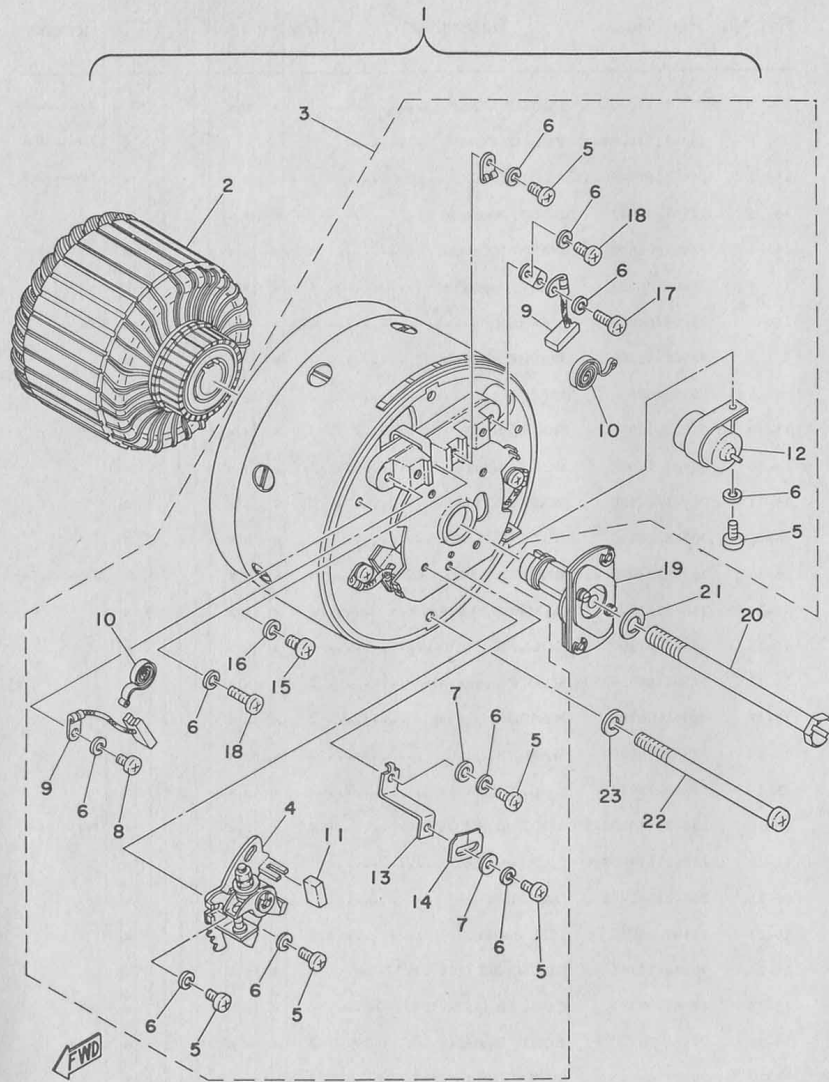

Ref. No.	Part No.	Description	Q'ty	Applicable Machine No.	Remarks
14- 1	444-81100-10	STARTER GENERATOR ASS'Y....	1		
14- 2	444-81155-10	. . ARMATURE	1		
14- 3	444-81110-10	. . STATOR ASS'Y	1		
14- 4	183-81421-10	. . CONTACT BREAKER ASS'Y...	1		
14- 5	98501-04008	. . SCREW, panhead	7		
14- 6	92901-04100	. . WASHER, spring	17		
14- 7	92901-04200	. . WASHER, plain	4		
14- 8	98501-04006	. . SCREW, panhead	7		
14- 9	101-81111-10	. . BRUSH	4		
14-10	141-81113-10	. . SPRING, brush	4		
14-11	207-81331-10	. . LUBRICATOR	1		
14-12	148-81126-10	. . CONDENSER	1		
14-13	299-81133-10	. . FIXTURE, timing plate	1		
14-14	133-81132-10	. . PLATE, timing	1		
14-15	98501-05008	. . SCREW, panhead	1		
14-16	92901-05100	. . WASHER, spring	1		
14-17	98503-04010	. . SCREW, panhead	1		
14-18	98501-04012	. . SCREW, panhead	2		
14-19	444-81153-10	. . GOVERNOR ASS'Y	1		
14-20	148-81152-10	. . BOLT	1		
14-21	92901-08100	. . WASHER, spring	1		
14-22	92501-06080	SCREW, panhead	2		
14-23	92901-06100	WASHER, spring	2		

Fig. 15 FRAME

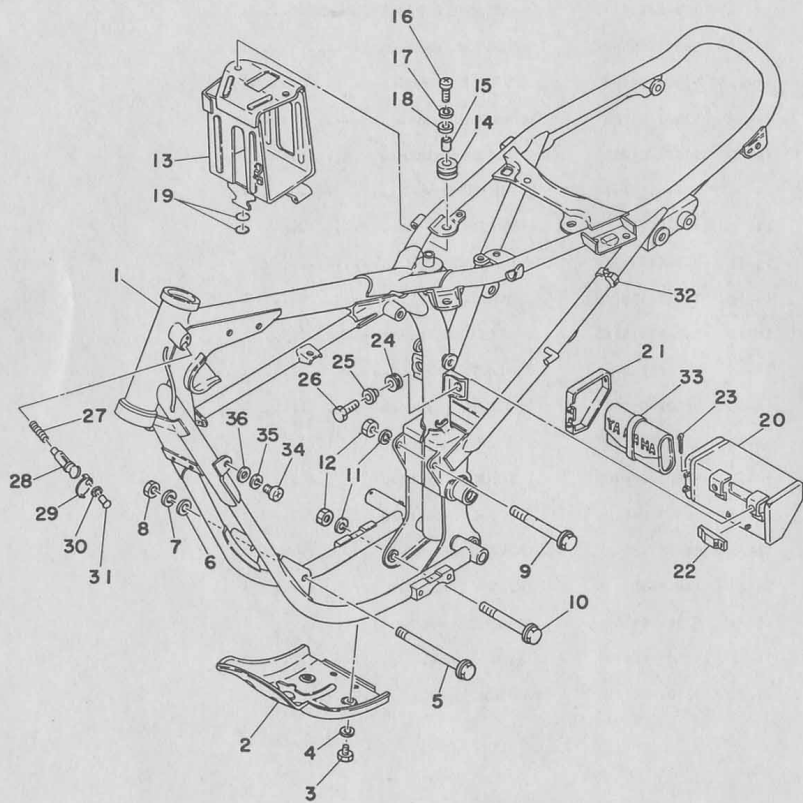

Ref. No.	Part No.	Description	Q'ty	FRANCE	HOLLAND	SWITZERLAND W. GERMANY	BELEMEN	SWITZERLAND	FINLAND	NETHERLANDS	ASIA	ENGLAND	ITALY	Remarks
15- 1	577-21110-00-33	FRAME COMP.	1	x	x	x								Yamaha Black
	560-21110-00-33	FRAME COMP.	1									x		Yamaha Black
15- 2	248-21471-00-33	PROTECTOR, engine	1	x	x	x						x		Yamaha Black
15- 3	97301-06012	BOLT, hexagon	4	x	x	x						x		
15- 4	92901-06600	WASHER, plate	4	x	x	x						x		
15- 5	90105-08024	BOLT, hexagon	1	x	x	x						x		
15- 6	90209-08050	WASHER	2	x	x	x						x		
15- 7	92901-08100	WASHER, spring	1	x	x	x						x		
15- 8	90185-08054	NUT U	1	x	x	x						x		
15- 9	95821-10095	BOLT, flange	1	x	x	x						x		
15-10	95821-10085	BOLT, flange	1	x	x	x						x		
15-11	92901-10100	WASHER, spring	2	x	x	x						x		
15-12	90185-10035	NUT U	2	x	x	x						x		
15-13	261-21240-00-33	BATTERY BOX COMP.	1	x	x	x						x		Yamaha Black
15-14	248-21717-00	DAMPER, battery box	2	x	x	x						x		
15-15	90387-07390	COLLAR	2	x	x	x						x		
15-16	92501-06025	SCREW, panhead	2	x	x	x						x		
15-17	92901-06100	WASHER, spring	2	x	x	x						x		
15-18	92901-06600	WASHER, plate	2	x	x	x						x		
15-19	93210-11012	O-RING (2.4-11.4)	2	x	x	x						x		
15-20	248-21170-00-33	TOOL BOX COMP.	1	x	x	x						x		Yamaha Black
15-21	248-21399-00	CAP, tool box	1	x	x	x						x		
15-22	248-21746-00	DAMPER, tool box	1	x	x	x						x		
15-23	91401-25030	PIN, cotter	1	x	x	x						x		
15-24	90480-14102	GROMMET (214-21717-00) ..	2	x	x	x						x		
15-25	90387-07391	COLLAR (437-21633-00)	2	x	x	x						x		
15-26	97301-06020	BOLT, hexagon	2	x	x	x						x		
15-27	90502-08005	SPRING (214-23485-00)	1			x						x		
	*	SPRING, conical	1	x	x									

*: The parts marked with * in the parts No. column are not supplied with by Yamaha, those have to be found locally.

Fig. 15 FRAME

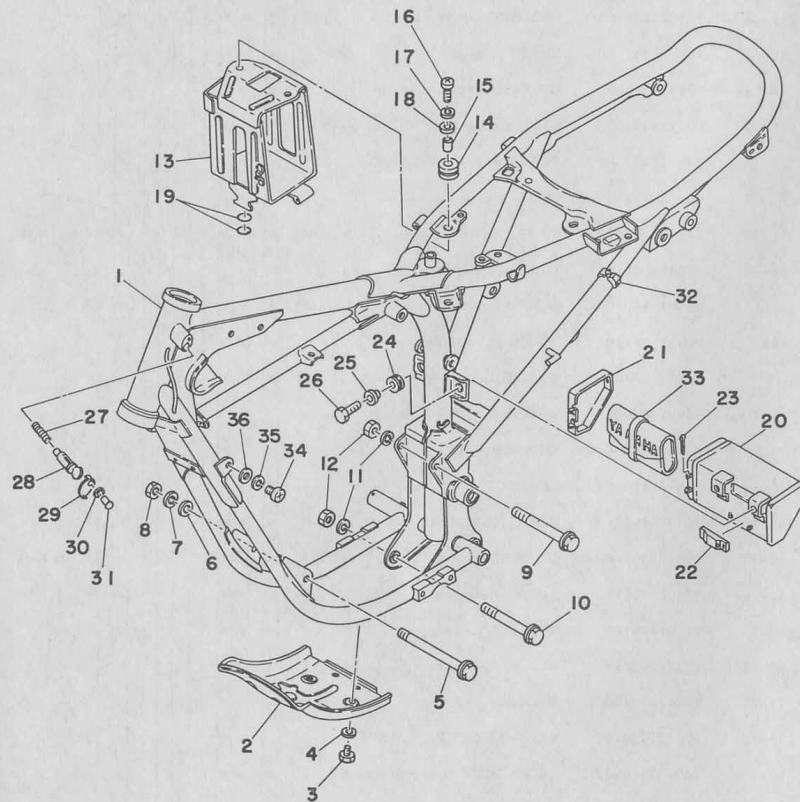

Ref. No.	Part No.	Description	Qty	FRANCE	HOLLAND	WEST GERMANY	SWITZERLAND	BEIJING	FINLAND	DENMARK	NORWAY	AUSTRIA	ENGLAND	ITALY	Remarks
15-28	341-23408-01	STEERING LOCK ASS'Y ...	1				x							x	
	*	STEERING LOCK ASS'Y ...	1	x	x										
15-29	134-23484-10	CAP, handle lock	1					x						x	
	*	CAP, handle lock	1	x	x										
15-30	90206-04003	WASHER, wave (214-23488-00)	1					x						x	
	*	WASHER, wave	1	x	x										
15-31	90269-04003	RIVET (214-23483-00)	1					x						x	
	*	RIVET	1	x	x										
15-32	444-14747-00	DAMPER, muffler	1	x	x	x								x	
15-33	443-28100-10	TOOL ASS'Y	1	x	x	x								x	
15-34	98501-05010	SCREW, panhead	2	x	x	x								x	
15-35	92901-05100	WASHER, spring	2	x	x	x								x	
15-36	92901-05200	WASHER, plate	2	x	x	x								x	

www.davesbikes.weebly.com

*: The parts marked with * in the parts No. column are not supplied with by Yamaha, those have to be found locally.

Fig. 16 REAR ARM · REAR CUSHION · CHAIN CASE

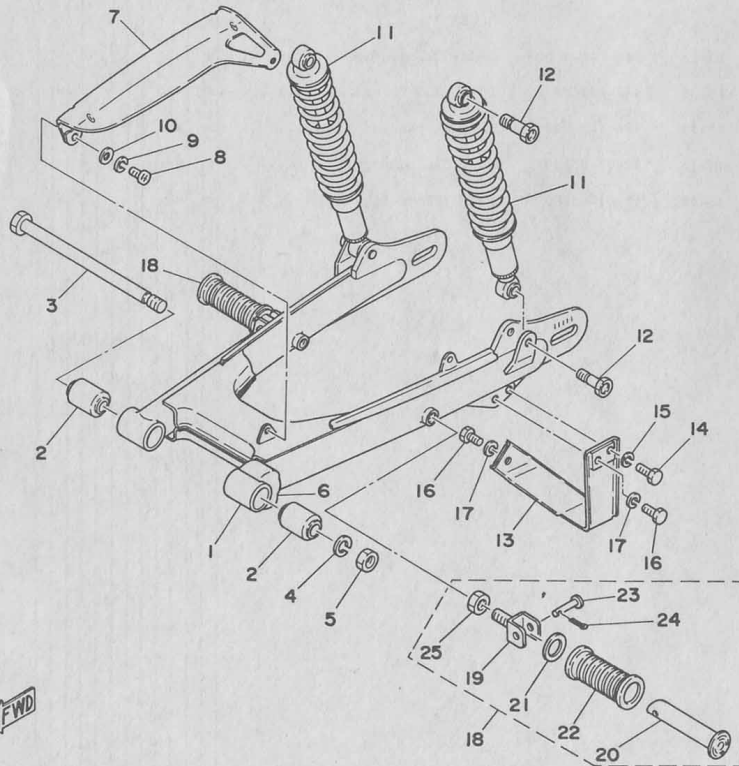
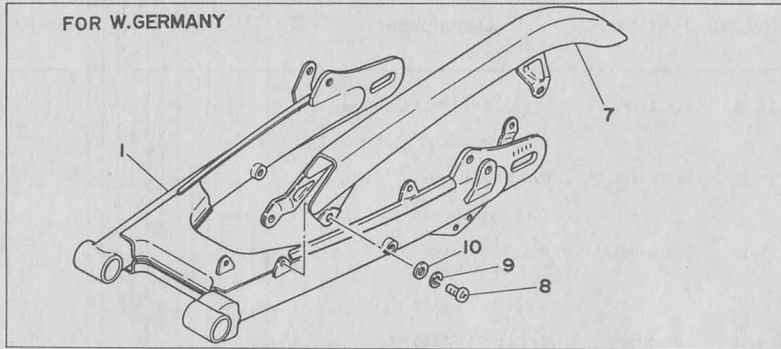

Ref. No.	Part No.	Description	Q'ty	FRANCE	HOLLAND	SWITZERLAND	W.GERMANY	BELGIUM	SWEDEN	FINLAND	DENMARK	NORWAY	IRELAND	ITALY	Remarks
16- 1	577-22110-00-33	REAR ARM COMP.	1	x											Yamaha Black
	560-22110-00-33	REAR ARM COMP.	1	x	x										Yamaha Black
16- 2	174-22123-00	BUSHING, rear arm	2	x	x	x									
16- 3	248-22141-00	SHAFT, pivot	1	x	x	x									
16- 4	92901-14100	WASHER, spring	1	x	x	x									
16- 5	90170-14163	NUT, hexagon	1	x	x	x									
16- 6	248-22151-00	SEAL, guard	1	x	x	x									
16- 7	444-22311-10-33	CASE, chain	1	x											Yamaha Black
	444-22311-00-33	CASE, chain	1	x	x										Yamaha Black
16- 8	98501-05010	SCREW, panhead	3	x											
	98501-05010	SCREW, panhead	2	x	x										
16- 9	92901-05100	WASHER, spring	3	x		x									
	92901-05100	WASHER, spring	2	x	x										
16-10	92901-05600	WASHER, plate	3	x											
	92901-05600	WASHER, plate	2	x	x										
16-11	558-22210-01	REAR CUSHION ASS'Y ...	2	x	x	x									
16-12	90109-10195	BOLT (401-22241-00)	4	x	x	x									
16-13	248-22318-00-33	GUARD, chain	1	x	x	x									Yamaha Black
16-14	97301-06018	BOLT, hexagon	1	x	x	x									
16-15	92901-06100	WASHER, spring	1	x	x	x									
16-16	97301-08018	BOLT, hexagon	2	x	x	x									
16-17	92901-08100	WASHER, spring	2	x	x	x									
16-18	120-27430-02	REAR FOOTREST ASS'Y ..	2	x	x	x									
16-19	120-27430-02	. BRACKET, rear footrest	2	x	x	x									
16-20	120-27431-00	. ARM, rear footrest	2	x	x	x									
16-21	90201-20279	. WASHER, plate	2	x	x	x									
16-22	120-27433-00	. COVER, rear footrest ...	2	x	x	x									
16-23	90240-06009	. PIN, with hole	2	x	x	x									

Fig. 16 REAR ARM · REAR CUSHION · CHAIN CASE

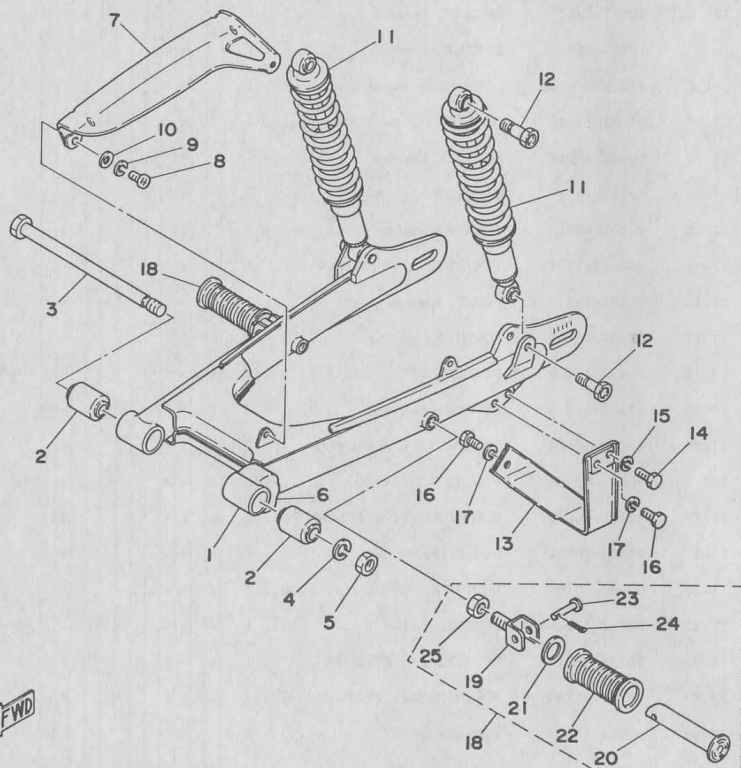
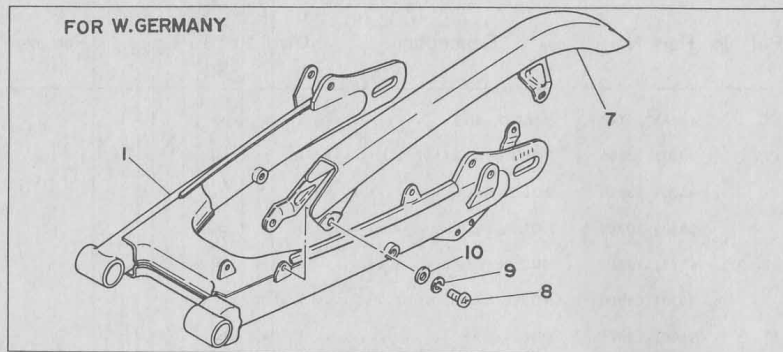

Ref. No.	Part No.	Description	Q'ty	FRANCE	HOLLAND	SWITZERLAND	W. GERMANY	BELGIUM	FINLAND	DENMARK	NORWAY	AUSTRIA	ENGLAND	ITALY	Remarks
16-24	91401-16015	. PIN, cotter	2	x	x	x								x	
16-25	95301-12700	. NUT, hexagon	2	x	x	x								x	

Fig. 17 STAND · FOOTREST · BRAKE PEDAL

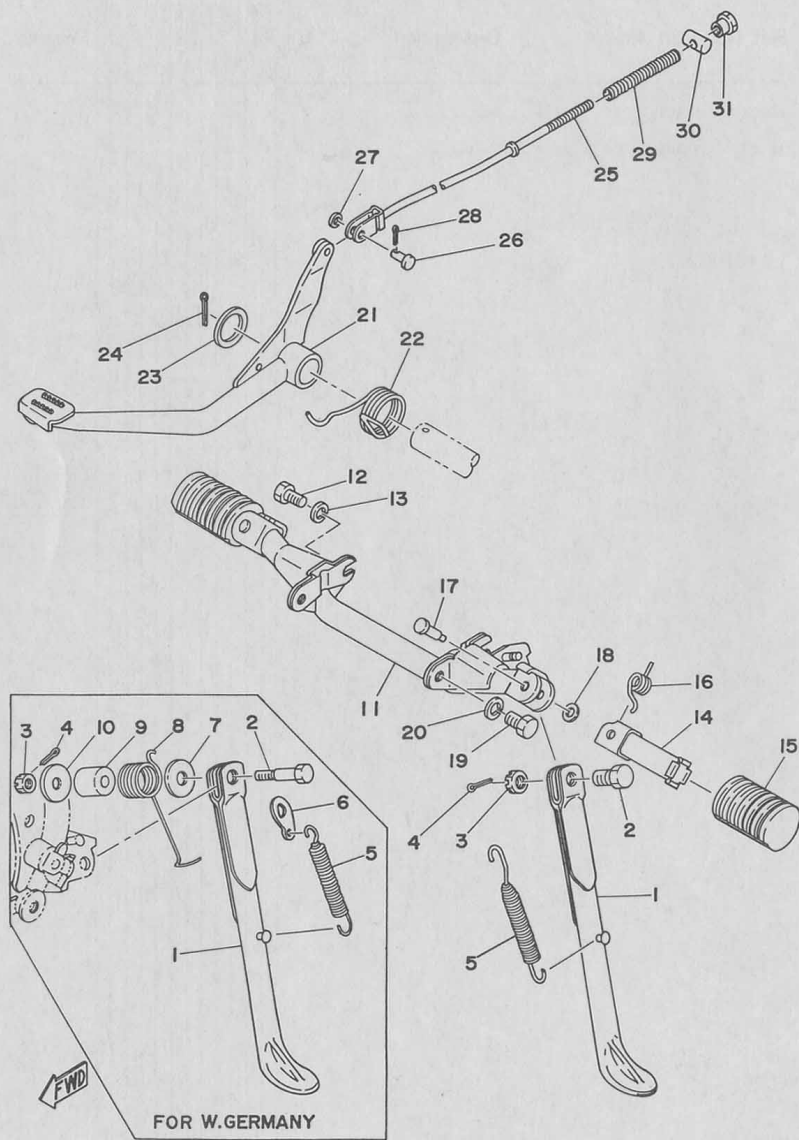

Ref. No.	Part No.	Description	Q'ty	FRANCE	HOLLAND	W. GERMANY	SWITZERLAND	BELGIUM	DENMARK	AUSTRIA	NORWAY	ENGLAND	ITALY	Remarks
17- 1	458-27311-00	STAND, side	1	x	x	x							x	
17- 2	90102-10006	BOLT (278-27317-00)	1	x									x	
	90109-08438	BOLT, hexagon	1			x								
	90109-10399	BOLT, hexagon	1				x							
17- 3	90171-10012	NUT, castle	1	x		x							x	
	95301-08900	NUT, slotted	1			x								
17- 4	91401-20025	PIN, cotter	1	x	x	x							x	
17- 5	90507-29021	SPRING, tension	1	x									x	
	90507-29019	SPRING, tension	1			x	x							
17- 6	458-27315-00	LINK, side stand	1			x	x							
17- 7	90201-10146	WASHER, plate	1			x								
17- 8	90508-29308	SPRING, tension	1			x								
17- 9	90387-10537	COLLAR	1			x								
17-10	90201-08310	WASHER, plate	1			x								
17-11	460-27411-41	FOOTREST	1	x	x	x							x	
17-12	97301-10018	BOLT, hexagon	1	x	x	x							x	
17-13	92901-10100	WASHER, spring	1	x	x	x							x	
17-14	214-27421-00-33	FOOTREST	2	x	x	x							x	Yamaha Black
17-15	214-27413-00	COVER, footrest	2	x	x	x							x	
17-16	90508-20023	SPRING (214-27426-00)	2	x	x	x							x	
17-17	90243-08006	PIN (214-27418-00)	2	x	x	x							x	
17-18	90201-06042	WASHER (214-27417-00)	2	x	x	x							x	
17-19	97301-10018	BOLT, hexagon	1	x	x	x							x	
17-20	92901-10100	WASHER, spring	1	x	x	x							x	
17-21	248-27211-00-33	PEDAL, brake	1	x	x	x							x	Yamaha Black
17-22	90508-35070	SPRING (248-27216-00)	1	x	x	x							x	
17-23	90201-25289	WASHER (248-27226-00)	1	x	x	x							x	
17-24	91401-40035	PIN, cotter	1	x	x	x							x	

Fig. 17 STAND · FOOTREST · BRAKE PEDAL

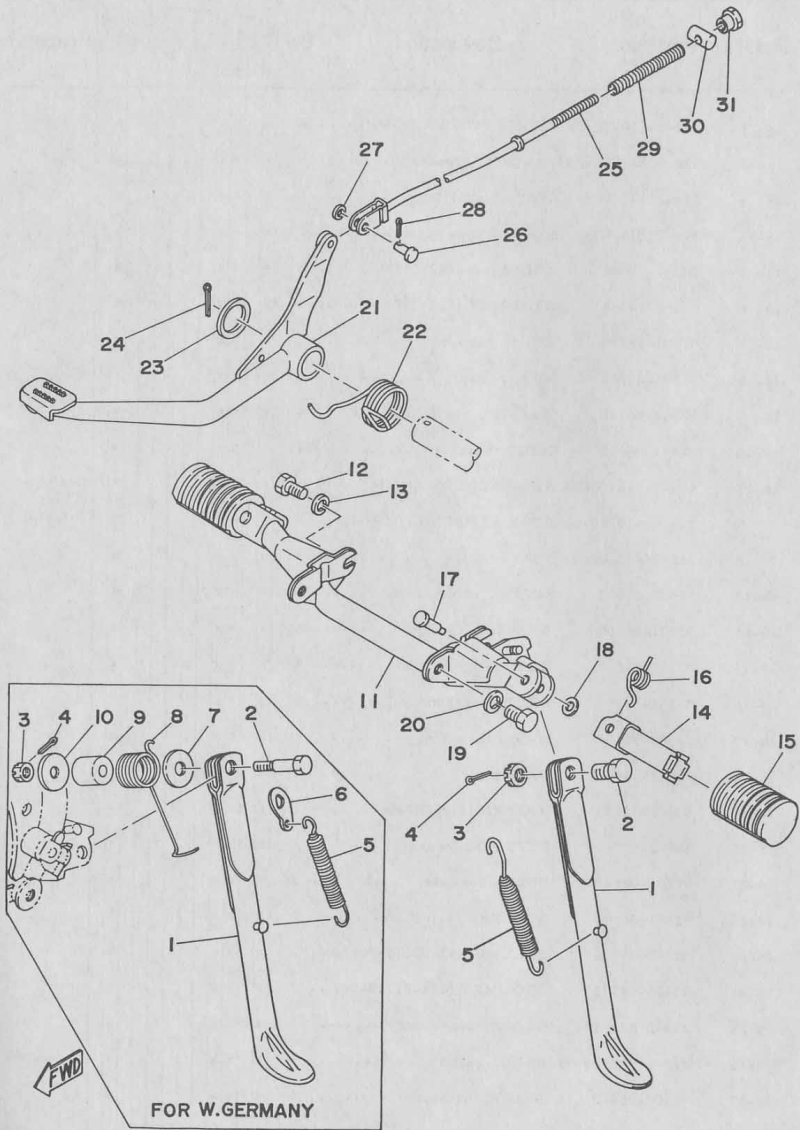

Ref. No.	Part No.	Description	Q'ty	FRANCE	HOLLAND	SWITZERLAND	W. GERMANY	GERMANY	BELEMEN	FINLAND	DENMARK	NORWAY	AUSTRIA	ITALY	Remarks
17-25	341-27231-00	ROD, brake	1	x	x	x								x	
17-26	90240-06006	PIN (248-27228-00)	1	x	x	x								x	
17-27	92901-06200	WASHER, plain	1	x	x	x								x	
17-28	91401-25012	PIN, cotter	1	x	x	x								x	
17-29	90501-10245	SPRING (180-27236-00)	1	x	x	x								x	
17-30	90249-12008	PIN (156-27237-00)	1	x	x	x								x	
17-31	90179-06176	NUT	1	x	x	x								x	

Fig. 18 FRONT FENDER · REAR FENDER

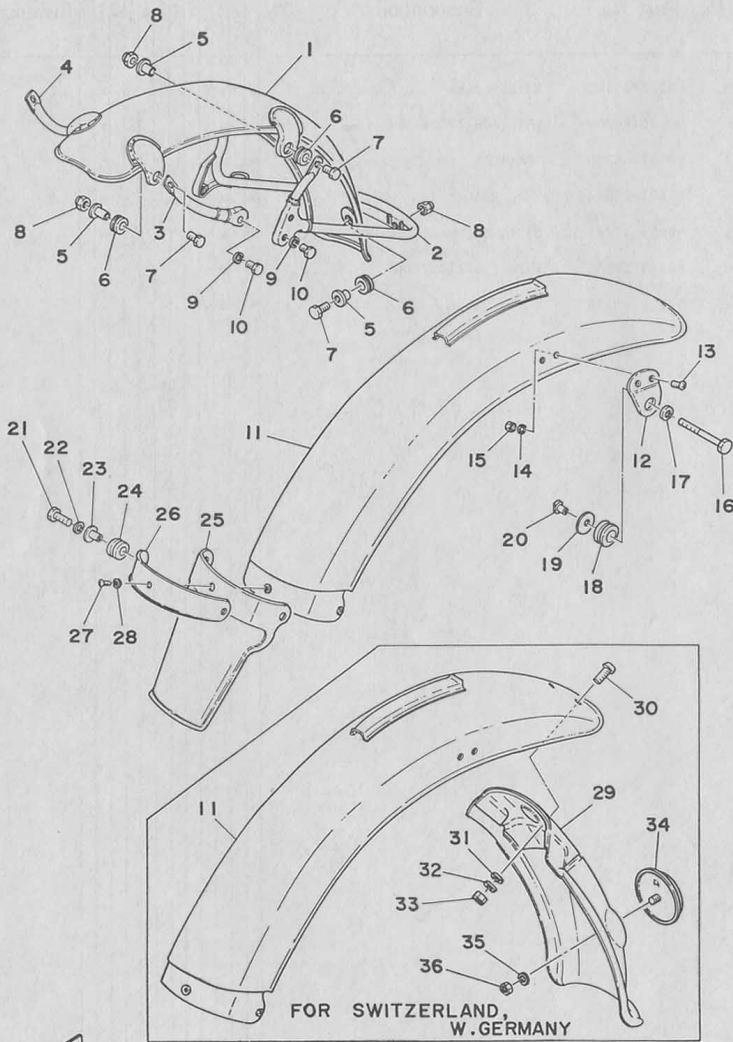

Ref. No.	Part No.	Description	Q'ty	FRANCE	HOLLAND	SWITZERLAND	WEST GERMANY	FINLAND	SWEDEN	DENMARK	NORWAY	AUSTRIA	ITALY	Remarks
18- 1	308-21510-00-36	FRONT FENDER COMP.	1	x	x								x	Clean White
18- 2	308-21512-00-93	BRACKET, fender	1	x	x								x	
18- 3	214-21513-00	STAY, fender left	1	x	x								x	
18- 4	214-21514-00	STAY, fender right	1	x	x								x	
18- 5	90387-07391	COLLAR (437-21633-00) ...	5	x	x								x	
18- 6	90480-14102	GROMMET (214-21717-00) ..	5	x	x								x	
18- 7	97301-06020	BOLT, hexagon	5	x	x								x	
18- 8	95301-06800	NUT, crown	5	x	x								x	
18- 9	92901-06100	WASHER, spring	4	x	x								x	
18-10	97301-06020	BOLT, hexagon	4	x	x								x	
18-11	444-21610-00-36	REAR FENDER COMP.	1	x									x	Clean White
	316-21610-40-36	REAR FENDER COMP.	1		x								x	Clean White
18-12	248-21613-00-91	STAY, fender	2	x	x								x	
18-13	92501-06012	SCREW, panhead	4	x	x								x	
18-14	92901-06100	WASHER, spring	4	x	x								x	
18-15	95301-06600	NUT, hexagon	4	x	x								x	
18-16	97303-08055	BOLT, hexagon	2	x	x								x	
18-17	92903-08100	WASHER, spring	2	x	x								x	
18-18	168-21638-00	DAMPER	2	x	x								x	
18-19	90201-12189	WASHER (122-24746-00) ...	1	x	x								x	
18-20	248-21635-00	NUT, rear fender	2	x	x								x	
18-21	97301-06025	BOLT, hexagon	2	x	x								x	
18-22	92901-06100	WASHER, spring	2	x	x								x	
18-23	90387-07391	COLLAR (437-21633-00) ...	2	x	x								x	
18-24	90480-14102	GROMMET (214-21717-00) ..	2	x	x								x	
18-25	248-21629-00	GUARD, mud front	1	x	x								x	
18-26	248-21622-00-33	BAND, guard	1	x	x								x	Yamaha Black
18-27	92501-06012	SCREW, panhead	1	x	x								x	

Fig. 18 FRONT FENDER · REAR FENDER

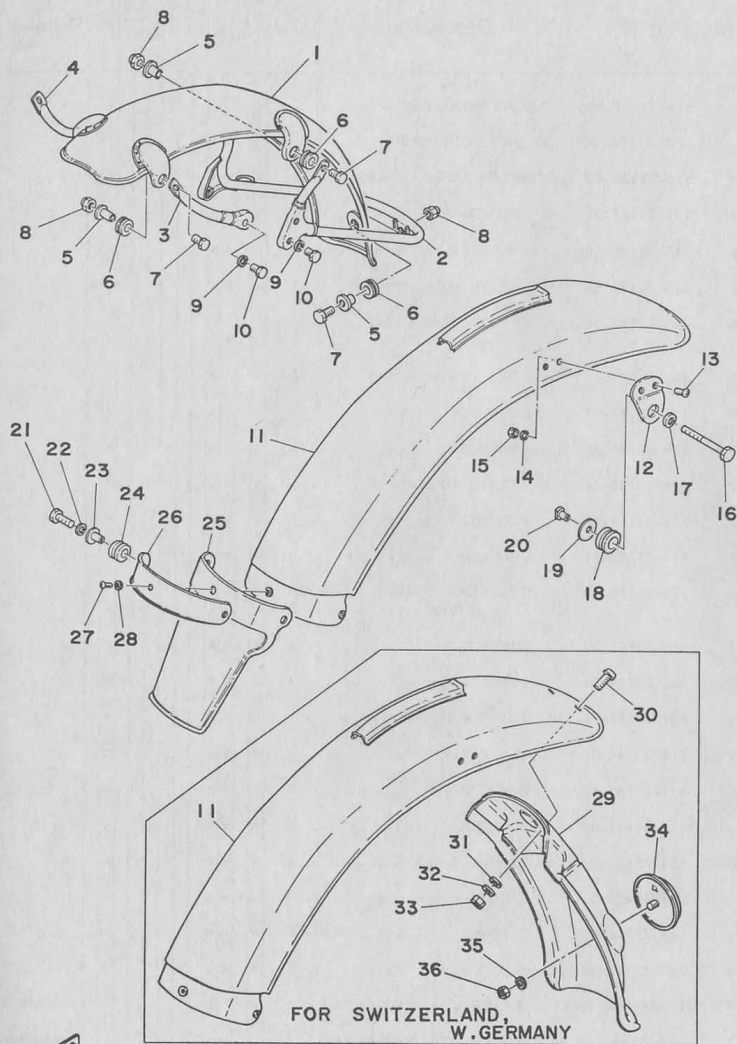

← FWD

Ref. No.	Part No.	Description	Q'ty	FRANCE	HOLLAND	SWITZERLAND W. GERMANY	SWEDEN	FINLAND	DENMARK	NORWAY	AUSTRIA	ITALY	Remarks
18-28	92901-06100	WASHER, spring	1	x		x	x					x	
18-29	316-21621-41-36	FLAP, rear fender	1			x	x						Clean White
18-30	92501-06020	SCREW, panhead	2			x	x						
18-31	92901-06600	WASHER, plate	2			x	x						
18-32	92901-06100	WASHER, spring	2			x	x						
18-33	95301-06600	NUT, hexagon	2			x	x						
18-34	848-85131-01	REFLECTOR	1			x	x						
18-35	92901-05100	WASHER, spring	1			x	x						
18-36	95301-05600	NUT, hexagon	1			x	x						

Fig. 19 FRONT FORK

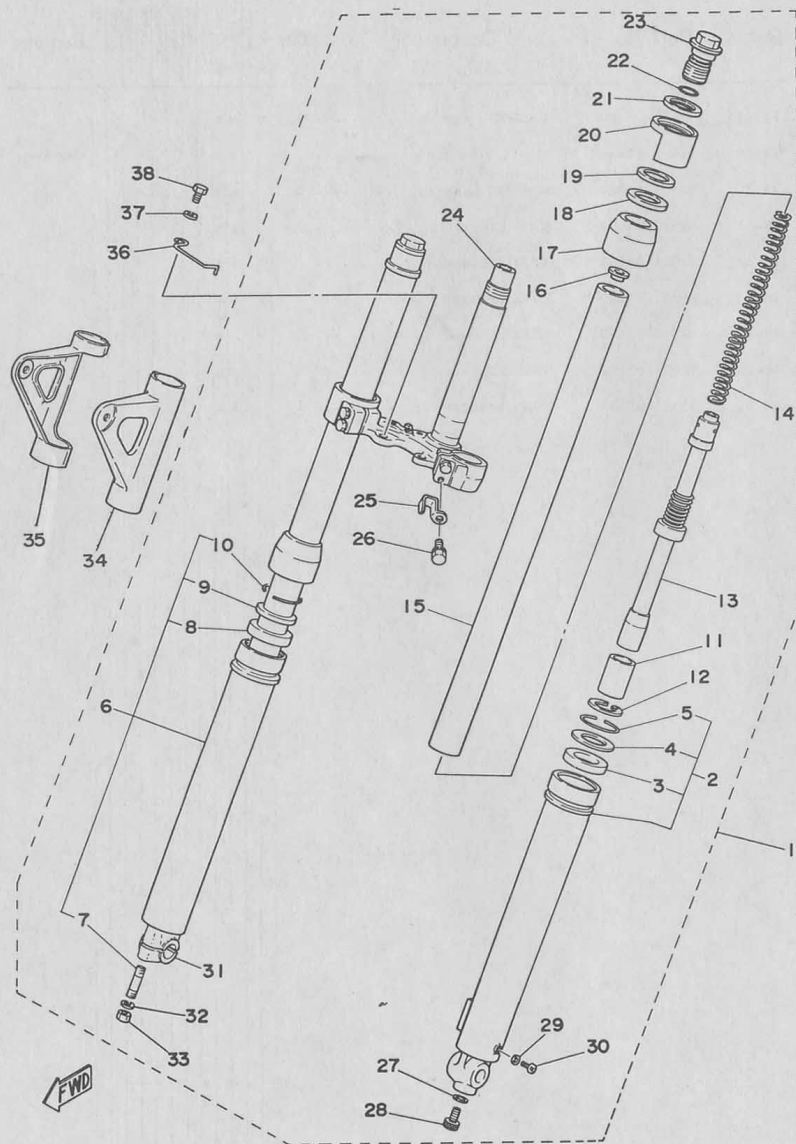

Ref. No.	Part No.	Description	Q'ty	FRANCE	HOLLAND	WEST GERMANY	GERMANY	FINLAND	DENMARK	NORWAY	AUSTRIA	ENGLAND	ITALY	Remarks
19- 1	576-23101-00	FRONT FORK ASS'Y	1	x		x						x		
	1G0-23101-40	FRONT FORK ASS'Y	1			x								
19- 2	315-23126-50	. OUTER TUBE COMP., left	1	x	x	x						x		
19- 3	137-23145-01	. . OIL SEAL	1	x	x	x						x		
19- 4	315-23146-50	. . WASHER, oil seal	1	x	x	x						x		
19- 5	315-23156-50	. . CLIP, oil seal	1	x	x	x						x		
19- 6	315-23136-50	. OUTER TUBE COMP., right	1	x	x	x						x		
19- 7	90116-08261	. . BOLT, axle holder	2	x	x	x						x		
19- 8	137-23145-01	. . OIL SEAL	1	x	x	x						x		
19- 9	315-23146-50	. . WASHER, oil seal	1	x	x	x						x		
19-10	315-23156-50	. . CLIP, oil seal	1	x	x	x						x		
19-11	535-23171-00	. PISTON, front fork	2	x	x	x						x		
19-12	535-23183-01	. CIRCLIP	2	x	x	x						x		
19-13	525-23170-00	. CYLINDER COMP., front fork	2	x	x	x						x		
19-14	559-23141-00	. SPRING, fork	2	x	x	x						x		
19-15	525-23124-00	. TUBE, inner	2	x	x	x						x		
19-16	437-23117-01	. SEAT, spring upper	2	x	x	x						x		
19-17	248-23144-00	. SEAL, dust	2	x	x	x						x		
19-18	437-23163-00	. PACKING	2	x	x	x						x		
19-19	437-23161-00	. WASHER	2	x	x	x						x		
19-20	304-23122-50	. COVER, outer	2	x	x	x						x		
19-21	248-23115-01	. GUIDE, cover upper	2	x	x	x						x		
19-22	146-23114-00	. O-RING	2	x	x	x						x		
19-23	248-23111-01	. BOLT, cap	2	x	x	x						x		
19-24	559-23340-00-33	. UNDER BRACKET COMP.	1	x		x						x		Yamaha Black
	1G0-23340-00-33	. UNDER BRACKET COMP.	1			x								Yamaha Black
19-25	214-23318-00	. HOLDER, wire	1	x	x	x						x		

Fig. 19 FRONT FORK

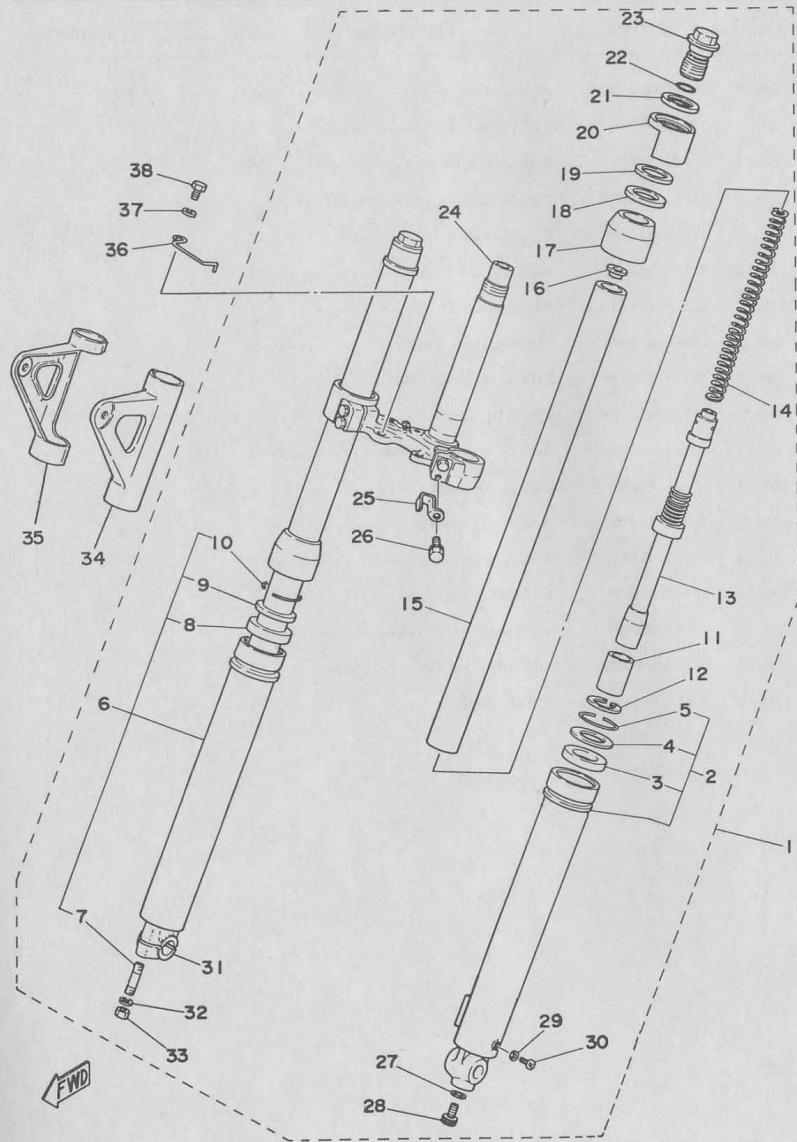

Ref. No.	Part No.	Description	Q'ty	FRANCE	HOLLAND	GERMANY	SWITZERLAND	BELEGIUM	FINLAND	DENMARK	NORWAY	AUSTRIA	ENGLAND	ITALY	Remarks
19-26	90119-08012	. BOLT, under bracket	4	x	x	x								x	
19-27	214-23158-00	. PACKING	2	x	x	x								x	
19-28	91311-08020	. BOLT, hexagon	2	x	x	x								x	
19-29	122-23129-00	. GASKET, drain plug	2	x	x	x								x	
19-30	122-23119-01	. PLUG, drain	2	x	x	x								x	
19-31	315-23167-51	. HOLDER	1	x	x	x								x	
19-32	92901-08100	. WASHER, spring	2	x	x	x								x	
19-33	90170-08176	. NUT, hexagon	2	x	x	x								x	
19-34	438-23121-00-33	COVER, upper left	1	x	x	x								x	Yamaha Black
19-35	438-23131-00-33	COVER, upper right	1	x	x	x								x	Yamaha Black
19-36	1G1-82594-00	CLAMP	1	x	x	x								x	
19-37	92901-06100	WASHER, spring	1	x	x	x								x	
19-38	97301-06010	BOLT, hexagon	1	x	x	x								x	

Fig.20 STEERING

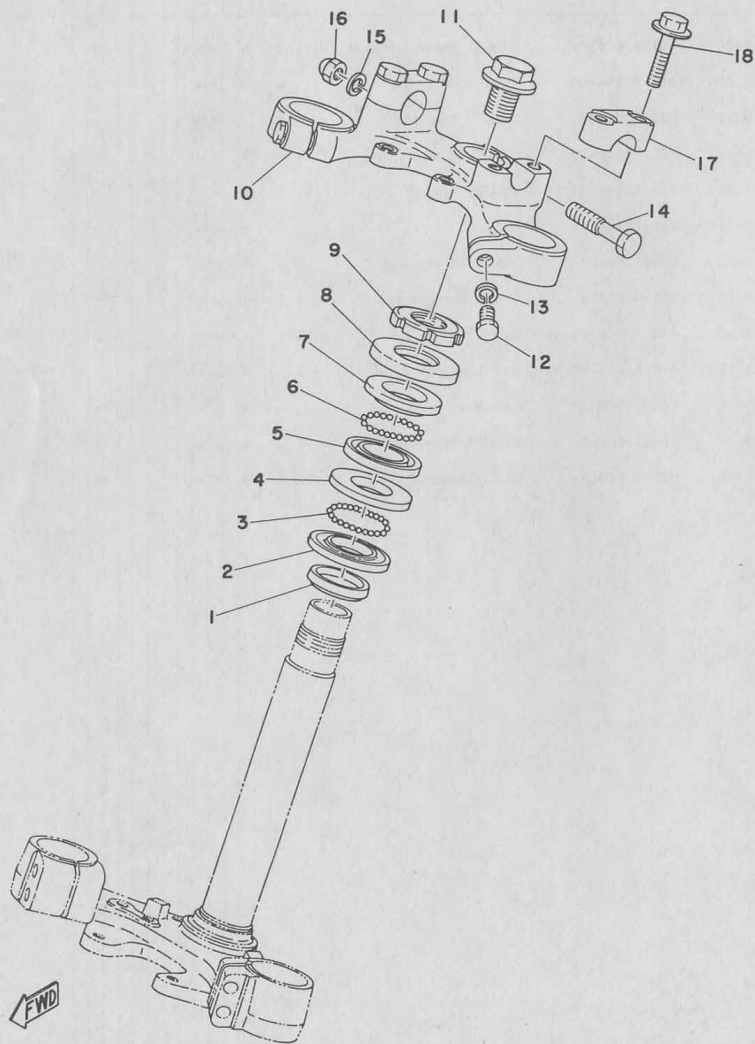

Ref. No.	Part No.	Description	Q'ty	Applicable Machine No.	Remarks
20- 1	164-23462-00	SEAL, dust	1		
20- 2	156-23411-00	RACE, ball 1	1		
20- 3	93501-04011	BALL (1/4 inch)	19		
20- 4	156-23412-00	RACE, ball 2	1		
20- 5	122-23412-00	RACE, ball 2	1		
20- 6	93503-16010	BALL (3/16 inch)	22		
20- 7	122-23411-00	RACE, ball 1	1		
20- 8	122-23416-00	COVER, ball race	1		
20- 9	90179-25033	NUT (137-23454-00)	1		
20-10	443-23435-00-33	CROWN, handle	1		Yamaha Black
20-11	90105-14060	BOLT, steering fitting	1		
20-12	97303-10030	BOLT, hexagon	2		
20-13	92901-10100	WASHER, spring	2		
20-14	97323-08045	BOLT, hexagon	1		
20-15	92901-08100	WASHER, spring	1		
20-16	95303-08800	NUT, crown	1		
20-17	1E6-23441-00	HOLDER, handle upper	2		
20-18	95821-08035	BOLT, flange	4		

Fig. 21 HANDLE · WIRE

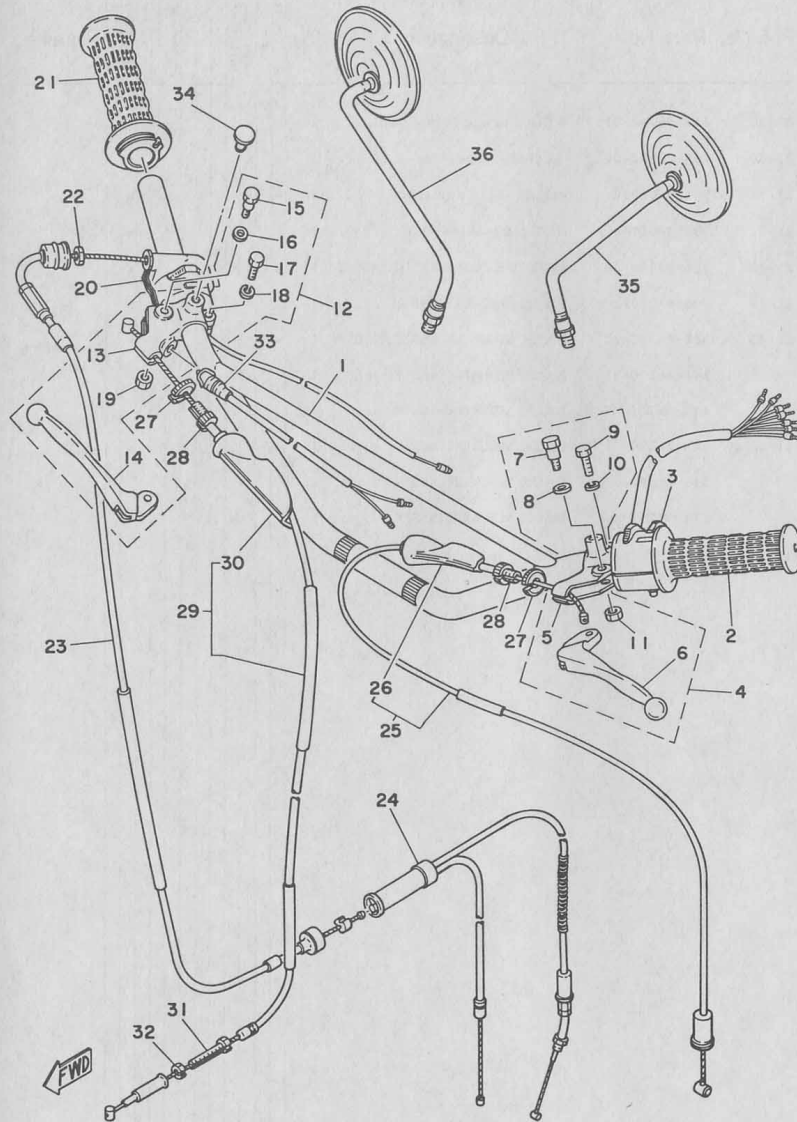

Ref. No.	Part No.	Description	Q'ty	FRANCE	HOLLAND	SWITZERLAND	GERMANY	SWEDEN	BELGIUM	FINLAND	DENMARK	NORWAY	AUSTRIA	ENGLAND	ITALY	Remarks
21- 1	558-26111-00	HANDLE	1	x	x	x									x	
21- 2	214-26241-20	GRIP, left	1	x	x	x									x	
21- 3	460-83972-42	SWITCH, handle 4	1	x	x	x									x	
21- 4	498-82910-11	LEVER HOLDER ASS'Y, left	1	x	x	x									x	
21- 5	498-82911-00	. HOLDER, lever left	1	x	x	x									x	
21- 6	214-83912-00	. LEVER, left	1	x	x	x									x	
21- 7	90109-06410	. BOLT	1	x	x	x									x	
21- 8	90201-08083	. WASHER (156-27226-00)...	1	x	x	x									x	
21- 9	97301-06022	. BOLT, hexagon	1	x	x	x									x	
21-10	92901-06100	. WASHER, spring	1	x	x	x									x	
21-11	95601-06100	. NUT U	1	x	x	x									x	
21-12	361-82920-93	LEVER HOLDER ASS'Y, right	1	x	x	x									x	
21-13	361-82921-31	. HOLDER, lever right	1	x	x	x									x	
21-14	233-83922-30	. LEVER, right	1	x	x	x									x	
21-15	90109-06410	. BOLT	1	x	x	x									x	
21-16	90201-08083	. WASHER (156-27226-00)...	1	x	x	x									x	
21-17	97301-06020	. BOLT, hexagon	1	x	x	x									x	
21-18	92901-06100	. WASHER, spring	1	x	x	x									x	
21-19	95601-06100	. NUT U	1	x	x	x									x	
21-20	444-83975-02	SWITCH, handle 2	1	x	x	x									x	
21-21	437-26240-20	GRIP ASS'Y	1	x	x	x									x	
21-22	90170-10038	NUT, hexagon	1	x	x	x									x	
21-23	443-26311-00	WIRE, throttle 1 (690mm) ..	1	x	x	x									x	
21-24	560-26312-00	WIRE, throttle 2 (215mm) ..	1	x	x	x									x	
21-25	444-26335-01	WIRE, clutch (1,075mm)	1	x	x	x									x	
21-26	382-26372-01	. COVER, lever	1	x	x	x									x	
21-27	90179-08148	NUT (168-26344-00)	2	x	x	x									x	
21-28	90123-08046	BOLT, wire adjusting	2	x	x	x									x	

Fig. 21 HANDLE · WIRE

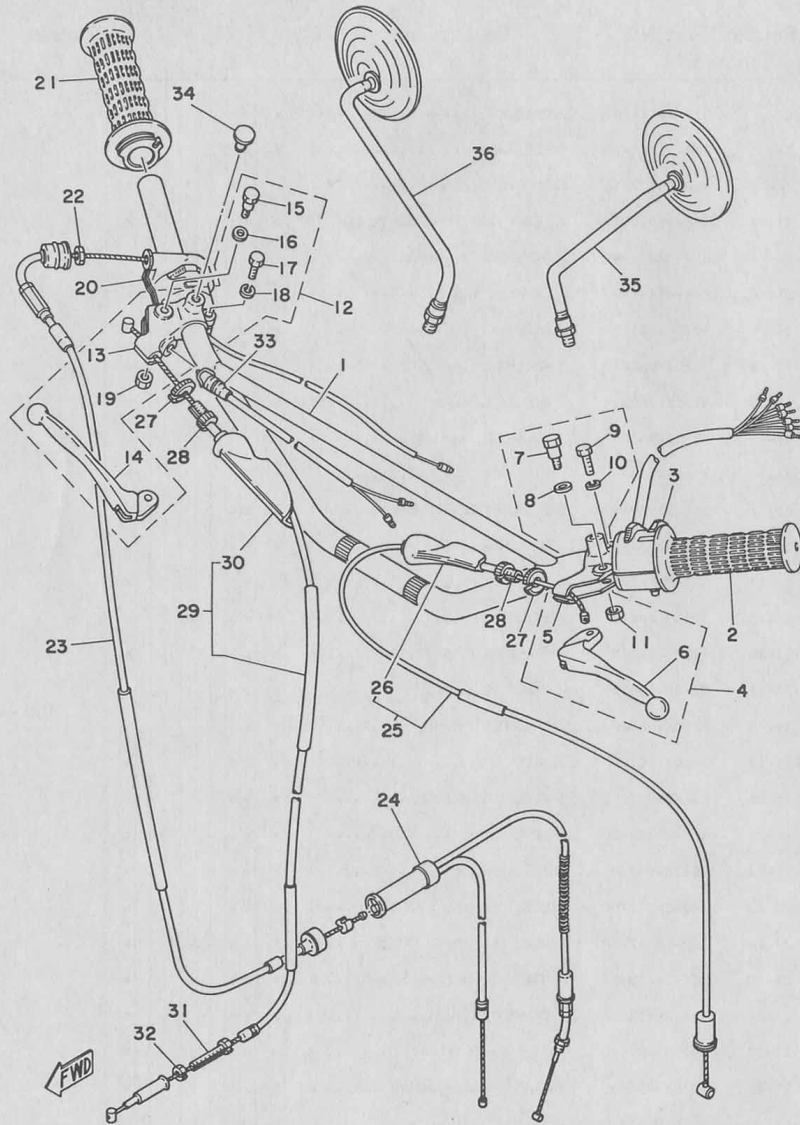

Ref. No.	Part No.	Description	Q'ty	FRANCE	ITALY	ENGLAND	AUSTRIA	NORWAY	DENMARK	FINLAND	SWEDEN	SWITZERLAND	NETHERLANDS	Remarks
21-29	443-26341-01	WIRE, brake (1,085mm)	1	x	x	x								
21-30	498-26372-00	. COVER, lever	1	x	x	x								
21-31	90123-06010	BOLT, wire adjusting	1	x	x	x								
21-32	90179-06143	NUT (109-26344-00)	1	x	x	x								
21-33	361-83980-30	FRONT STOP SWITCH ASS'Y	1	x	x	x								
21-34	90338-09012	PLUG (341-26329-00)	1	x	x	x								
21-35	341-26290-21	BACK MIRROR ASS'Y, left	1	x										England Optional Parts
	341-26290-51	BACK MIRROR ASS'Y, left	1		x									
	1Y1-26290-10	BACK MIRROR ASS'Y, left	1											
21-36	341-26290-71	BACK MIRROR ASS'Y, right	1	x										France Optional Parts
	341-26290-61	BACK MIRROR ASS'Y, right	1		x									
	1Y1-26290-00	BACK MIRROR ASS'Y, right	1											

Fig. 22 FUEL TANK

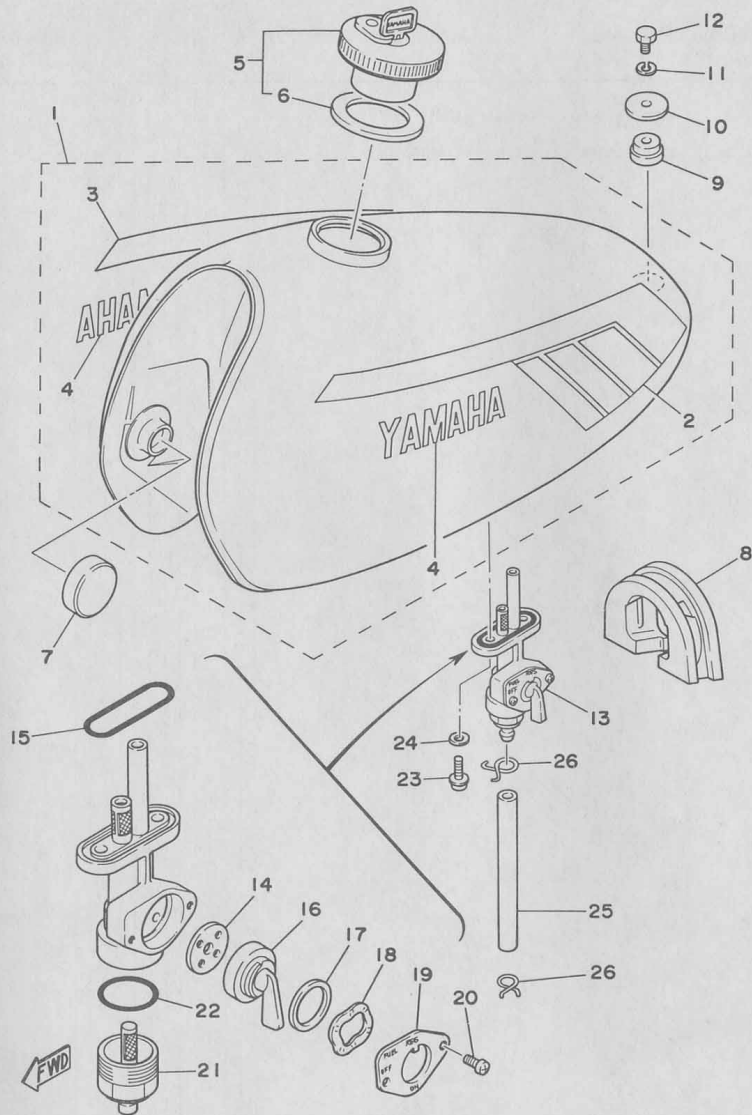

Ref. No.	Part No.	Description	Q'ty	FRANCE	HOLLAND	SWITZERLAND w/GERMANY	BEIGIUM	SWEDEN	FINLAND	DENMARK	NORWAY	AUSTRIA	IRELAND	ITALY	Remarks
22- 1	560-24100-00-X3	FUEL TANK COMP.	1	x	x	x								x	French Blue
	560-24110-00-X4	FUEL TANK COMP.	1	x	x	x								x	Yamaha Black
22- 2	1G0-24244-30	. GRAPHIC, fuel tank left	1	x	x	x								x	for French Blue
	1G0-24244-40	. GRAPHIC, fuel tank left	1	x	x	x								x	for Yamaha Black
22- 3	1G0-24245-30	. GRAPHIC, fuel tank right	1	x	x	x								x	for French Blue
	1G0-24245-40	. GRAPHIC, fuel tank right	1	x	x	x								x	for Yamaha Black
22- 4	1X0-24161-00	. EMBLEM, fuel tank	2	x	x	x								x	
22- 5	498-24602-03	CAP ASS'Y	1	x		x								x	
	127-24650-02	CAP ASS'Y	1			x									
22- 6	498-24612-00	. PACKING, cap	1	x		x								x	
22- 7	156-24181-00	DAMPER, locating	2	x	x	x								x	
22- 8	444-24183-00	DAMPER, locating 3	1	x	x	x								x	
22- 9	90480-25135	DAMPER (322-24182-00) ...	1	x	x	x								x	
22-10	90209-08098	WASHER (341-83348-00) ...	1	x	x	x								x	
22-11	92901-08100	WASHER, spring	1	x	x	x								x	
22-12	97301-08016	BOLT, hexagon	1	x	x	x								x	
22-13	558-24500-01	FUEL COCK ASS'Y	1	x	x	x								x	
22-14	498-24523-00	. PACKING, cock	1	x	x	x								x	
22-15	214-24512-00	. O-RING	1	x	x	x								x	
22-16	498-24524-01	. LEVER, cock	1	x	x	x								x	
22-17	498-24528-00	. WASHER, fuel cock	1	x	x	x								x	
22-18	90206-18025	. WASHER (137-24518-00) ..	1	x	x	x								x	
22-19	498-24525-00	. PLATE, lever fitting	2	x	x	x								x	
22-20	214-24535-00	. SCREW, lever fitting	1	x	x	x								x	
22-21	498-24521-00	. CUP, filter	1	x	x	x								x	
22-22	498-24522-00	. O-RING	1	x	x	x								x	
22-23	90149-06011	SCREW (256-24143-00)	2	x	x	x								x	
22-24	90202-06010	WASHER (176-14766-00)	2	x	x	x								x	

Fig. 22 FUEL TANK

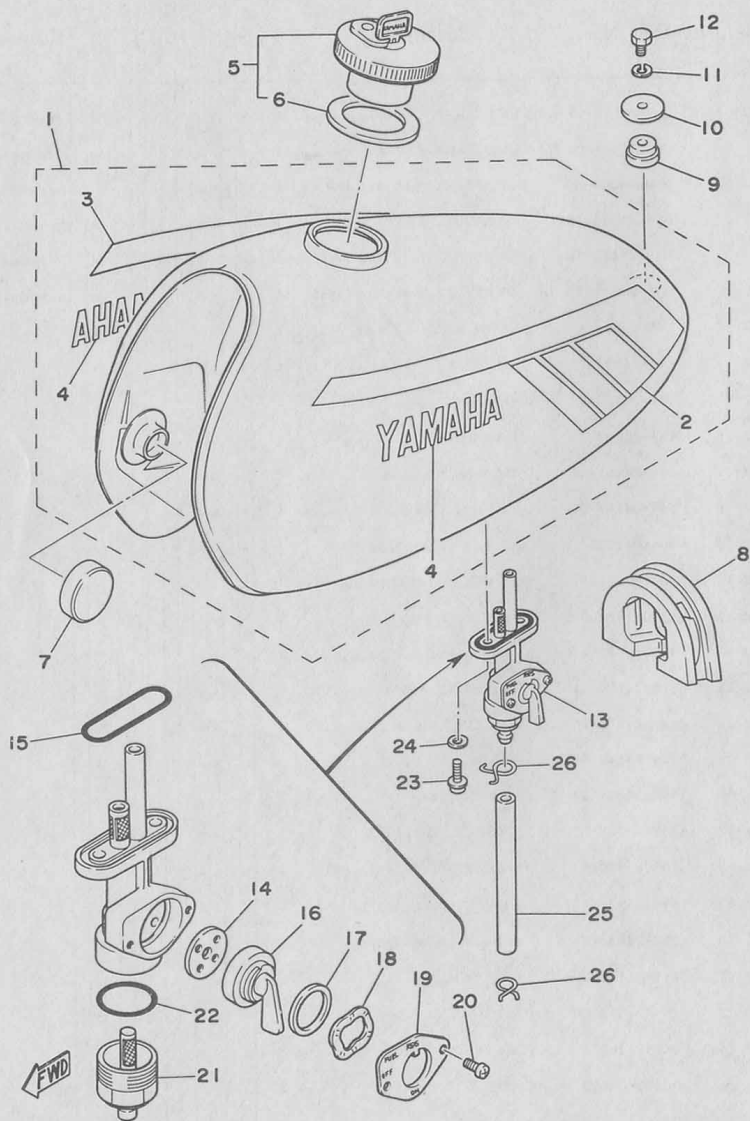

Ref. No.	Part No.	Description	Q'ty	HOLLAND	FRANCE	SWITZERLAND	WEST GERMANY	BELGIUM	FINLAND	DENMARK	NORWAY	AUSTRIA	ENGLAND	ITALY	Remarks
22-25	560-24311-00	HOSE (7-175)	1	x	x	x							x		
22-26	90467-10008	CLIP (143-24356-00)	2	x	x	x							x		

Fig. 23 OIL TANK

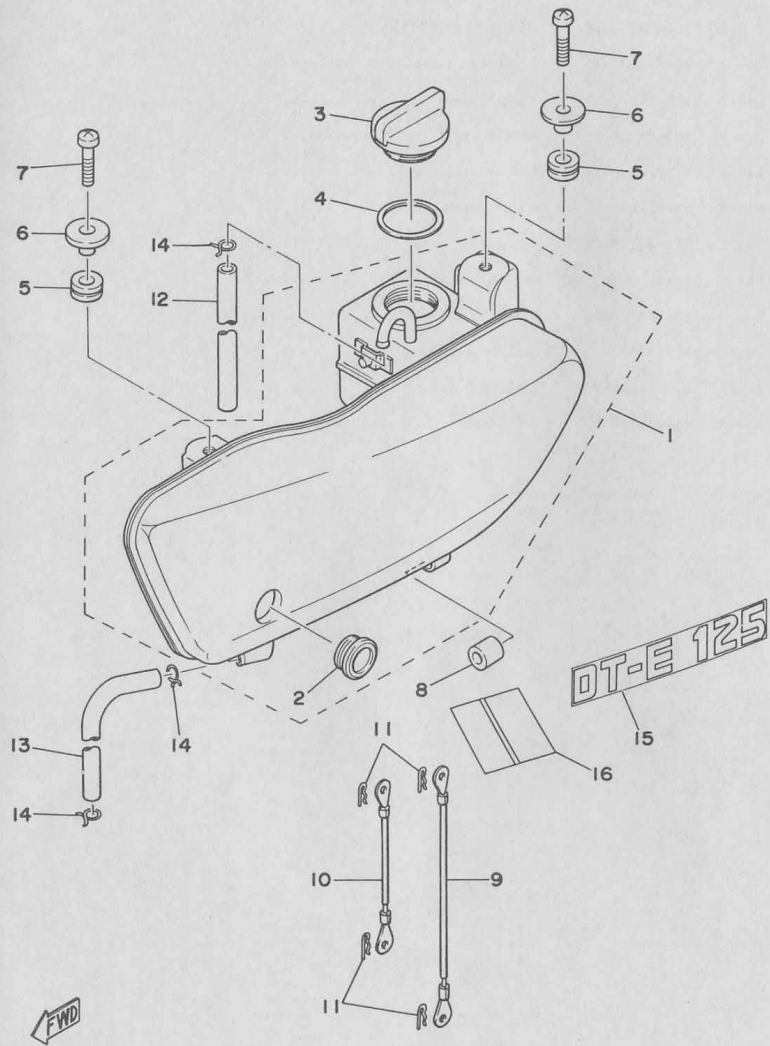

Ref. No.	Part No.	Description	Q'ty	Applicable Machine No.	Remarks
23- 1	560-21705-00-33	OIL TANK ASS'Y	1		Yamaha Black
	560-21705-00-G3	OIL TANK ASS'Y	1		French Blue
23- 2	360-21761-00	. GAUGE, level	1		
23- 3	1A0-21771-00	CAP, oil tank	1		
23- 4	90430-27124	GASKET, cap	1		
23- 5	90480-14102	GROMMET (214-21717-00)	2		
23- 6	90387-07391	COLLAR (437-21633-00)	2		
23- 7	90157-06029	SCREW, panhead special	2		
23- 8	437-21779-00	DAMPER, oil tank	1		
23- 9	248-21775-00	BAND, tank fitting	1		
23-10	261-21775-00	BAND, tank fitting	1		
23-11	90468-10050	CLIP (156-83525-00)	4		
23-12	90446-09012	HOSE (248-21745-00 5-390)	1		
23-13	90445-09110	HOSE (367-21766-00 5-420)	1		
23-14	90467-08003	CLIP (101-24356-00)	3		
23-15	1G0-21787-30	EMBLEM, oil tank 2	1		
23-16	1G0-21785-00	EMBLEM, oil tank 1	1		for French Blue
	1G0-21785-10	EMBLEM, oil tank 1	1		for Yamaha Black

Fig. 24 SEAT

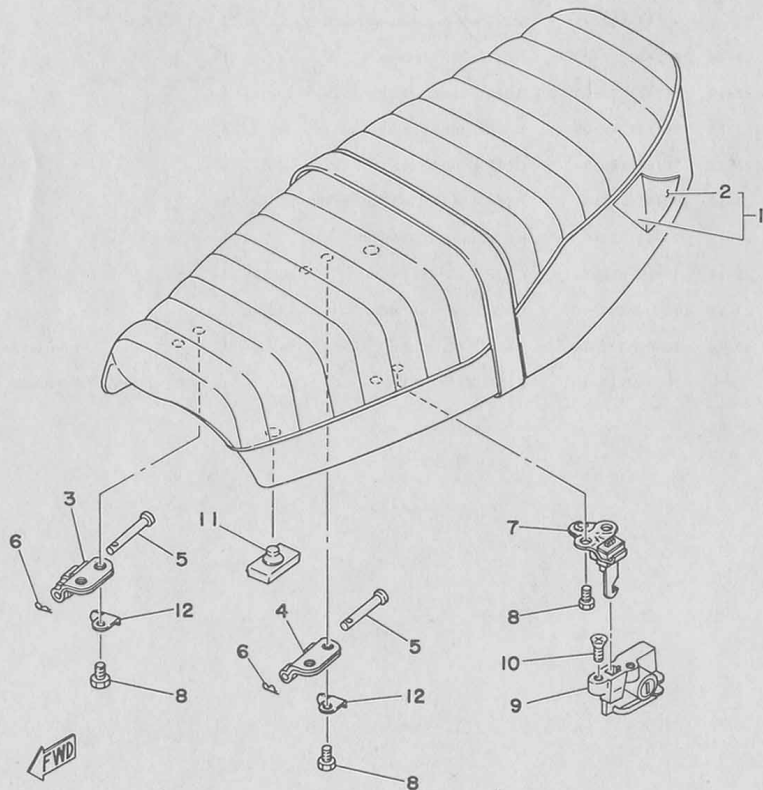

Ref. No.	Part No.	Description	Q'ty	Applicable Machine No.	Remarks
24- 1	1G0-24730-00	DOUBLE SEAT ASS'Y	1		
24- 2	1G0-24731-00	. COVER, double seat	1		
24- 3	315-24726-00	HINGE, seat	1		
24- 4	560-24726-00	HINGE, seat	1		
24- 5	91701-05055	PIN, clevis	2		
24- 6	90468-10050	CLIP (156-83525-00)	2		
24- 7	371-24728-01	BRACKET, seat	1		
24- 8	90101-06304	BOLT, hexagon	6		
24- 9	558-24705-00	SEAT LOCK ASS'Y	1		
24-10	92701-06012	SCREW, flathead	2		
24-11	214-24724-00	DAMPER, seat	3		
24-12	444-24768-00	STOPPER	2		

Fig. 25 FRONT WHEEL

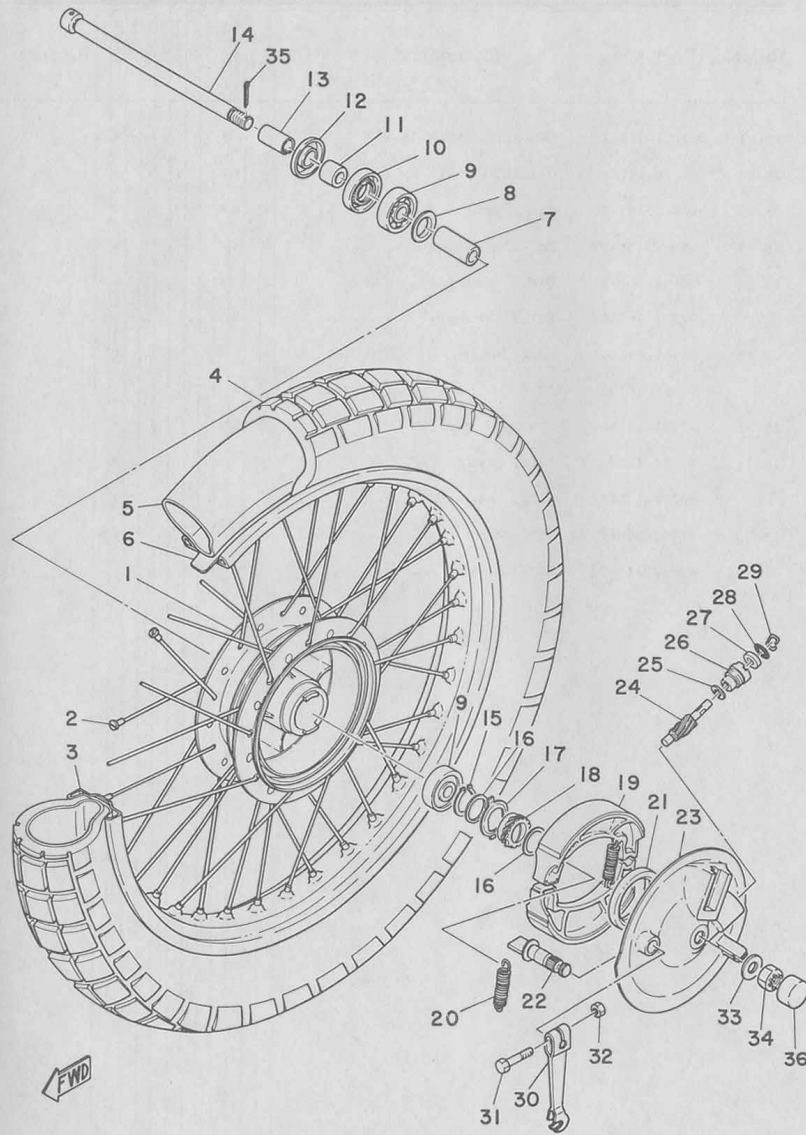

Ref. No.	Part No.	Description	Q'ty	FRANCE	HOLLAND	SWITZERLAND	WEST GERMANY	BELOW SWEDEN	FINLAND	DENMARK	NORWAY	AUSTRIA	ENGLAND	ITALY	Remarks
25- 1	443-25111-00	HUB, front	1	x	x	x								x	
25- 2	458-25104-00	SPOKE SET	1s	x	x	x								x	
25- 3	94416-21123	RIM, front (1.60A-21)	1	x		x								x	
	94418-21124	RIM, front (1.85A-21)	1			x									
25- 4	94127-21112	TIRE, front (2.75-21-4PR)	1	x	x	x	x	x	x	x	x	x	x	x	U.R
	94127-21178	TIRE, front (2.75-21-4PR)													
25- 5	94227-21031	TUBE, front (2.75-21)	1	x	x	x								x	
25- 6	94327-21024	BAND, rim (2.75-21)	1	x	x	x								x	
25- 7	90560-12138	SPACER (183-25117-00)	1	x	x	x								x	
25- 8	109-25315-00	FLANGE, spacer	1	x	x	x								x	
25- 9	93306-30103	BEARING (B6301Z)	2	x	x	x								x	
25-10	93102-18008	OIL SEAL (SD-18-37-8)	1	x	x	x								x	
25-11	90387-12095	COLLAR (183-25183-00)	1	x	x	x								x	
25-12	2K5-25118-00	COVER, hub dust	1	x	x	x								x	
25-13	90387-12100	COLLAR (315-25186-00)	1	x	x	x								x	
25-14	401-25181-01	SHAFT, wheel	1	x	x	x								x	
25-15	93410-20009	CIRCLIP (S-20)	1	x	x	x								x	
25-16	90201-20269	WASHER (183-25147-00)	2	x	x	x								x	
25-17	183-25149-00	CLUTCH, meter	1	x	x	x								x	
25-18	248-25135-10	GEAR, drive	1	x	x	x								x	
25-19	183-25330-01	BRAKE SHOE COMP.	2	x	x	x								x	
25-20	90506-16036	SPRING (183-25333-00)	2	x	x	x								x	
25-21	93105-47007	OIL SEAL (SD-47-58-7)	1	x	x	x								x	
25-22	248-25351-00	CAMSHAFT	1	x	x	x								x	
25-23	576-25121-00	PLATE, brake shoe	1	x	x	x								x	
25-24	248-25138-10	GEAR, meter	1	x	x	x								x	
25-25	90201-07076	WASHER (183-25146-00)	1	x	x	x								x	
25-26	109-25136-00	BUSHING	1	x	x	x								x	

Fig. 25 FRONT WHEEL

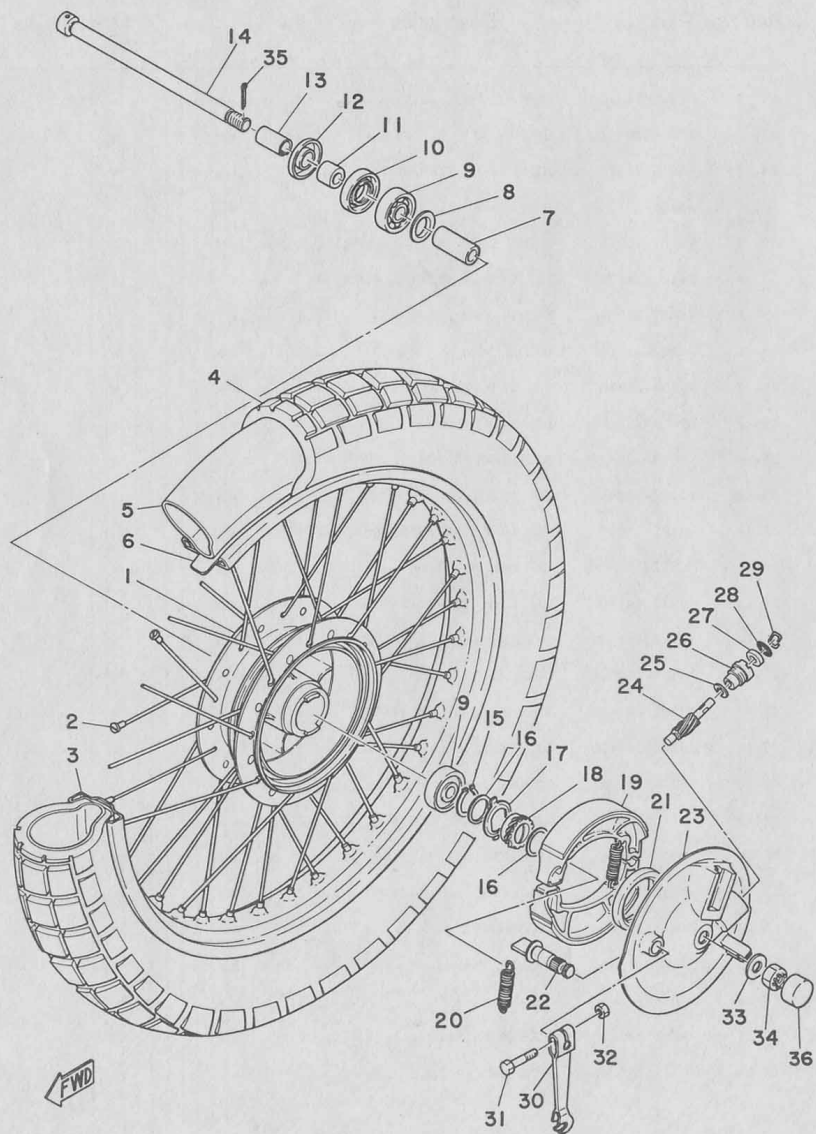

Ref. No.	Part No.	Description	Q'ty	FRANCE	HOLLAND	GERMANY	SWITZERLAND	BELOW	FINLAND	DENMARK	NORWAY	AUSTRIA	ITALY	Remarks
25-27	93104-07003	OIL SEAL (SO-7-14-4)	1	x	x	x							x	
25-28	93210-14104	O-RING (2.4-13.8)	1	x	x	x							x	
25-29	102-25137-00	RING, stop	1	x	x	x							x	
25-30	2N6-25155-00	LEVER, camshaft	1	x	x	x							x	
25-31	90101-06278	BOLT, hexagon	1	x		x							x	
	97301-06030	BOLT, hexagon	1			x								
25-32	95301-06600	NUT, hexagon	1	x		x							x	
	95601-06100	NUT U	1			x								
25-33	92901-12200	WASHER, plain	1	x	x	x							x	
25-34	90171-12005	NUT, castle	1	x		x							x	
	90171-12015	NUT, castle	1			x								
25-35	91401-30022	PIN, cotter	1	x	x	x							x	
25-36	478-25188-00	COVER, nut	1			x								

Fig. 26 REAR WHEEL

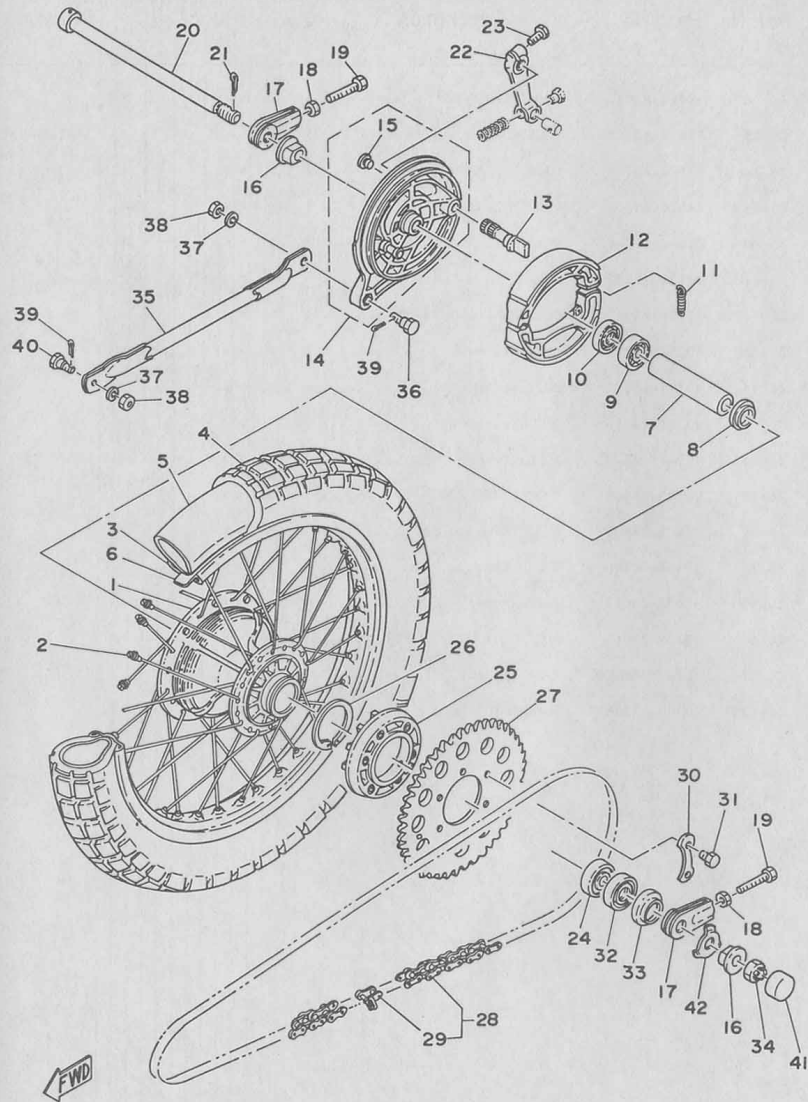

Ref. No.	Part No.	Description	Q'ty	FRANCE	HOLLAND	SWITZERLAND	W. GERMANY	BELGIUM	SWEDEN	DENMARK	NORWAY	AUSTRIA	ITALY	Remarks
26- 1	443-25311-00	HUB, rear	1	x	x	x							x	
26- 2	443-25304-00	SPOKE SET	1s	x		x							x	
	460-25304-00	SPOKE SET	1s			x								
26- 3	94418-18045	RIM, rear (1.85A-18)	1	x		x							x	
	94421-18081	RIM, rear (2.15A-18)	1			x								
26- 4	94132-18074	TIRE, rear (3.25-18-4PR)	1	x	x	x	x	x	x	x	x	x	x	U.R
	94132-18119	TIRE, rear (3.25-18-4PR)												
26- 5	94232-18020	TUBE, rear (3.25-18)	1	x	x	x							x	
26- 6	94325-18043	BAND, rim (2.55-18)	1	x	x	x							x	
26- 7	248-25317-00	SPACER, bearing	1	x	x	x							x	
26- 8	148-25115-00	FLANGE, spacer	1	x	x	x							x	
26- 9	93306-20204	BEARING (B6202Z)	1	x	x	x							x	
26-10	93106-26005	OIL SEAL (DD-26-42-8)	1	x	x	x							x	
26-11	90506-16036	SPRING (183-25333-00)	2	x	x	x							x	
26-12	183-25330-01	BRAKE SHOE COMP.	2	x	x	x							x	
26-13	248-25351-00	CAMSHAFT	1	x	x	x							x	
26-14	437-25320-10-38	BRAKE SHOE PLATE ASS'Y	1	x	x	x							x	
26-15	90480-10068	GROMMET	1	x	x	x							x	
26-16	90387-15115	COLLAR (248-25377-00)	2	x	x	x							x	
26-17	248-25388-00	PULLER, chain	2	x	x	x							x	
26-18	95301-08700	NUT, hexagon	2	x	x	x							x	
26-19	90101-08034	BOLT (168-25379-00)	2	x	x	x							x	
26-20	401-25381-00	SHAFT, wheel	1	x	x	x							x	
26-21	91401-30030	PIN, cotter	1	x	x	x							x	
26-22	214-25355-00	LEVER, camshaft	1	x	x	x							x	
26-23	97301-06025	BOLT, hexagon	1	x	x	x							x	
26-24	93306-30203	BEARING (B6302Z)	1	x	x	x							x	
26-25	248-25364-00	DAMPER, clutch	1	x	x	x							x	

Fig. 26 REAR WHEEL

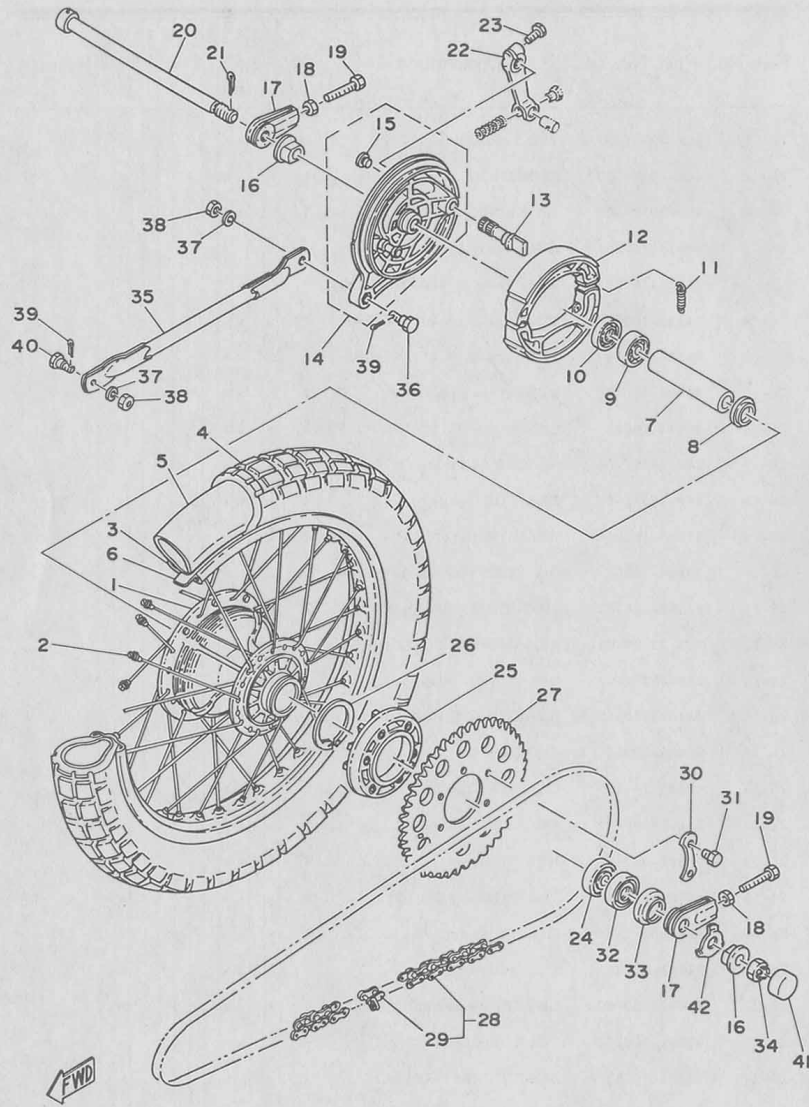

Ref. No.	Part No.	Description	Q'ty	FRANCE	HOLLAND	GERMANY	SPAIN	FINLAND	DENMARK	NORWAY	SWEDEN	IRELAND	ITALY	Remarks
26-26	93410-52034	CIRCLIP (S-52)	1	x	x	x							x	
26-27	248-25437-10-33	GEAR, sprocket wheel (37T)	1	x	x	x							x	Yamaha Black
26-28	94524-28110	CHAIN (DK428H-110L)	1	x	x	x							x	
26-29	94624-28001	JOINT, chain	1	x	x	x							x	
26-30	214-25412-00	WASHER, lock	3	x	x	x							x	
26-31	90101-08282	BOLT, hexagon	6	x	x	x							x	
26-32	93104-22018	OIL SEAL (SO-22-35-5)	1	x	x	x							x	
26-33	401-25367-00	COVER, dust	1	x	x	x							x	
26-34	90171-14020	NUT, castle	1	x	x								x	
	90171-14016	NUT, castle	1			x								
26-35	401-25371-01	BAR, tension	1	x	x	x							x	
26-36	90109-08063	BOLT (109-25373-00)	1	x	x	x							x	
26-37	92901-08100	WASHER, spring	2	x	x	x							x	
26-38	95301-08700	NUT, hexagon	2	x	x	x							x	
26-39	91401-20012	PIN, cotter	2	x	x	x							x	
26-40	90109-08368	BOLT (183-25378-00)	1	x	x	x							x	
26-41	521-25188-00	COVER, nut	1			x								
26-42	90209-14136	WASHER	1			x								

Fig. 27 HEAD LAMP 1

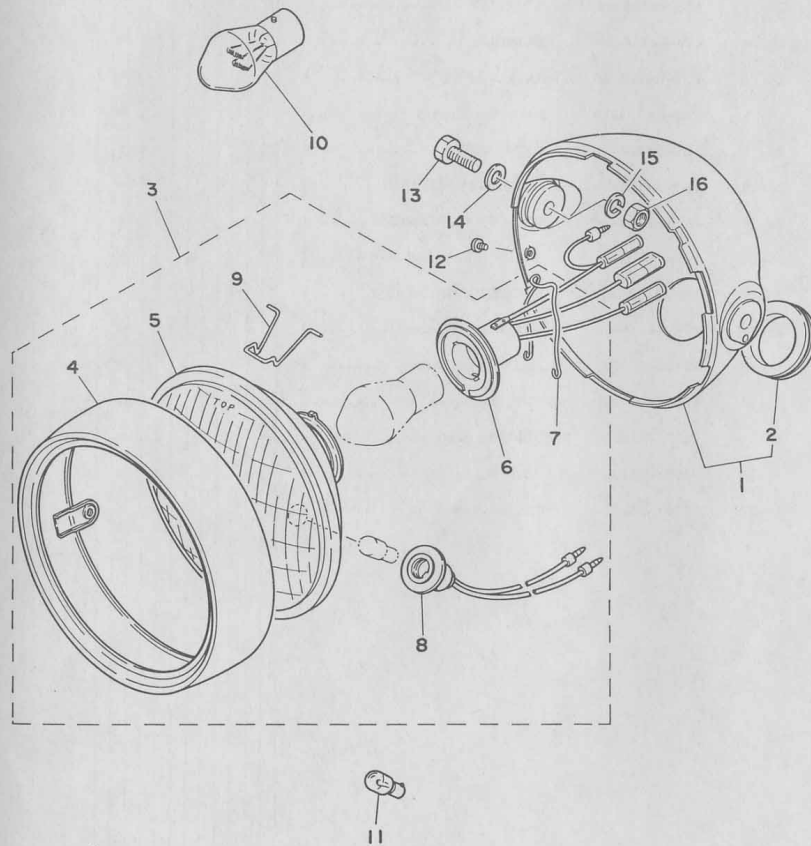

Ref. No.	Part No.	Description	Q'ty	FRANCE	HOLLAND	WEST GERMANY	SWITZERLAND	BELGIUM	SWEDEN	FINLAND	DENMARK	NORWAY	AUSTRIA	ENGLAND	ITALY	Remarks
27- 1	456-84130-41-33	HEAD LAMP BODY ASS'Y ...	1	x	x	x										Yamaha Black
27- 2	214-84153-60	. GROMMET	1	x	x	x										
27- 3	460-84303-20	HEAD LAMP UNIT ASS'Y ..	1	x												
	460-84303-40	HEAD LAMP UNIT ASS'Y ..	1				x									
	460-84303-45	HEAD LAMP UNIT ASS'Y ..	1				x									
27- 4	308-84115-21	. RIM, head lamp	1	x	x	x										
27- 5	307-84320-21	. LENS ASS'Y	1	x												
	460-84320-40	. LENS ASS'Y	1				x									
	460-84320-45	. LENS ASS'Y	1				x									
27- 6	314-84112-20	. SOCKET CORD ASS'Y ...	1	x												
	314-84112-10	. SOCKET CORD ASS'Y	1				x	x								
27- 7	308-84135-21	. SPRING	1	x	x	x										
27- 8	306-84346-40	. SOCKET CORD ASS'Y	1	x	x	x										
27- 9	308-84124-20	. SPRING, reflector set	4	x	x	x										
27-10	*	BULB (12V-36/36 W)	1	x												
	*	BULB (12V-35/35W)	1				x	x								
27-11	*	BULB, pilot (12V-4W)	1	x	x	x										
27-12	90152-05005	SCREW, rim fitting	1	x	x	x										
27-13	97304-08025	BOLT, hexagon	2	x	x	x										
27-14	92901-08200	WASHER, plain	2	x	x	x										
27-15	92901-08100	WASHER, spring	2	x	x	x										
27-16	95301-08600	NUT, hexagon	2	x	x	x										

*: The parts marked with * in the parts No. column are not supplied by Yamaha, those have to be found locally.

Fig. 28 HEAD LAMP 2 (ENGLAND)

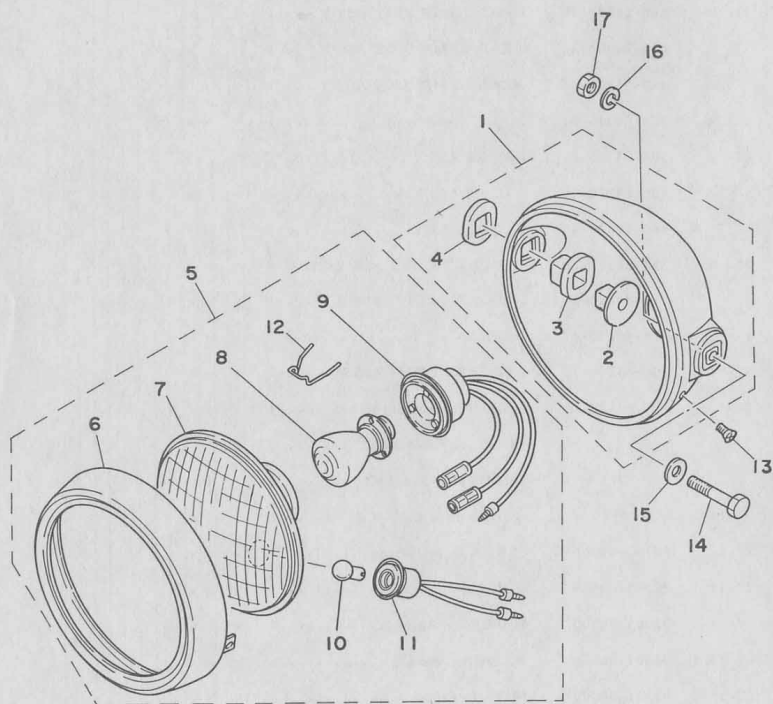

Ref. No.	Part No.	Description	Q'ty	ITALY	ENGLAND	AUSTRIA	NORWAY	DENMARK	FINLAND	SWEDEN	BELGIUM	NETHERLANDS	HOLLAND	FRANCE	Remarks
28- 1	498-84130-60-33	HEAD LAMP BODY ASS'Y ...	1		x										Yamaha Black
28- 2	498-84145-60	. COLLAR	2		x										
28- 3	498-84163-60	. BUSHING	2		x										
28- 4	498-84164-60	. BUSHING	2		x										
28- 5	1G0-84310-30	HEAD LAMP UNIT ASS'Y ...	1		x										
28- 6	1Y9-84115-30	. RIM, head lamp	1		x										
28- 7	1G0-84320-30	. LENS ASS'Y	1		x										
28- 8	1G0-84314-30	. BULB (12V-35/35W)	1		x										
28- 9	1R6-84112-30	. SOCKET CORD ASS'Y	1		x										
28-10	123-83516-21	. BULB, pilot (12V-3.4W) ..	1		x										
28-11	1R6-84146-30	. SOCKET CORD ASS'Y	1		x										
28-12	195-84324-00	. SPRING, reflector set	3		x										
28-13	90152-05005	SCREW, rim fitting	1		x										
28-14	97301-08040	BOLT, hexagon	2		x										
28-15	92901-08200	WASHER, plain	2		x										
28-16	92901-08100	WASHER, spring	2		x										
28-17	95301-08600	NUT, hexagon	2		x										

FWD

Fig. 29 SPEEDOMETER · TACHOMETER

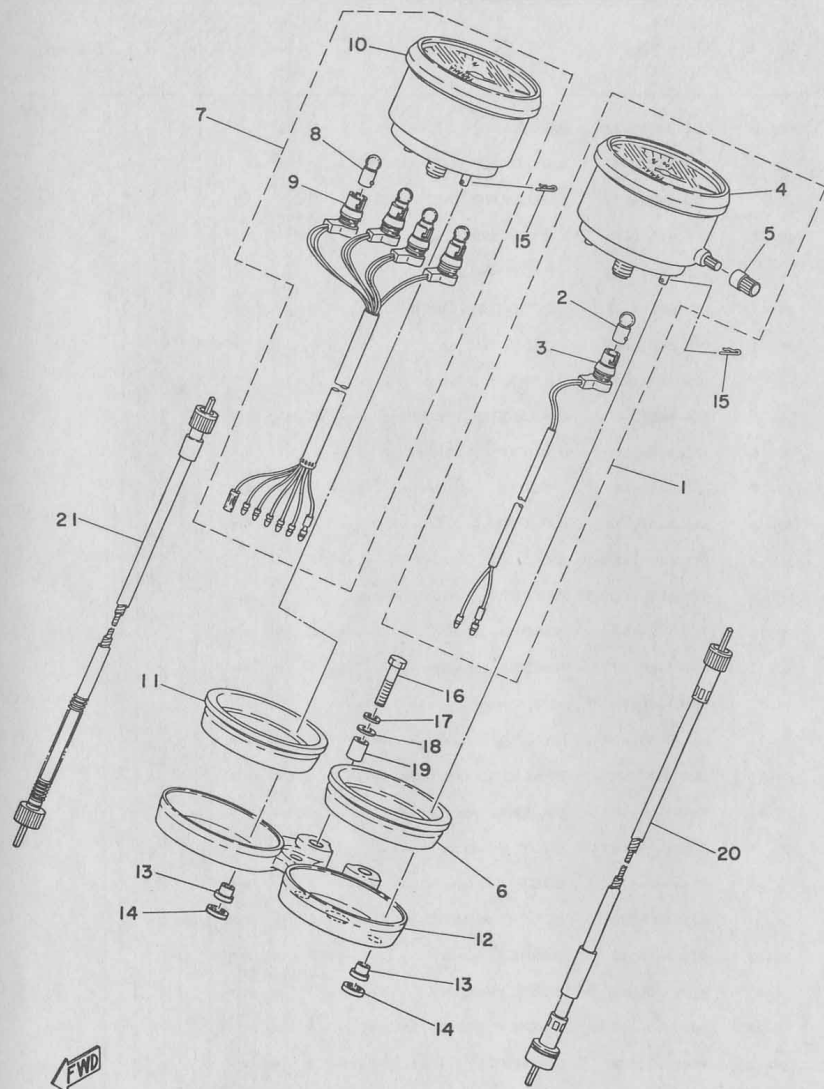

Ref. No.	Part No.	Description	Q'ty	Applicable Machine No.	Remarks
29- 1	444-83570-G0	SPEEDOMETER ASS'Y	1		Mile/h for England
	444-83570-40	SPEEDOMETER ASS'Y	1		Km/h
29- 2	123-83516-21	. BULB (12V-3.4W)	1		
29- 3	444-83536-00	. SOCKET, meter	1		
29- 4	437-83513-00	. DAMPER, meter	1		
29- 5	214-83578-30	. KNOB, trip meter	1		
29- 6	438-83526-01	DAMPER, meter	1		
29- 7	444-83540-F0	TACHOMETER ASS'Y	1		
	444-83540-01	TACHOMETER ASS'Y	1		for England
29- 8	123-83516-21	. BULB (12V-3.4W)	4		
29- 9	444-83520-00	. SOCKET, meter	1		
29-10	437-83513-00	. DAMPER, meter	1		
29-11	438-83526-01	DAMPER, meter	1		
29-12	438-83519-02-98	BRACKET, meter	1		Low Gloss Black
29-13	437-83523-00	DAMPER	4		
29-14	437-83524-00	WASHER, special	4		
29-15	437-83525-00	CLIP	4		
29-16	97301-06030	BOLT, hexagon	2		
29-17	92901-06100	WASHER, spring	2		
29-18	92901-06600	WASHER, plate	2		
29-19	90385-06001	BUSHING (214-83528-00)	2		
29-20	437-83550-01	SPEEDOMETER CABLE ASS'Y	1		
29-21	444-83560-01	TACHOMETER CABLE ASS'Y	1		

Fig. 30 TAIL LAMP 1

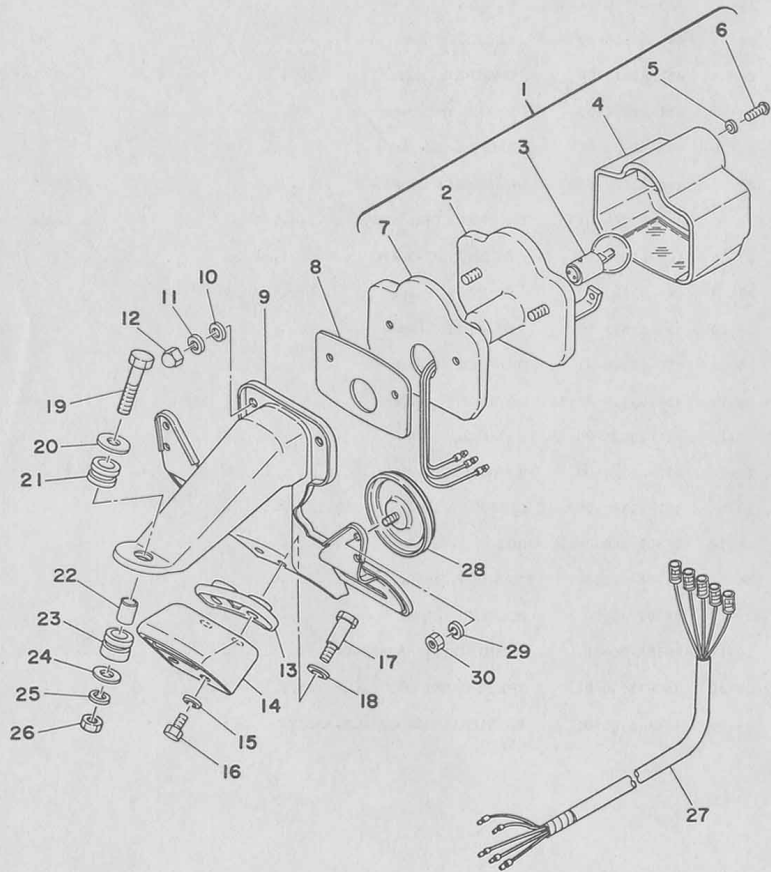

Ref. No.	Part No.	Description	Q'ty												Remarks				
				ENGLAND	ITALY	FRANCE	HOLLAND	SPAIN	SWITZERLAND	W. GERMANY	BRITAIN	GERMANY	AUSTRIA	NETHERLANDS					
30- 1	1G0-84710-20	TAIL LAMP UNIT ASS'Y ...	1	x															
	1G0-84710-41	TAIL LAMP UNIT ASS'Y ...	1		x														
	1G0-84710-70	TAIL LAMP UNIT ASS'Y ...	1			x													
30- 2	316-84711-70	. BASE, tail lamp	1	x		x													
	1G0-84711-41	. BASE, tail lamp	1			x													
30- 3	137-84714-61	. BULB (12V-21/5W)	1	x	x	x													
30- 4	308-84521-70	. LENS, tail lamp	1	x		x													
	308-84521-40	. LENS, tail lamp	1			x													
30- 5	124-84522-60	. WASHER, lens fitting	2	x	x	x													
30- 6	92503-06015	. SCREW, panhead	2	x	x	x													
30- 7	124-84516-60	. COVER, tail lamp	1	x	x	x													
30- 8	308-84547-40	DAMPER	1	x	x	x													
30- 9	512-84551-20-20	BRACKET, license	1	x															
	512-84551-40-20	BRACKET, license	1			x	x												
30-10	92901-06200	WASHER, plain	2	x	x	x													
30-11	92901-06100	WASHER, spring	2	x	x	x													
30-12	95301-06800	NUT, crown	2	x	x	x													
30-13	308-84553-00	DAMPER	1	x	x	x													
30-14	1G0-84519-40-36	BRACKET, tail lamp	1	x	x	x													Clean White
30-15	92901-06100	WASHER, spring	2	x	x	x													
30-16	97301-06010	BOLT, hexagon	2	x															
	97301-06018	BOLT, hexagon	2		x	x													
30-17	90109-06022	BOLT (338-84552-00)	2	x	x	x													
30-18	92901-08200	WASHER, plain	2	x	x	x													
30-19	97301-06040	BOLT, hexagon	1	x	x	x													
30-20	90209-06095	WASHER (102-28323-00)	1	x	x	x													
30-21	90480-14102	GROMMET (214-21717-00) ..	1	x	x	x													
30-22	90387-07039	COLLAR (275-84557-00)	1	x	x	x													
30-23	90480-14104	GROMMET (275-84559-00) ..	1	x	x	x													

FWD

Fig. 30 TAIL LAMP 1

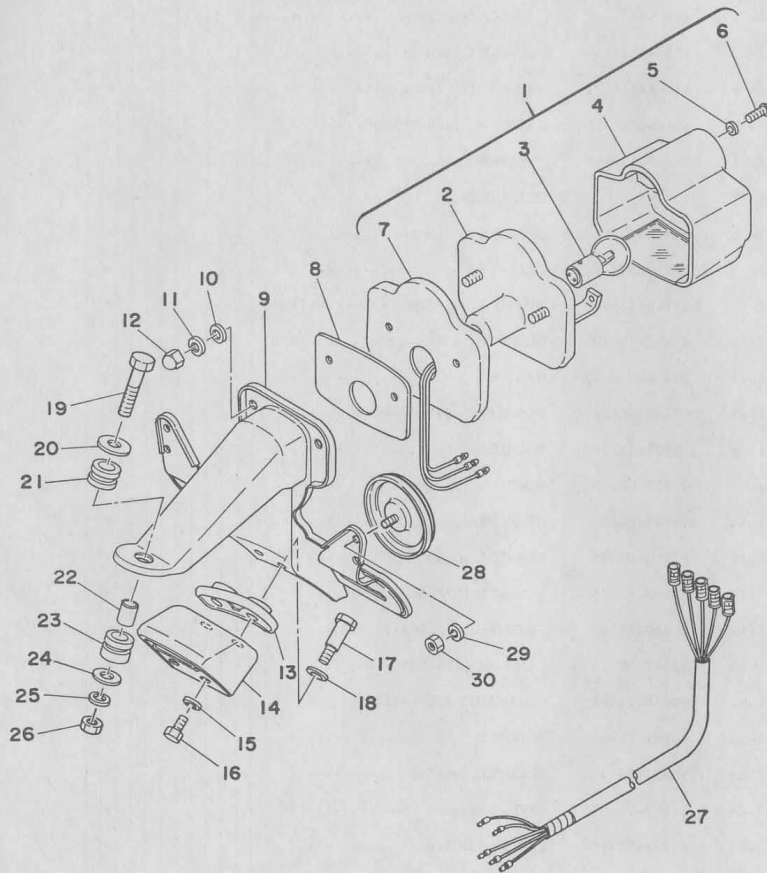

Ref. No.	Part No.	Description	Q'ty	FRANCE	HOLLAND	ITALY	ENGLAND	AUSTRIA	NORWAY	DENMARK	FINLAND	SWEDEN	BELGIUM	SWITZERLAND	W. GERMANY	Remarks	
30-24	90201-06067	WASHER	1	x	x	x											
30-25	92901-06100	WASHER, spring	1	x	x	x											
30-26	95301-06600	NUT, hexagon	1	x	x	x											
30-27	437-84517-00	CORD, tail lamp	1	x													
	308-84517-40	CORD, tail lamp	1										x	x			
30-28	1M1-85131-10	REFLECTOR	2	x													
30-29	92901-05100	WASHER, spring	2	x													
30-30	95301-05600	NUT, hexagon	2	x													

Fig. 31 TAIL LAMP 2 (ENGLAND)

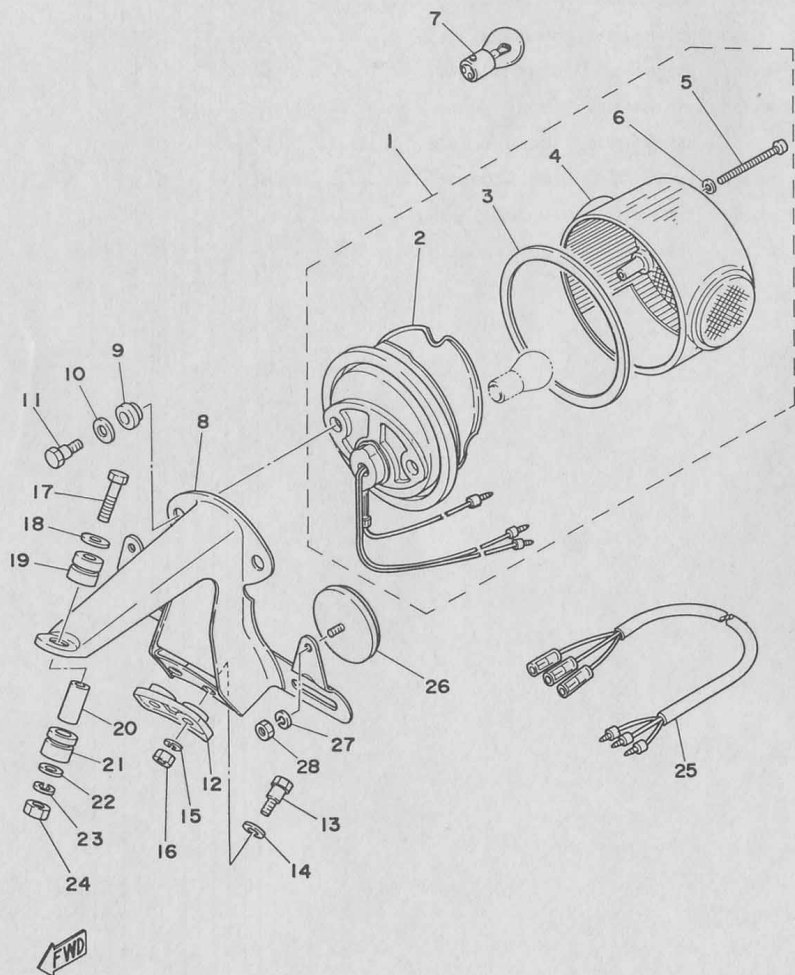

Ref. No.	Part No.	Description	Q'ty												Remarks				
				ITALY	ENGLAND	AUSTRIA	NORWAY	DENMARK	FINLAND	SWEDEN	BELGIUM	SWITZERLAND	W. GERMANY	HOLLAND		FRANCE			
31- 1	460-84710-21	TAIL LAMP UNIT ASS'Y	1															x	
31- 2	444-84711-61	. BASE, tail lamp	1															x	
31- 3	275-84523-60	. GASKET, tail lamp	1															x	
31- 4	456-84521-22	. LENS, tail lamp	1															x	
31- 5	341-84724-60	. SCREW, lens fitting	3															x	
31- 6	341-84722-60	. WASHER	3															x	
31- 7	*	BULB (12V-21/5W)	1															x	
31- 8	444-84751-60-20	BRACKET, license	1															x	
31- 9	275-84527-60	DAMPER	2															x	
31-10	437-84525-60	WASHER, special	2															x	
31-11	479-84526-00	BOLT	2															x	
31-12	308-84553-00	DAMPER	1															x	
31-13	90109-06022	BOLT (338-84552-00)	2															x	
31-14	92901-08200	WASHER, plain	2															x	
31-15	92901-06100	WASHER, spring	2															x	
31-16	95301-06600	NUT, hexagon	2															x	
31-17	97301-06040	BOLT, hexagon	1															x	
31-18	90209-06095	WASHER (102-28323-00)	1															x	
31-19	90480-14102	GROMMET (214-21717-00)	1															x	
31-20	90387-07039	COLLAR (275-84557-00)	1															x	
31-21	90480-14104	GROMMET (275-84559-00)	1															x	
31-22	90201-06067	WASHER	1															x	
31-23	92901-06100	WASHER, spring	1															x	
31-24	95301-06600	NUT, hexagon	1															x	
31-25	437-84517-00	CORD, tail lamp	1															x	
31-26	449-85131-01	REFLECTOR	2															x	
31-27	92903-05100	WASHER, spring	2															x	
31-28	95303-05600	NUT	2															x	

*: The parts marked with * in the parts No. column are not supplied with by Yamaha, those have to be found locally.

Fig. 32 FLASHER LAMP 1

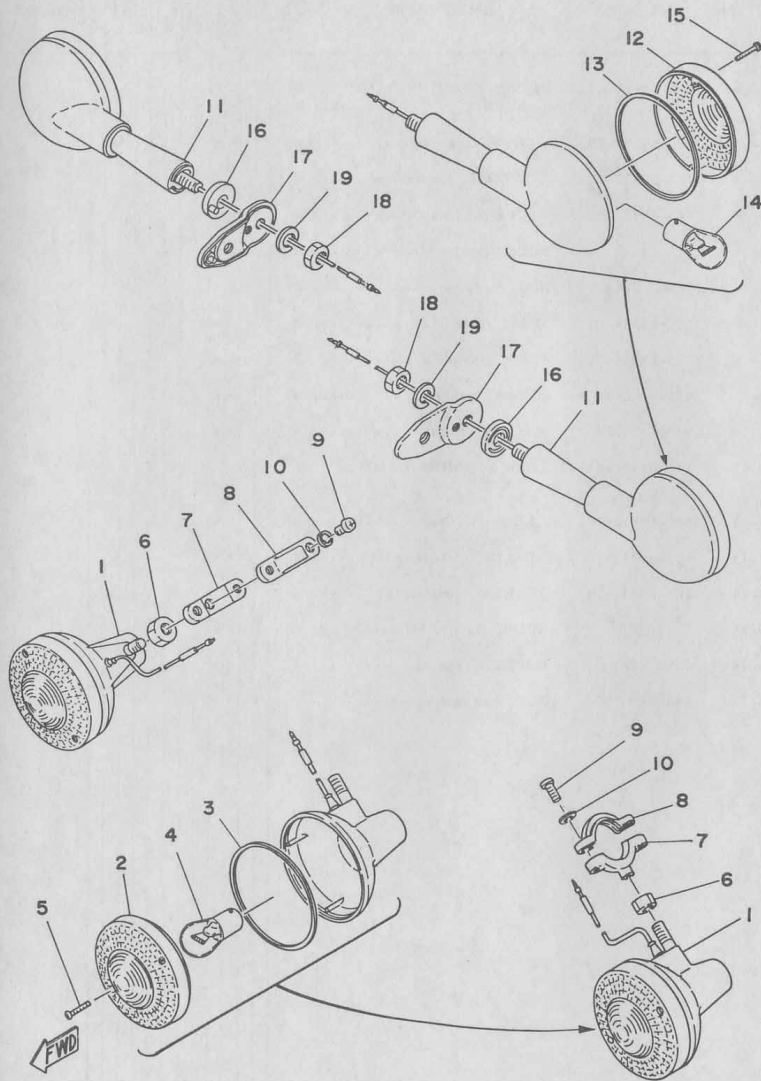

Ref. No.	Part No.	Description	Qty	FRANCE	HOLLAND	ITALY	ENGLAND	AUSTRIA	NORWAY	DENMARK	FINLAND	SWEDEN	BEIJING	SWITZERLAND	W. GERMANY	Remarks
32- 1	444-83310-72-93	FRONT FLASHER LAMP ASS'Y	2	x												x
32- 2	341-83312-70	. LENS, flasher	2	x												x
32- 3	341-83313-70	. PACKING, lens	2	x												x
32- 4	256-83311-70	. BULB (12V-27W)	2	x												x
32- 5	341-83333-70	. SCREW, lens fitting	4	x												x
32- 6	95301-08600	NUT, hexagon	2	x												x
32- 7	437-83328-01	STAY, flasher 2	2	x												x
32- 8	275-83318-00	STAY, flasher 1	2	x												x
32- 9	92503-06015	SCREW, panhead	4	x												x
32-10	92901-06300	WASHER, tooth	4	x												x
32-11	444-83330-41-93	REAR FLASHER LAMP ASS'Y	2	x												x
32-12	341-83312-70	. LENS, flasher	2	x												x
32-13	341-83313-70	. PACKING, lens	2	x												x
32-14	256-83311-70	. BULB (12V-27W)	2	x												x
32-15	341-83333-70	. SCREW, lens fitting	4	x												x
32-16	437-83326-00	COLLAR, flasher	2	x												x
32-17	437-83368-02	STAY, flasher 3	2	x												x
32-18	95301-08600	NUT, hexagon	2	x												x
32-19	92901-08100	WASHER, spring	2	x												x

Fig. 33 FLASHER LAMP 2

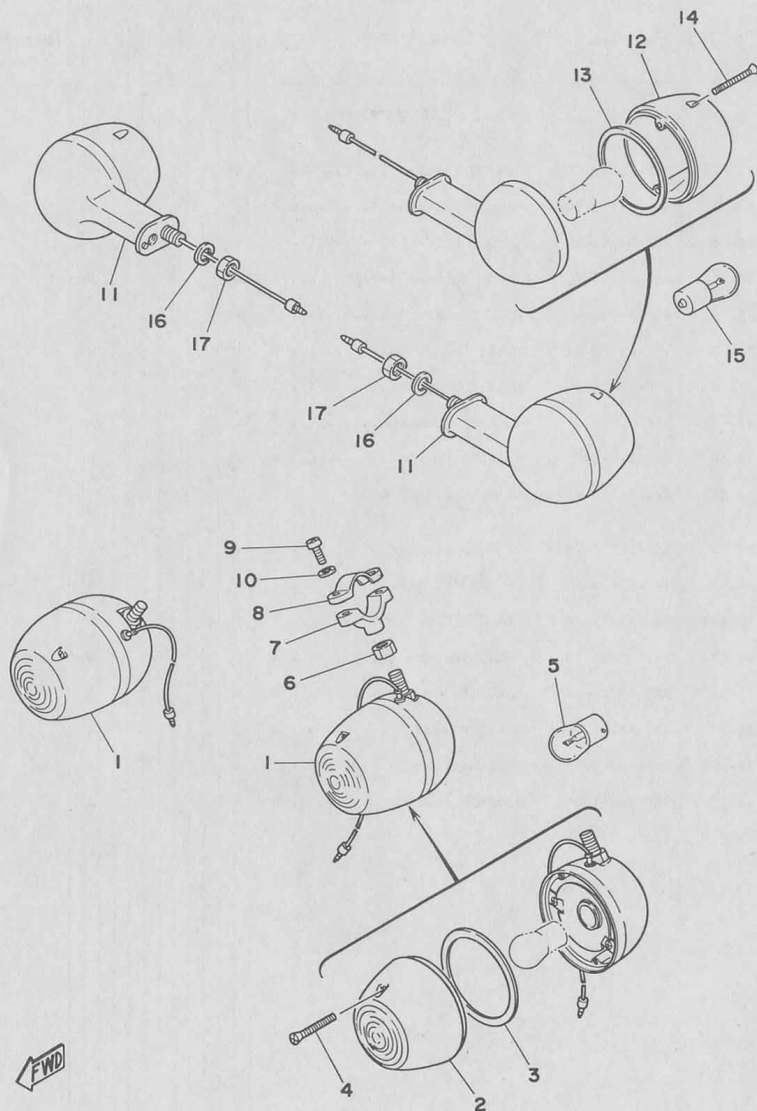

Ref. No.	Part No.	Description	Q'ty	FRANCE	GERMANY	NETHERLANDS	SPAIN	SWITZERLAND	UNITED KINGDOM	IRELAND	ITALY	REMARKS
33- 1	316-83310-41-93	FRONT FLASHER LAMP ASS'Y	2									
33- 2	183-83312-70	. LENS, flasher	2									
33- 3	183-83313-70	. GASKET, flasher lens	2									
33- 4	183-83333-71	. SCREW, lens fitting	4									
33- 5	*	BULB, flasher (12V-21W) ...	2									
33- 6	95301-08600	NUT, hexagon	2									
33- 7	437-83328-01	STAY, flasher 2	2									
33- 8	275-83318-00	STAY, flasher 1	2									
33- 9	92503-06015	SCREW, panhead	4									
33-10	92901-06300	WASHER, tooth	4									
33-11	316-83330-41-93	REAR FLASHER LAMP ASS'Y	2									
33-12	183-83312-70	. LENS, flasher	2									
33-13	183-83313-70	. GASKET, flasher lens	2									
33-14	183-83333-71	. SCREW, lens fitting	4									
33-15	*	BULB, flasher (12V-21W) ...	2									
33-16	92901-08100	WASHER, spring	2									
33-17	95301-08600	NUT, hexagon	2									

*: The parts marked with * in the parts No. column are not supplied with by Yamaha, those have to be found locally.

Fig. 34 ELECTRICAL

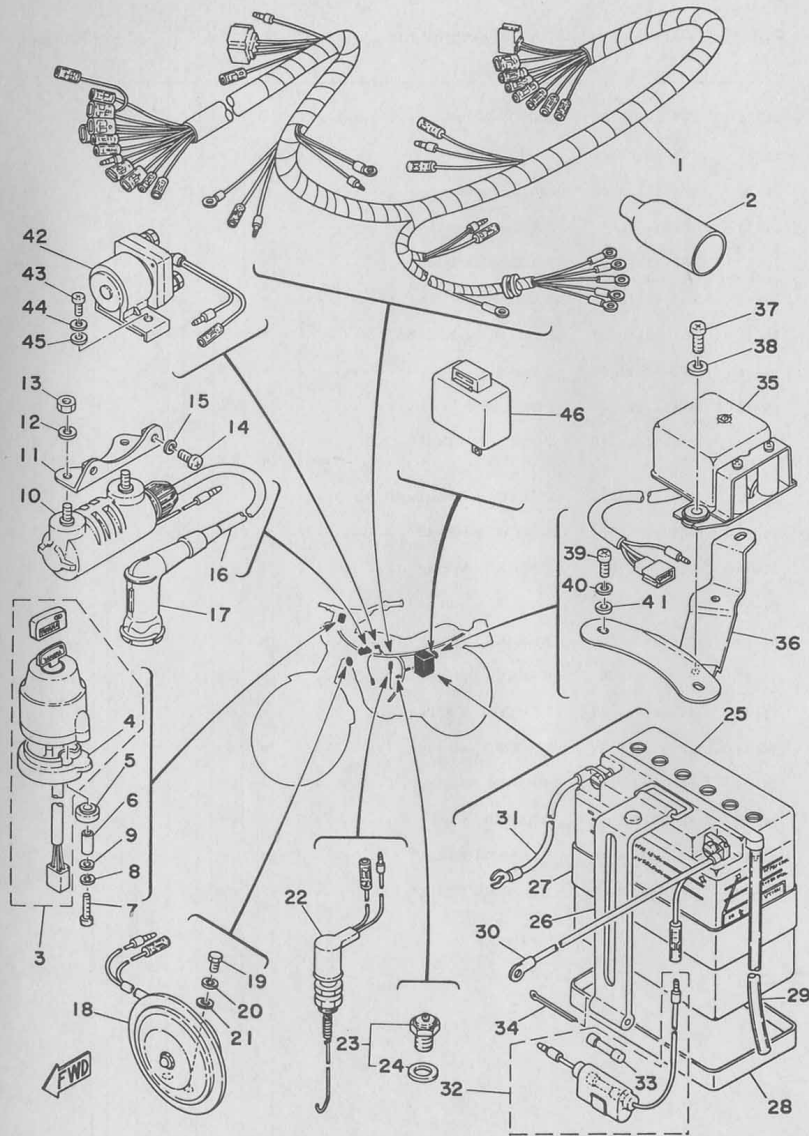

Ref. No.	Part No.	Description	Q'ty	FRANCE	HOLLAND	SWITZERLAND	SWITZERLAND	SWITZERLAND	FINLAND	FINLAND	FINLAND	FINLAND	FINLAND	FINLAND	Remarks
34- 1	1G0-82590-70	WIRE HARNESS ASS'Y	1	x											
	1G0-82590-30	WIRE HARNESS ASS'Y	1			x	x								
34- 2	444-82599-00	COVER, connector	1	x	x	x									
34- 3	460-82508-80	MAIN SWITCH ASS'Y	1	x		x									
	460-82508-45	MAIN SWITCH ASS'Y	1			x									
34- 4	437-82555-00	. DAMPER, main switch ...	1	x	x	x									
34- 5	437-82556-00	DAMPER, main switch 2 ...	2	x	x	x									
34- 6	437-82516-00	COLLAR, main switch	2	x	x	x									
34- 7	98501-05025	SCREW, panhead	2	x	x	x									
34- 8	92901-05100	WASHER, spring	2	x	x	x									
34- 9	92901-05600	WASHER, plate	2	x	x	x									
34-10	254-82310-60	IGNITION COIL ASS'Y	1	x	x	x									
34-11	248-82316-00	BRACKET, ignition coil ...	1	x	x	x									
34-12	92901-06100	WASHER, spring	2	x	x	x									
34-13	95301-06600	NUT, hexagon	2	x	x	x									
34-14	92501-06012	SCREW, panhead	2	x	x	x									
34-15	92901-06100	WASHER, spring	2	x	x	x									
34-16	183-82341-00	CORD, high tension	1	x	x	x									
34-17	808-82370-10	PLUG CAP ASS'Y	1	x	x	x									
34-18	460-83371-52	HORN	1	x		x									
	444-83371-21	HORN	1			x									
34-19	97301-06012	BOLT, hexagon	2	x	x	x									
34-20	92901-06100	WASHER, spring	2	x	x	x									
34-21	92901-06600	WASHER, plate	2	x	x	x									
34-22	248-82530-00	STOP SWITCH ASS'Y	1	x	x	x									
34-23	136-82540-00	NEUTRAL SWITCH ASS'Y ...	1	x	x	x									
34-24	90430-11034	. GASKET (136-82543-00) ...	1	x	x	x									
34-25	2G4-82110-60	BATTERY ASS'Y	1	x	x	x									

Fig. 34 ELECTRICAL

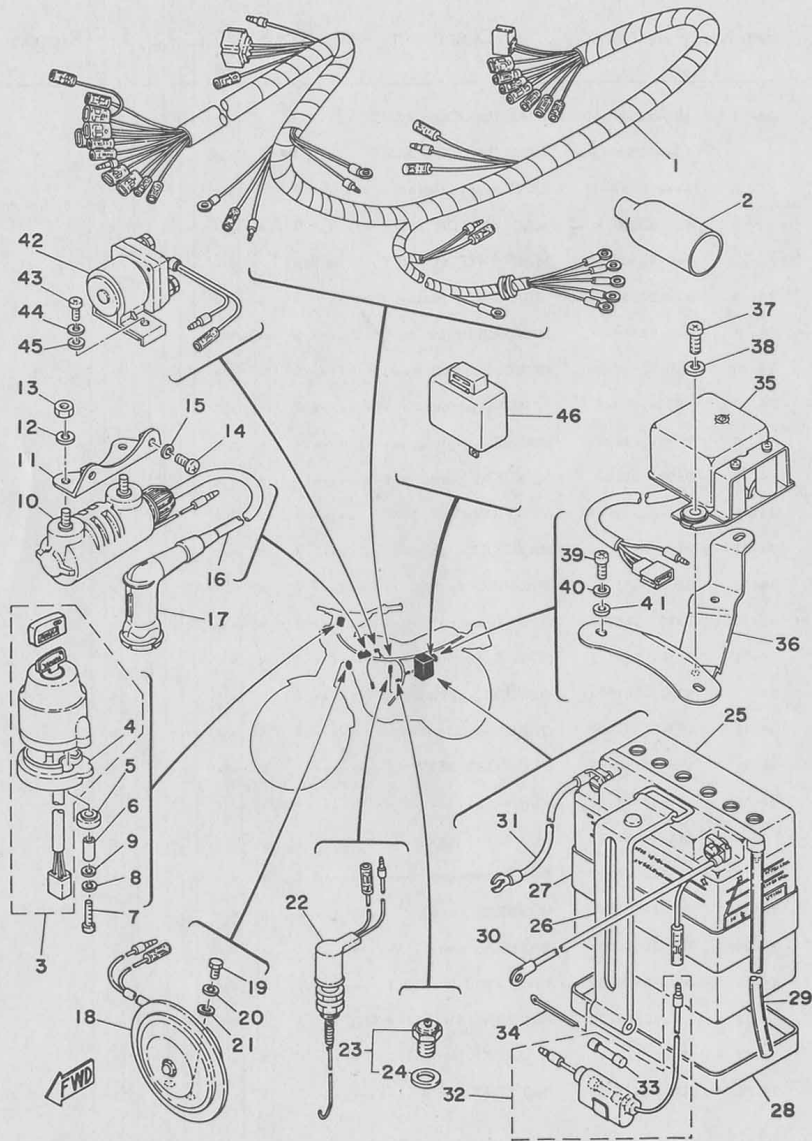

Ref. No.	Part No.	Description	Q'ty	FRANCE	HOLLAND	SWITZERLAND	WEST GERMANY	WEST GERMANY	SWEDEN	DENMARK	NORWAY	AUSTRIA	ITALY	Remarks
34-26	261-82131-00	BAND, battery	1	x	x	x							x	
34-27	165-82124-00	BAND, battery	1	x	x	x							x	
34-28	173-82122-00	SEAT, battery	1	x	x	x							x	
34-29	90445-08248	HOSE (395-82112-00)	1	x	x	x							x	
34-30	261-82115-01	WIRE, plus lead	1	x	x	x							x	
34-31	261-82116-01	WIRE, minus lead	1	x	x	x							x	
34-32	164-82150-00	FUSE HOLDER ASS'Y	1	x	x	x							x	
34-33	148-82151-00	FUSE	2	x	x	x							x	
34-34	91401-40040	PIN, cotter	1	x	x	x							x	
34-35	444-81910-10	VOLTAGE REGULATOR ASS'Y	1	x	x	x							x	
34-36	560-81915-01	PLATE, regulator fitting ...	1	x	x	x							x	
34-37	92501-06015	SCREW, panhead	2	x	x	x							x	
34-38	92901-06100	WASHER, spring	2	x	x	x							x	
34-39	92501-06012	SCREW, panhead	1	x	x	x							x	
34-40	92901-06100	WASHER, spring	1	x	x	x							x	
34-41	92901-06600	WASHER, plate	1	x	x	x							x	
34-42	444-81940-11	STARTER SWITCH ASS'Y ...	1	x	x	x							x	
34-43	92501-06012	SCREW, panhead	1	x	x	x							x	
34-44	92901-06100	WASHER, spring	1	x	x	x							x	
34-45	92901-06600	WASHER, plate	1	x	x	x							x	
34-46	1A4-83350-00	FLASHER RELAY ASS'Y ...	1	x									x	
	1G0-83350-40	FLASHER RELAY ASS'Y ...	1		x	x								

REPAIR KIT

Fig. 35 REPAIR KIT

Ref. No.	Part No.	Description	Q'ty	Applicable Machine No.	Remarks	Ref. No.	Part No.	Description	Q'ty	Applicable Machine No.	Remarks
35- 1	560-11630-00	PISTON ASS'Y (STD)	1			35-17	315-15451-02	. GASKET, crankcase cover	1		Ref. No. 2-8
	560-11630-10	PISTON ASS'Y (1st O.S)	1			35-18	93210-19123	. O-RING (2.4-19.0)	1		2-11
	560-11630-20	PISTON ASS'Y (2nd O.S)	1			35-19	444-15456-00	. GASKET, oil pump cover	1		2-13
	560-11630-30	PISTON ASS'Y (3rd O.S)	1			35-20	93210-18023	. O-RING (1.2-17.6)	1		3-17
	560-11630-40	PISTON ASS'Y (4th O.S)	1			35-21	137-15353-00	. GASKET, drain plug (14.5-21-1.5)	1		6-13
35- 2	560-11631-00-96	. PISTON (55.96mm STD)	1	} U.R 1 } Ref. No. 3-8		35-22	93210-13016	. O-RING (1.8-13)	1		9-6
	560-11631-00-98	. PISTON (55.98mm STD)	1			35-23	314-13621-02	. PACKING, valve seat	1		10-7
	560-11635-00	. PISTON (56.25mm 1st O.S)	1			35-24	304-14184-00	. GASKET, float chamber	1		11-9
	560-11636-00	. PISTON (56.50mm 2nd O.S)	1			35-25	558-14147-00	. O-RING	1		11-11
	560-11637-00	. PISTON (56.75mm 3rd O.S)	1			35-26	93210-24235	. O-RING (3.1-24.4)	1		12-2
	560-11638-00	. PISTON (57.00mm 4th O.S)	1			35-27	152-14613-00	. GASKET, exhaust pipe	1		12-4
35- 3	444-11610-00	. PISTON RING SET (STD)	1s	} 3-12		35-28	126-13116-00	. GASKET, pump case	1		13-1
	444-11610-10	. PISTON RING SET (1st O.S)	1s			35-29	90430-04004	. GASKET (137-13187-00)	1		13-16
	444-11610-20	. PISTON RING SET (2nd O.S)	1s			35-30	1G0-W0003-00	OIL SEAL KIT	1s		
	444-11610-30	. PISTON RING SET (3rd O.S)	1s			35-31	93102-25061	. OIL SEAL (SD-25-40-8)	1		3-14
	444-11610-40	. PISTON RING SET (4th O.S)	1s			35-32	93103-28011	. OIL SEAL (SW-28-40-8)	1		3-16
35- 4	137-11633-00	. PIN, piston	1		310	35-33	93104-11028	. OIL SEAL (SO-10.5-15-3)	1		4-22
35- 5	93450-17025	. CIRCLIP (137-11634-00)	2		311	35-34	93109-05015	. OIL SEAL (SDO-48-22-7)	1		5-10
35- 6	559-11650-00	CONNECTING ROD ASS'Y	1			35-35	93102-26042	. OIL SEAL (SD-26-38-5)	1		5-27
35- 7	559-11651-00	. ROD, connecting	1		3-4	35-36	93109-14005	. OIL SEAL (SDO-14-24-6)	1		7-7
35- 8	248-11681-01	. PIN, crank	1		3-5	35-37	93104-20017	. OIL SEAL (SO-20-30-7)	1		8-9
35- 9	93310-42231	. BEARING, con-rod big end	1		3-6	35-38	93101-10002	. OIL SEAL (S-10-22-7)	1		13-6
35-10	90209-22071	. WASHER (164-11685-00)	2		3-7						
35-11	93310-216A3	. BEARING, con-rod small end... 1			3-9						
35-12	1G0-W0001-00	GASKET KIT	1s								
35-13	90430-12038	. GASKET (132-15353-00)	1		1-17						
35-14	248-11351-00	. GASKET, cylinder	1		1-20						
35-15	248-11181-00	. GASKET, cylinder head	1		1-22						
35-16	314-15455-00	. GASKET, cover generator	1		2-3						

NUMERICAL INDEX

NUMERICAL INDEX

Part No.	Ref No.	Part No.	Ref No.	Part No.	Ref No.	Part No.	Ref No.	Part No.	Ref No.	Part No.	Ref No.
1A0-21771-00	23- 3	109-25315-00	25- 8	137-23145-01	19- 8	183-83312-70	33-12	241-16342-00	4-26	248-25138-10	25-24
1A4-83350-00	34-46	120-27430-02	16-18	137-84714-61	30- 3	183-83313-70	33- 3	246-14126-00	11-21	248-25317-00	26- 7
1E6-23441-00	20-17		16-19	141-81113-10	14-10		33-13	246-14132-0	11-18	248-25351-00	25-22
1E7-13176-00	13- 5	120-27431-00	16-20	146-23114-00	19-22	183-83333-71	33- 4	248-11181-00	1-22		26-13
1G0-W0001-00	35-12	120-27433-00	16-22	148-25115-00	26- 8		33-14	248-11351-00	1-20	248-25364-00	26-25
1G0-W0003-00	35-30	122-16164-00	4- 3	148-81126-10	14-12	195-84324-00	28-12	248-11681-01	3- 5	248-25388-00	26-17
1G0-13101-00	13-10	122-23119-01	19-30	148-81152-10	14-20	2G4-82110-60	34-25	248-13178-00	13- 7	248-25437-10-33	26-27
1G0-14729-10	12-12	122-23129-00	19-29	148-82151-00	34-33	2K5-25118-00	25-12	248-14131-00	11-19	248-27211-00-33	17-21
1G0-21785-00	23-16	122-23411-00	20- 7	152-14174-00	11-32	2N6-25155-00	25-30	248-15111-03	1- 1	248-82316-00	34-11
1G0-21785-10	23-16	122-23412-00	20- 5	152-14613-00	12- 4	207-81331-10	14-11	248-15357-00	1-14	248-82530-00	34-22
1G0-21787-30	23-15	122-23416-00	20- 8	156-14135-00	11-31	214-13175-02	13- 3	248-15610-00-93	8- 1	254-82310-60	34-10
1G0-23101-40	19- 1	123-83516-21	28-10	156-23411-00	20- 2	214-14195-00	11- 6	248-15654-00	8-15	256-83311-70	32- 4
1G0-23340-00-33	19-24		29- 2	156-23412-00	20- 4	214-15385-00	6-22	248-15668-00	8-18		32-14
1G0-24244-30	22- 2		29- 8	156-24181-00	22- 7	214-15612-01	8- 2	248-17831-02	9- 3	260-14142-25	11- 2
1G0-24244-40	22- 2	124-84516-60	30- 7	164-14137-00	11-17	214-15616-00	8- 4	248-17837-00	9- 4	261-21240-00-33	15-13
1G0-24245-30	22- 3	124-84522-60	30- 5	164-17427-00-06	5-20	214-15618-00	8- 6	248-17841-00	9- 5	261-21775-00	23-10
1G0-24245-40	22- 3	126-13116-00	13- 1	164-18561-00	6- 4	214-15664-00	8-13	248-17861-00	9- 1	261-82115-01	34-30
1G0-24730-00	24- 1	127-24650-02	22- 5	164-18571-01	6- 8	214-15676-00	8-11	248-18101-01	7- 1	261-82116-01	34-31
1G0-24731-00	24- 2	132-14173-00	11-34	164-18589-00	6- 9	214-17811-02	9- 7	248-18511-02	6-21	261-82131-00	34-26
1G0-82590-30	34- 1	132-16346-00	4-28	164-23462-00	20- 1	214-17812-00	9-11	248-18512-01	6-16	265-17211-00	5-19
1G0-82590-70	34- 1	132-18113-01	7-11	164-82150-00	34-32	214-17847-00	9- 9	248-18513-01	6-20	265-17241-00	5-18
1G0-83350-40	34-46	132-18140-01	6-23	165-82124-00	34-27	214-18531-00	6-19	248-18531-00	6-15	275-83318-00	32- 8
1G0-84310-30	28- 5	133-81132-10	14-14	168-14190-25	11- 5	214-21513-00	18- 3	248-21170-00-33	15-20		33- 8
1G0-84314-30	28- 8	134-23484-10	15-29	168-21638-00	12-19	214-21514-00	18- 4	248-21399-00	15-21	275-84523-60	31- 3
1G0-84320-30	28- 7	136-82540-00	34-23	168-21638-00	18-18	214-23158-00	19-27	248-21471-00-33	15- 2	275-84527-60	31- 9
1G0-84519-40-36	30-14	137-11633-00	3-10	173-82122-00	34-28	214-23318-00	19-25	248-21613-00-91	18-12	278-13169-00	13-18
1G0-84710-20	30- 1	137-13137-00-03	13-11	174-14123-00	11-29	214-24512-00	22-15	248-21622-00-33	18-26	299-81133-10	14-13
1G0-84710-41	30- 1	137-13137-00-05	13-11	174-14134-00	11-28	214-24535-00	22-20	248-21629-00	18-25	304-14171-00	11-30
1G0-84710-70	30- 1	137-13137-00-10	13-11	174-17461-50	5-29	214-24724-00	24-11	248-21635-00	18-20	304-14184-00	11- 9
1G0-84711-41	30- 2	137-13138-01	13-12	174-17461-60	5-29	214-25355-00	26-22	248-21717-00	15-14	304-14261-00	11-35
1G1-82594-00	19-36	137-14143-19	11- 4	174-22123-00	16- 2	214-25412-00	26-30	248-21746-00	15-22	304-15128-00	1- 6
1M1-85131-10	30-28	137-14143-20	11- 4	183-14196-00	11-38	214-26241-20	21- 2	248-21775-00	23- 9	304-23122-50	19-20
1R6-84112-30	28- 9	137-14143-21	11- 4	183-14197-01	11-37	214-27413-00	17-15	248-22141-00	16- 3	306-84346-40	27- 8
1R6-84146-30	28-11	137-14186-01	11- 8	183-25149-00	25-17	214-27421-00-33	17-14	248-22151-00	16- 6	307-16367-00	4- 5
1X0-24161-00	22- 4	137-15353-00	6-13	183-25330-01	25-19	214-83578-30	29- 5	248-22318-00-33	16-13	307-84320-21	27- 5
1Y9-84115-30	28- 6	137-16325-70	4- 7		26-12	214-83912-00	21- 6	248-23111-01	19-23	308-21510-00-36	18- 1
101-81111-10	14- 9	137-16356-00	4-11	183-81421-10	14- 4	214-84153-60	27- 2	248-23115-01	19-21	308-21512-00-93	18- 2
102-25137-00	25-29	137-17417-00-05	5-24	183-82341-00	34-16	233-83922-30	21-14	248-23144-00	19-17	308-84115-21	27- 4
109-25136-00	25-26	137-23145-01	19- 3	183-83312-70	33- 2	241-16341-01	4-20	248-25135-10	25-18	308-84124-20	27- 9

NUMERICAL INDEX

Part No.	Ref No.	Part No.	Ref No.	Part No.	Ref No.	Part No.	Ref No.	Part No.	Ref No.	Part No.	Ref No.
308-84135-21	27- 7	341-26290-21	21-35	437-23161-00	19-19	444-15118-00	1- 5	460-83371-52	34-18	525-23124-00	19-15
308-84517-40	30-27	341-26290-51	21-35	437-23163-00	19-18	444-15121-02	1- 2	460-83972-42	21- 3	525-23170-00	19-13
308-84521-40	30- 4	341-26290-61	21-36	437-25320-10-38	26-14	444-15456-00	2-13	460-84303-20	27- 3	535-23171-00	19-11
308-84521-70	30- 4	341-26290-71	21-36	437-26240-20	21-21	444-21610-00-36	18-11	460-84303-40	27- 3	535-23183-01	19-12
308-84547-40	30- 8	341-27231-00	17-25	437-82516-00	34- 6	444-22311-00-33	16- 7	460-84303-45	27- 3	539-14181-08	11-10
308-84553-00	30-13	341-83312-70	32- 2	437-82555-00	34- 4	444-22311-10-33	16- 7	460-84320-40	27- 5	558-14141-32	11- 3
	31-12		32-12	437-82556-00	34- 5	444-24183-00	22- 8	460-84320-45	27- 5	558-14147-00	11-11
314-13610-01	10- 2	341-83313-70	32- 3	437-83326-00	32-16	444-24768-00	24-12	460-84710-21	31- 1	558-17421-00	5-14
314-13613-00	10- 3		32-13	437-83328-01	32- 7	444-26335-01	21-25	478-25188-00	25-36	558-22210-01	16-11
314-13616-01	10- 4	341-83333-70	32- 5		33- 7	444-81100-10	14- 1	479-84526-00	31-11	558-24500-01	22-13
314-13621-02	10- 7		32-15	437-83368-02	32-17	444-81110-10	14- 3	493-14122-00	11-27	558-24705-00	24- 9
314-14112-20	11-15	341-84722-60	31- 6	437-83513-00	29- 4	444-81153-10	14-19	493-14133-00	11-26	558-26111-00	21- 1
314-14185-00	11- 7	341-84724-60	31- 5		29-10	444-81155-10	14- 2	498-15371-00	1-15	559-11650-00	35- 6
314-15411-01	2- 1	353-14138-00	11-33	437-83523-00	29-13	444-81910-10	34-35	498-24521-00	22-21	559-11651-00	3- 4
314-15416-00	2-12	353-17816-00	9- 8	437-83524-00	29-14	444-81940-11	34-42	498-24522-00	22-22	559-16301-01	4- 1
314-15421-00	2- 7	360-14124-20	11-24	437-83525-00	29-15	444-82599-00	34- 2	498-24523-00	22-14	559-16321-01	4- 6
314-15455-00	2- 3	360-21761-00	23- 2	437-83550-01	29-20	444-83310-72-93	32- 1	498-24524-01	22-16	559-23141-00	19-14
314-16396-01	4-21	361-82920-93	21-12	437-84517-00	30-27	444-83330-41-93	32-11	498-24525-00	22-19	559-23340-00-33	19-24
314-84112-10	27- 6	361-82921-31	21-13		31-25	444-83371-21	34-18	498-24528-00	22-17	560-11111-00	1-23
314-84112-20	27- 6	361-83980-30	21-33	437-84525-60	31-10	444-83520-00	29- 9	498-24602-03	22- 5	560-11311-00	1-21
315-15451-02	2- 8	363-14137-00	11-20	438-23121-00-33	19-34	444-83536-00	29- 3	498-24612-00	22- 6	560-11400-01	3- 1
315-15641-00	8-16	371-24728-01	24- 7	438-23131-00-33	19-35	444-83540-F0	29- 7	498-26372-00	21-30	560-11412-00	3- 2
315-15660-00	8- 8	382-26372-01	21-26	438-83519-02-98	29-12	444-83540-01	29- 7	498-82910-11	21- 4	560-11630-00	35- 1
315-18541-00	6- 1	401-17471-00	5-12	438-83526-01	29- 6	444-83560-01	29-21	498-82911-00	21- 5	560-11630-10	35- 1
315-23126-50	19- 2	401-25181-01	25-14		29-11	444-83570-G0	29- 1	498-84130-60-33	28- 1	560-11630-20	35- 1
315-23136-50	19- 6	401-25367-00	26-33	443-14116-02	11-16	444-83570-40	29- 1	498-84145-60	28- 2	560-11630-30	35- 1
315-23146-50	19- 4	401-25371-01	26-35	443-23435-00-33	20-10	444-83975-02	21-20	498-84163-60	28- 3	560-11630-40	35- 1
	19- 9	401-25381-00	26-20	443-25111-00	25- 1	444-84711-61	31- 2	498-84164-60	28- 4	560-11631-00-96	3- 8
315-23156-50	19- 5	402-13552-00	13-19	443-25304-00	26- 2	444-84751-60-20	31- 8	500-14115-00	11-12	560-11631-00-98	3- 8
	19-10	427-17121-01	5- 8	443-25311-00	26- 1	449-85131-01	31-26	512-84551-20-20	30- 9	560-11635-00	3- 8
315-23167-51	19-31	427-17131-00	5- 6		21-23	456-84130-41-33	27- 1	512-84551-40-20	30- 9	560-11636-00	3- 8
315-24726-00	24- 3	427-17141-00	5- 3	443-26341-01	21-29	456-84521-22	31- 4	521-25188-00	26-41	560-11637-00	3- 8
316-15415-00	2- 2	427-17151-00	5- 7	443-28100-10	15-33	458-25104-00	25- 2	525-11422-00	3- 3	560-11638-00	3- 8
316-21610-40-36	18-11	427-17221-00	5-15	444-11610-00	3-12	458-27311-00	17- 1	525-13174-00	13-23	560-13565-00	10- 1
316-21621-41-36	18-29	427-17231-00	5-17	444-11610-10	3-12	458-27315-00	17- 6	525-15651-00	5-23	560-14101-60	11- 1
316-83310-41-93	33- 1	427-17251-00	5-16	444-11610-20	3-12	460-25304-00	26- 2	525-16111-00	3-19	560-14411-00	10-13
316-83330-41-93	33-11	434-11161-00	1-28	444-11610-30	3-12	460-27411-41	17-11	525-16150-00	4- 2	560-14412-00	10-15
316-84711-70	30- 2	437-21779-00	23- 8	444-11610-40	3-12	460-82508-45	34- 3	525-16351-00	4- 8	560-14451-00	10-14
341-23408-01	15-28	437-23117-01	19-16	444-14747-00	15-32	460-82508-80	34- 3	525-16371-02	4- 4	560-14453-00	10-12

NUMERICAL INDEX

Part No.	Ref No.	Part No.	Ref No.	Part No.	Ref No.	Part No.	Ref No.	Part No.	Ref No.	Part No.	Ref No.
560-14718-00	12- 8	90109-06410	21- 7	90185-08054	15- 8	90240-06009	16-23	90467-10008	22-26	91401-20012	26-39
560-14791-00	12-13		21-15	90185-10035	15-12	90243-08006	17-17	90468-02033	13-21	91401-20025	17- 4
560-15362-00	2-10	90109-08063	26-36	90201-06042	17-18	90249-12008	17-30		13-22	91401-25012	17-28
560-16357-00	4-17	90109-08368	26-40	90201-06067	30-24	90250-08017	6-18	90468-10050	23-11	91401-25030	15-23
560-18111-00-93	7-10	90109-08391	12-17		31-22	90269-04003	15-31		24- 6	91401-30022	25-35
560-21110-00-33	15- 1	90109-08438	17- 2	90201-07076	25-25	90280-03017	3-22	90468-26048	8-17	91401-30030	26-21
560-21705-00-G3	23- 1	90109-10195	16-12	90201-08083	21- 8	90282-05005	3-23	90480-10068	26-15	91401-40035	17-24
560-21705-00-33	23- 1	90109-10399	17- 2		21-16	90338-09012	21-34	90480-14102	10-22	91401-40040	34-34
560-22110-00-33	16- 1	90109-14385	6-14	90201-08310	17-10	90340-12005	1-18		15-24	91609-40016	6- 3
560-24110-00-X3	22- 1	90113-06013	4-19	90201-08624	13- 2	90381-08002	9-14		18- 6	91701-05055	24- 5
560-24110-00-X4	22- 1	90116-06016	12- 5	90201-10146	17- 7	90383-10005	9-10		18-24	91810-16016	1- 3
560-24311-00	22-25	90116-08064	1-19	90201-12166	6- 7	90385-06001	29-19		23- 5	91830-21014	1- 4
560-24726-00	24- 4	90116-08261	19- 7	90201-12189	18-19	90387-07039	30-22		30-21		2- 9
560-26312-00	21-24	90119-08012	19-26	90201-12190	12-18	90387-070739	31-20		31-19	92501-06010	6-10
560-81915-01	34-36	90123-06010	21-31	90201-12362	1-24	90387-07390	15-15	90480-14104	30-23		9-12
576-23101-00	19- 1	90123-08046	21-28	90201-14586	7- 8	90387-07391	10-21		31-21		10-16
576-25121-00	25-23	90149-06011	22-23	90201-17550	4-15		15-25	90480-25135	22- 9	92501-06012	18-13
577-11161-00	1-27	90149-08094	7- 4	90201-18262	12-20		18- 5	90501-10245	17- 9		18-27
577-14610-00	12- 1	90152-05005	27-12	90201-20266	5- 4		18-23	90501-12083	6-12		34-14
577-14753-00	12- 3		28-13	90201-20266	5-32		23- 6	90501-20361	4- 9		34-39
577-21110-00-33	15- 1	90157-06029	23- 7	90201-20269	25-16	90387-10087	9- 2	90502-08005	15-27		34-43
	16- 1	90159-05011	4-10	90201-20279	16-21	90387-10537	17- 9	90504-18009	8- 3	92501-06015	4-23
	5- 1	90170-08029	7- 5	90201-25289	17-23	90387-12095	25-11	90506-09009	7- 2		34-37
578-17410-00	5- 2	90170-08176	19-33	90202-05005	12-11	90387-12100	25-13	90506-09112	6-25	93501-06020	2-14
578-17411-00	11-22	90170-10038	21-22	90202-06010	12-10	90387-15115	26-16	90506-10019	4-27		18-30
802-14158-00	11-23	90170-12060	4-12		22-24	90387-20488	3-18	90506-16036	25-20	92501-06025	15-16
802-14161-00	11-25	90170-14163	16- 5	90206-04003	15-30	90387-20491	5-28		26-11	92501-06030	2- 6
802-14169-00	34-17	90171-10012	17- 3	90206-18025	22-18	90430-04004	13-16	90507-29019	17- 5	92501-06035	2-15
808-82370-10	18-34	90171-12005	25-34	90208-12015	3-20	90430-11034	34-24	90507-29021	17- 5	92501-06045	1- 8
848-85131-01	25-31	90171-12015	25-34	90209-06095	30-20	90430-12038	1-17	90508-20023	17-16	92501-06050	1-11
90101-06278	24- 8	90171-14016	26-34		31-18	90430-27124	23- 4	90508-26040	8-12	92501-06055	1- 9
90101-06304	26-19	90171-14020	26-34	90209-08050	15- 6	90445-05278	13-20	90508-29308	17- 8		2- 5
90101-08034	26-31	90179-06143	21-32	90209-08098	22-10	90445-07176	1-16	90508-32207	7- 3	92501-06060	1-12
90101-08282	17- 2	90179-06176	17-31	90209-14136	26-42	90445-08248	34-29	90508-35070	17-22		2-16
90102-10006	15- 5	90179-08025	1-25	90209-22071	3- 7	90445-09110	23-13	90506-12138	25- 7	92501-06065	1-10
90105-08024	20-11	90179-08148	21-27	90215-08014	7- 6	90446-09012	23-12	90560-17147	4-14		2- 4
90105-14060	6-24	90179-12244	3-21	90215-12007	4-13	90460-43053	10-10	91311-08020	19-28	92501-06080	14-22
90109-06001	30-17	90179-16018	5-31	90215-16020	5-30	90460-49058	10-11	91401-16015	11-36	92501-08012	1- 7
90109-06022	31-13	90179-25033	20- 9	90240-06006	17-26	90467-08003	23-14		16-24	92503-06015	30- 6

NUMERICAL INDEX

Part No.	Ref No.	Part No.	Ref No.	Part No.	Ref No.	Part No.	Ref No.	Part No.	Ref No.	Part No.	Ref No.
92503-06015	32- 9	92901-06100	31-15	92901-10100	15-11	93410-20009	25-15	95301-06600	12- 7	97301-06020	21-17
	33- 9		31-23		17-13	93410-20038	5- 5		18-15	97301-06022	21- 9
92701-06012	24-10		34-12		17-20		5-33		18-33	97301-06025	10- 8
92901-03100	10- 5		34-15		20-13	93410-30012	8-14		25-32		18-21
92901-04100	11-14		34-20	92901-12200	25-33	93410-52034	26-26		30-26		26-23
	14- 6		34-38	92901-14100	16- 4	93430-08006	13- 8		31-16	97301-06030	25-31
92901-04200	14- 7		34-40	92903-05100	31-27	93430-10017	6-17		31-24		29-16
92901-05100	6- 5		34-44	92903-18100	18-17	93430-12009	7- 9		34-13	97301-06040	30-19
	13-14	92901-06200	17-27	93101-10002	13- 6	93440-11029	8- 5	95301-06700	4-18		31-17
	14-16		30-10	93102-18008	25-10	93440-15012	5-21	95301-06800	18- 8	97301-08016	22-12
	15-35	92901-06300	32-10	93102-25061	3-14		5-25		30-12	97301-08018	16-16
	16- 9		33-10	93102-26042	5-27	93450-17025	3-11		27-16	97301-08040	28-14
	18-35	92901-06600	4-25	93103-28011	3-16	93501-04011	20- 3		28-17	97301-10018	17-12
	30-29		10- 9	93104-07003	25-27	93503-16010	4-16		32- 6		17-19
	34- 8		10-18	93104-11028	4-22		20- 6		32-18	97303-08055	18-16
92901-05200	15-36		15- 4	93104-20017	8- 9	93505-16006	6-11		33- 6	97303-10030	20-12
92901-05600	16-10		15-18	93104-22018	26-32	93505-32002	13-17		33-17	97304-08025	27-13
	16-10		18-31	93105-47007	25-21	93603-14026	1-13	95301-08700	26-18	97321-06020	7-12
	34- 9		29-18	93106-26005	26-10	93603-22028	13- 4		26-38	97321-06075	10-19
92901-06100	4-24		34-21	93109-05015	5-10	93604-22050	6- 2	95301-08800	12-14	97321-06095	10-20
	9-13		34-41	93109-14005	7- 7	94127-21112	25- 4	95301-08900	17- 3	97321-08030	8- 7
	10-17		34-45	93210-11012	15-19	94127-21178	25- 4	95301-12700	16-25	97323-08045	20-14
	10-23	92901-08100	12-15	93210-13016	9- 6	94132-18074	26- 4	95303-05600	31-28	98501-04006	14- 8
	12- 6		14-21	93210-14104	25-28	94132-18119	26- 4	95303-08800	20-16	98501-04008	14- 5
	14-23		15- 7	93210-18023	3-17	94227-21031	25- 5	95601-06100	21-11	98501-04012	14-18
	15-17		16-17	93210-19123	2-11	94232-18020	26- 5		21-19	98501-05008	14-15
	16-15		19-32	93210-24235	12- 2	94325-18043	26- 6		25-32	98501-05010	15-34
	18- 9		20-15	93306-20204	26- 9	94327-21024	25- 6	95821-08035	20-18		16- 8
	18-14		22-11	93306-20517	3-13	94416-21123	25- 3	95821-10085	15-10	98501-05012	5-13
	18-22		26-37	93306-30103	25- 9	94418-18045	26- 3	95821-10095	15- 9		6- 6
	18-28		27-15	93306-30203	26-24	94418-21124	25- 3	97301-06010	19-38	98501-05016	13- 9
	18-32		28-16	93306-30401	5-26	94421-18081	26- 3		30-16	98501-05025	34- 7
	19-37		32-19	93306-30405	3-15	94524-28110	26-28	97301-06012	15- 3	98502-04014	11-13
	21-10		33-16	93306-30414	5-11	94624-28001	26-29		34-19	98503-04010	14-17
	21-18		12-16	93310-216A3	3- 9	94701-00045	1-26	97301-06018	16-14	98512-03008	10- 6
	29-17		27-14	93310-42231	3- 6	95301-05600	13-13		30-16	98901-04008	13-15
	30-11		28-15	93311-31515	5-22		18-36	97301-06020	15-26	98903-06010	12- 9
	30-15		30-18	93315-31502	5- 9		30-30		18- 7		
	30-25		31-14	93410-20009	8-10	95301-06600	10-24		18-10		



YAMAHA MOTOR CO., LTD.

PRINTED IN JAPAN

First edition Sep., 1978