

CONTENTS

Fig. 1 Engine 1
Fig. 2 Flywheel Magneto 2
Fig. 3 Frame - Seat - Wheel 3
Fig. 4 Head Lamp 4
Fig. 5 5
Fig. 6 6

MODEL DT175
(TYPE CT1)
for FRANCE

GENERAL INDEX

1. This Parts List is exclusive for DT175 France Model.
Please refer to CT2/CT3 Parts List (CT3 Q'ty Column) for the parts not listed in this publication.
2. The parts marked with * in the remark column of this list are not supplied with by Yamaha, those have to be found locally.
3. Please be advised that we supply you with Head Lamp Unit Ass'y without bulbs.

CONTENTS

Ref. No.	Parts No.	Description	Qty	Remarks
1-1	419-14101-40	CARBURETOR ASBY		
1-2	Fig. 1	Engine		1
1-3	Fig. 2	Flywheel Magneto		3
1-4	Fig. 3	Frame · Seat · Wheel		5
1-5	Fig. 4	Head Lamp · Tail Lamp		7
1-6	Fig. 5	Flasher Lamp		9
1-7	Fig. 6	Electrical		11

NUMERICAL INDEX

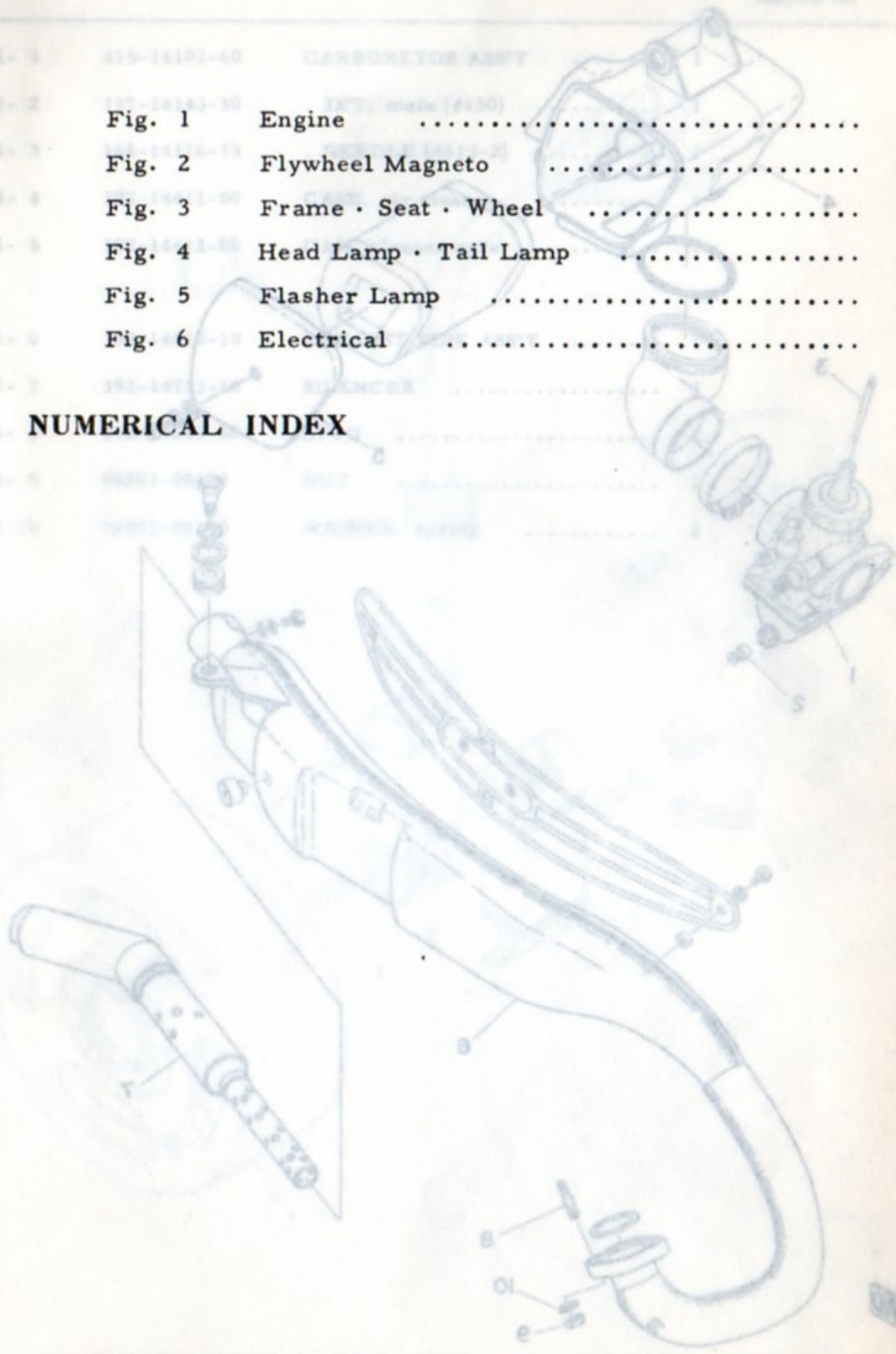
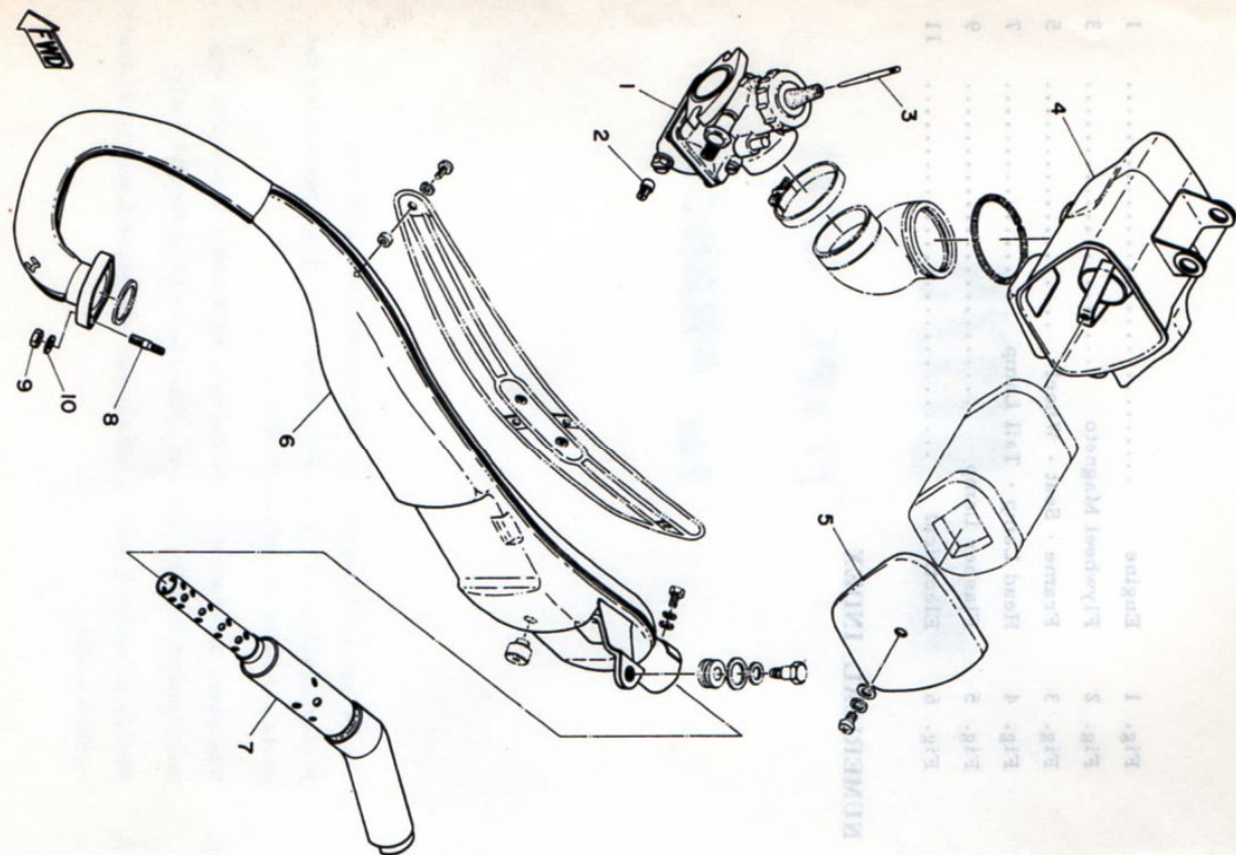

Fig. 1 ENGINE

СТРЕЛКОС



Ref. No.	Parts No.	Description	Qty	Applicable Machine No.	Remarks
----------	-----------	-------------	-----	------------------------	---------

1- 1	415-14101-60	CARBURETOR ASS'Y	1		
1- 2	137-14143-30	JET, main (#150)	1		
1- 3	166-14116-13	NEEDLE (4113-2)	1		
1- 4	392-14411-00	CASE, air cleaner	1		
1- 5	392-14412-00	CAP, cleaner case	1		
1- 6	392-14610-10	EXHAUST PIPE ASS'Y	1		
1- 7	392-14753-10	SILENCER	1		
1- 8	392-14651-00	STUD	2		
1- 9	98801-08200	NUT	2		
1-10	92901-08100	WASHER, spring	2		

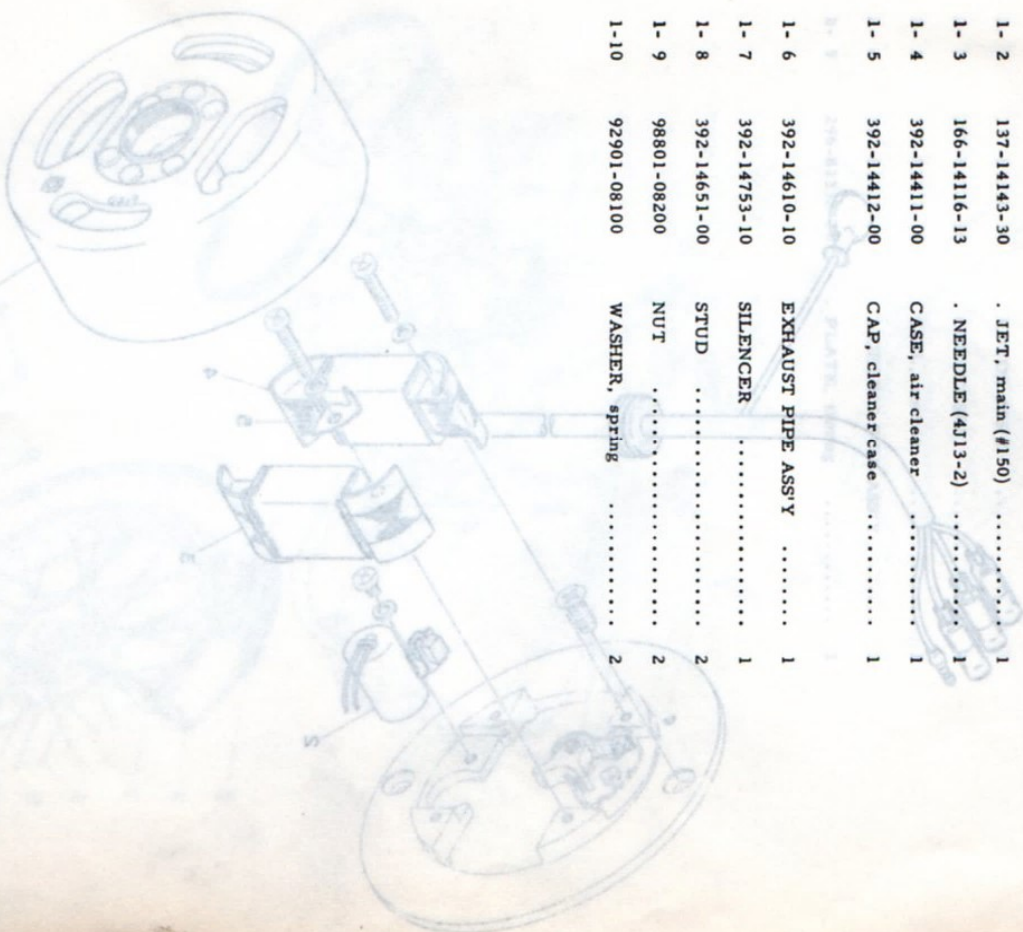
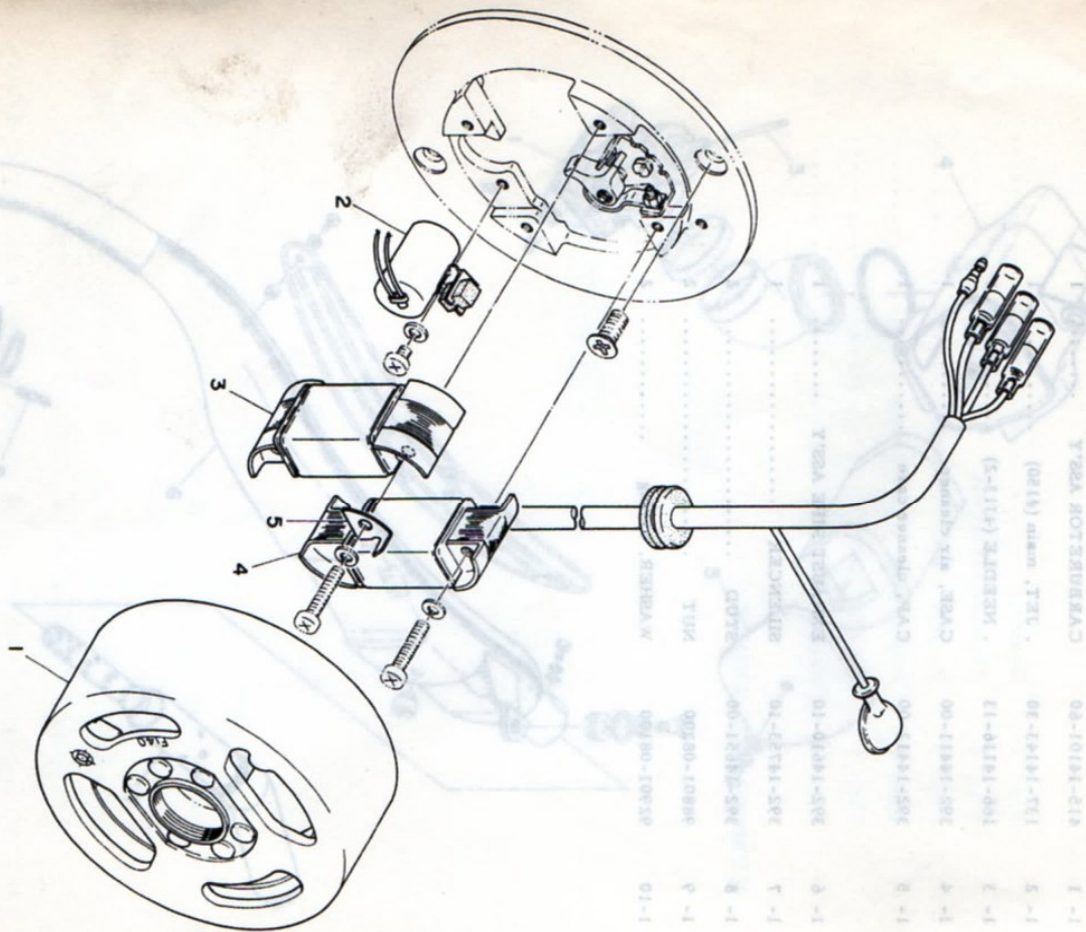

Fig. 2 FLYWHEEL MAGNETO



Ref. No.	Parts No.	Description	Qty	Applicable Machine No.	Remarks
----------	-----------	-------------	-----	------------------------	---------

2-0-1	317-81300-10	FLYWHEEL MAGNETO ASS'Y ...	1		
2-1	317-81350-10	· ROTOR ASS'Y	1		
2-2	207-81326-10	· CONDENSER	1		
2-3	317-81312-10	· COIL, source	1		
2-4	317-81313-10	· LIGHTING COIL ASS'Y	1		
2-5	296-81332-10	· PLATE, timing	1		

FLYWHEEL MAGNETO

Fig. 3 FRAME · SEAT · WHEEL

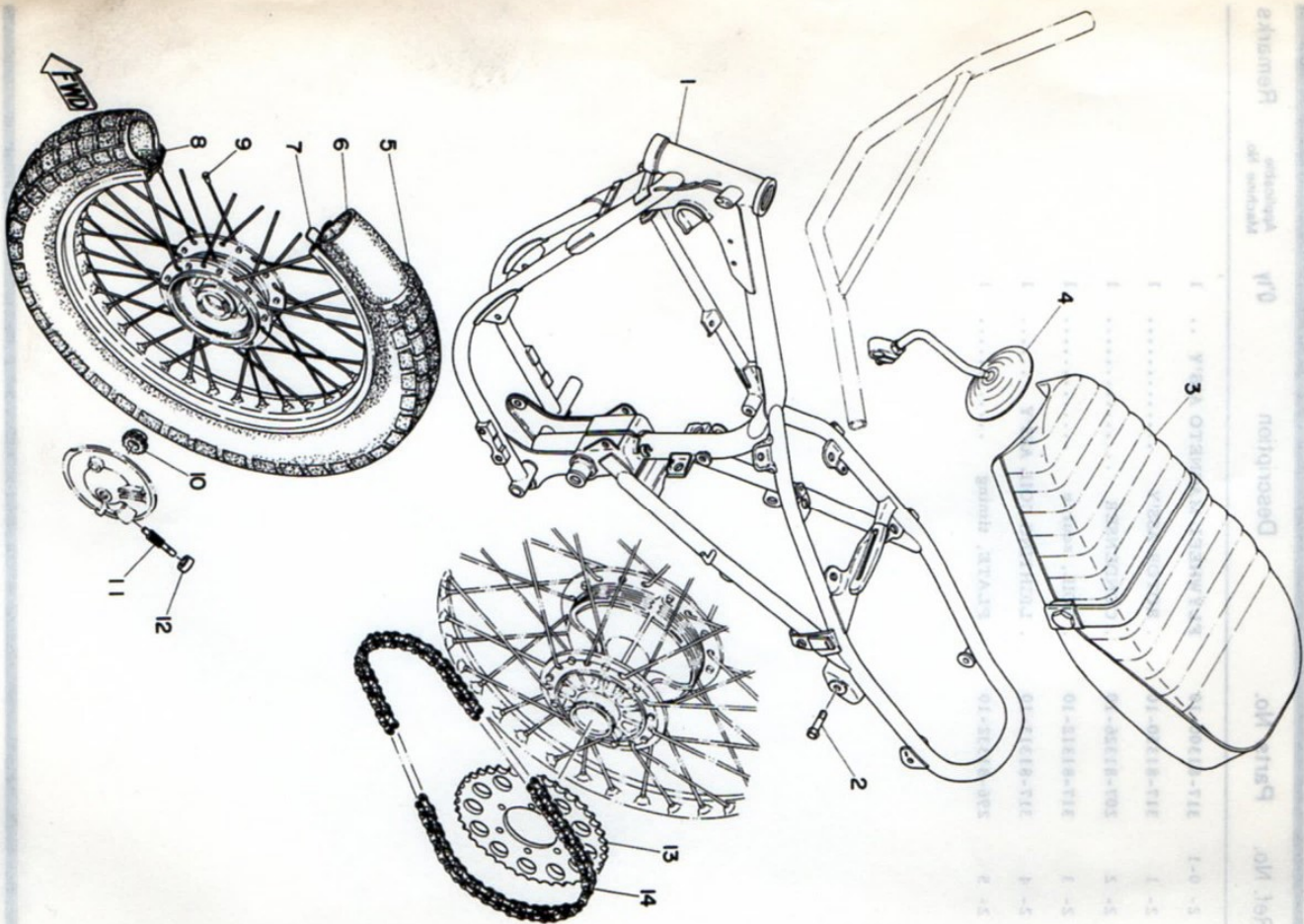

FRAME · SEAT · WHEEL

Ref. No.	Parts No.	Description	Qty	Applicable Machine No.	Remarks
3-1	316-21110-20-33	FRAME COMP.	1		
3-2	214-22241-00	BOLT, rear cushion	2		
3-3	316-24730-40	DOUBLE SEAT ASS'Y	1		
3-4	253-26290-20	BACK MIRROR ASS'Y, left	1		*
3-5	94127-21112	TIRE (2.75-21-4PR)	1		
3-6	94227-21031	TUBE (2.75-21)	1		
3-7	94327-21024	BAND, rim (2.75-21)	1		
3-8	94416-21044	RIM (1.60A-21)	1		
3-9	248-25104-10	SPOKE SET	1		
3-10	248-25135-10	GEAR, drive	1		
3-11	248-25138-10	GEAR, meter	1		
3-12	316-25139-01	PLUG, blind	1		
3-13	248-25437-10	GEAR, sprocket wheel (37T)	1		
3-14	94524-28108	CHAIN	1		

Fig. 4 HEAD LAMP · TAIL LAMP

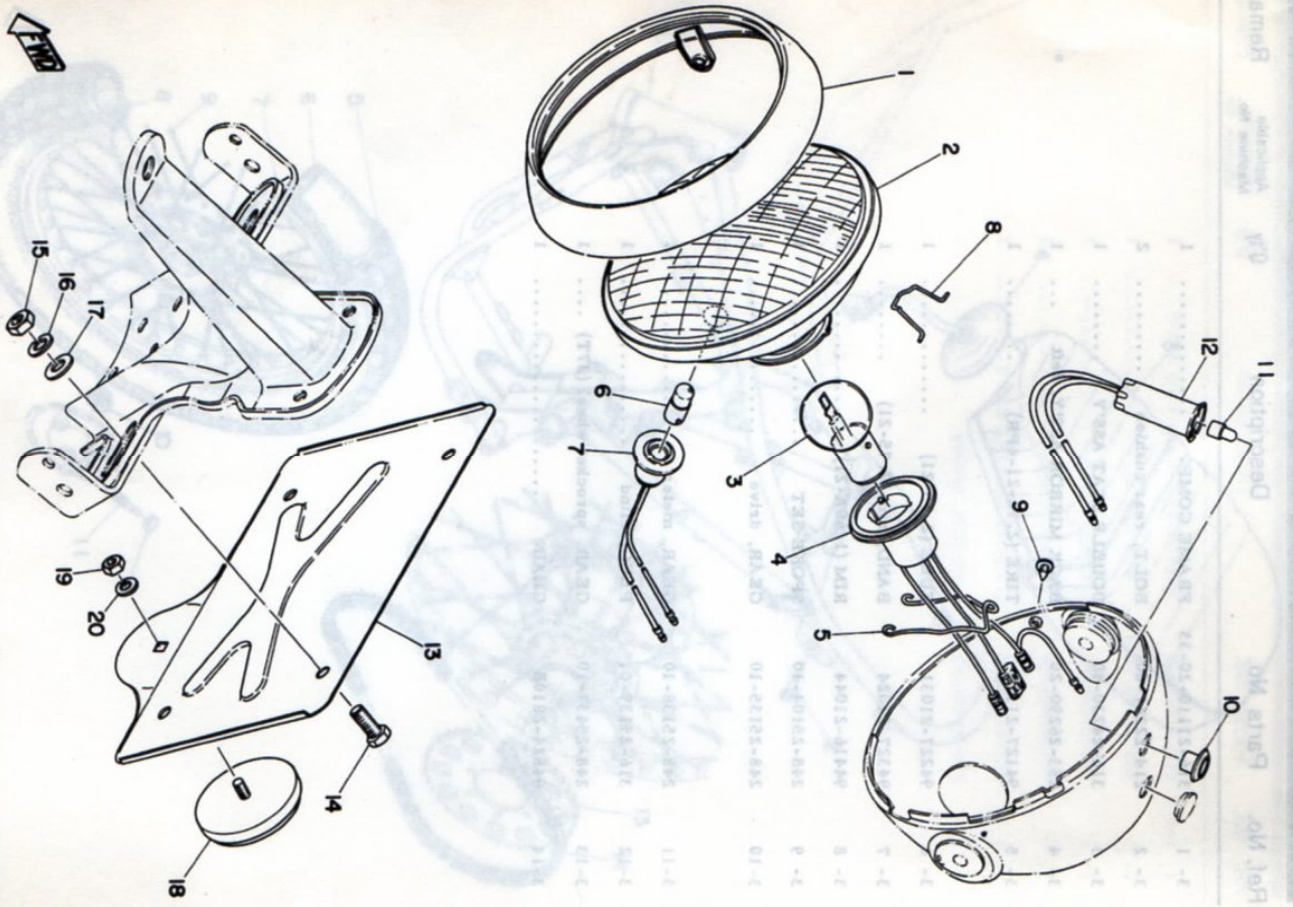

HEAD LAMP · TAIL LAMP

Ref. No.	Parts No.	Description	Q'ty	Applicable Machine No.	Remarks
4-0-1	314-84103-20	HEAD LAMP UNIT ASS'Y	1		
4-1	308-84115-21	· RIM, head lamp	1		
4-2	314-84120-20	· LENS ASS'Y	1		
4-3	314-84114-20	· BULB, head lamp (6V-25/25W)	1		*
4-4	314-84112-20	· SOCKET	1		
4-5	308-84135-21	· SPRING	1		
4-6	260-84147-40	· BULB, pilot (6V-4W)	1		*
4-7	306-84346-40	· SOCKET, pilot lamp	1		
4-8	308-84124-20	· SPRING, reflector set	4		
4-9	195-84325-00	SCREW, rim fitting	1		
4-0-2	308-84101-40	PILOT LAMP ASS'Y	1		
4-10	306-84357-40	· BODY, high beam	1		
4-11	104-83517-10	· BULB (6V-1.5W)	1		
4-12	214-84150-61	· SOCKET CORD ASS'Y	1		
4-13	341-85132-20	BRACKET 1	1		
4-14	97201-06015	BOLT	4		
4-15	98801-06100	NUT	4		
4-16	92901-06100	WASHER, spring	4		
4-17	92901-06200	WASHER, plain	4		
4-18	848-85131-01	REFLECTOR	1		
4-19	98801-05100	NUT	1		
4-20	92901-05100	WASHER, spring	1		

Fig. 5 FLASHER LAMP

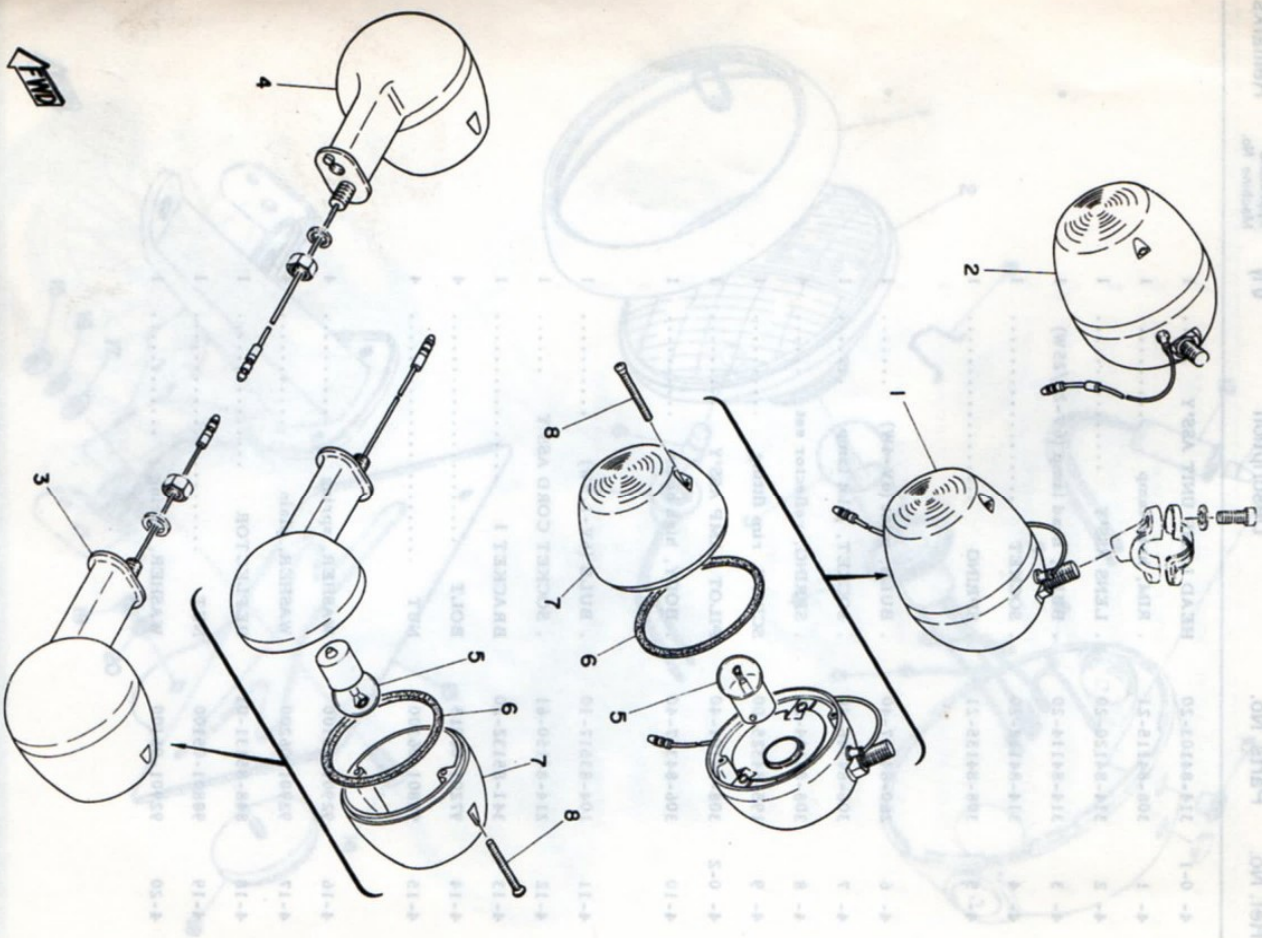

FLASHER LAMP

Ref. No.	Parts No.	Description	Q'ty	Applicable Machine No.	Remarks
5- 1	308-83310-35-93	FRONT FLASHER LAMP ASS'Y left	1		
5- 2	308-83320-35-93	FRONT FLASHER LAMP ASS'Y right	1		
5- 3	317-83330-50-93	REAR FLASHER LAMP ASS'Y left	1		
5- 4	317-83340-50-93	REAR FLASHER LAMP ASS'Y right	1		
5- 5	185-83311-10	BULB, Flasher (6V-8W)	4		
5- 6	183-83313-70	GASKET, flasher lens	4		
5- 7	183-83332-21	LENS, flasher	4		
5- 8	183-83333-21	SCREW, lens fitting	8		

Fig. 6 ELECTRICAL

ELECTRICAL

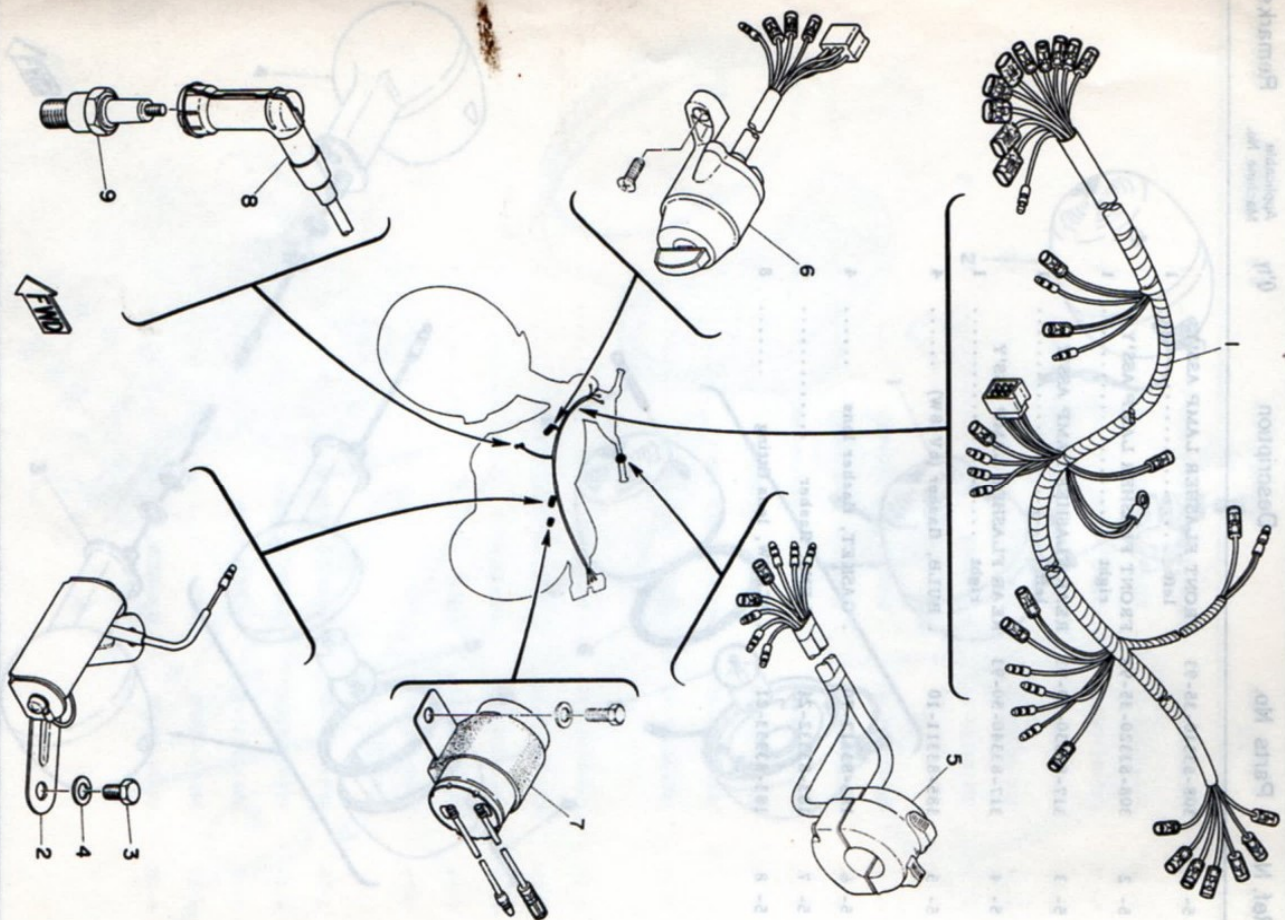

Ref. No. Parts No. Description Q'ty Applicable Machine No. Remarks

6-1	317-82590-80	WIRE HARNESS ASS'Y	1		
6-2	317-85370-00	RESISTOR ASS'Y	1		
6-3	97201-08010	BOLT	2		
6-4	92901-08100	WASHER, spring	2		
6-5	317-83972-00	SWITCH, handle 4	1		
6-6	308-82508-80	MAIN SWITCH ASS'Y	1		
6-7	248-83350-11	FLASHER RELAY ASS'Y	1		
6-8	808-82370-10	PLUG CAP ASS'Y	1		
6-9	94701-00045	PLUG, spark (B-8ES)	1		

NUMERICAL INDEX

Ref No.	Parts No.	Ref No.	Parts No.	Ref No.	Parts No.
4-11	104-83517-10	2- 1	317-81350-10		
1- 2	137-14143-30	6- 1	317-82590-80		
1- 3	166-14116-13	5- 3	317-83330-50-93		
5- 6	183-83313-70	5- 4	317-83340-50-93		
5- 7	183-83332-21	6- 5	317-83972-00		
5- 8	183-83333-21	6- 2	317-85370-00		
5- 5	185-83311-10	4-13	341-85132-20		
4- 9	195-84325-00	1- 4	392-14411-00		
2- 2	207-81326-10	1- 5	392-14412-00		
3- 2	214-22241-00	1- 6	392-14610-10		
4-12	214-84150-61	1- 8	392-14651-00		
3- 9	248-25104-10	1- 7	392-14753-10		
3-10	248-25135-10	1- 1	415-14101-60		
3-11	248-25138-10	6- 8	808-82370-10		
3-13	248-25437-10	4-18	848-85131-00		
3- 4-9	253-26290-20	4-20	92901-05100		
4- 6	260-84147-40	4-16	92901-06100		
6- 7	284-83350-11	4-17	92901-06200		
2- 5	296-81332-10	1-10	92901-08100		
4- 7	306-84346-40	6- 4	92901-08100		
4-10	306-84357-40	3- 5	94127-21112		
6- 6	308-82508-80	3- 6	94227-21031		
5- 1	308-83310-35-93	3- 7	94327-21024		
5- 2	308-83320-35-93	3- 8	94416-21044		
4- 0-2	308-84101-40	3-14	94524-28108		
4- 1	308-84115-21	6- 9	94701-00045		
4- 8	308-84124-20	4-14	97201-06015		
4- 5	308-84135-21	6- 3	97201-08010		
4- 0-1	314-84103-20	4-19	98801-05100		
4- 4	314-84112-20	4-15	98801-06100		
4- 3	314-84114-20	1- 9	98801-08200		
4- 2	314-84120-20				
3- 1	316-21110-20-33				
3- 3	316-24730-40				
3-12	316-25139-01				
2- 0-1	317-81300-10				
2- 3	317-81312-10				
2- 4	317-81313-10				

NUMERICAL INDEX

Rel No.	Parts No.	Rel No.	Parts No.	Rel No.	Parts No.
4-11	104-83217-10	2-1	217-81320-10		
1-2	137-14143-30	6-1	217-82290-80		
1-7	166-14116-12	2-3	217-82330-80-93		
2-6	183-83213-70	2-4	217-82340-80-93		
2-7	183-83225-21	6-2	217-83972-00		
2-8	183-83227-21	6-2	217-85270-00		
2-2	185-82211-10	4-12	241-82132-20		
4-9	192-84222-00	1-4	292-14411-00		
2-2	207-81226-10	1-2	292-14412-00		
2-2	214-22241-00	1-6	292-14410-10		
4-12	214-84120-61	1-8	292-14421-00		
2-9	248-22104-10	1-7	292-14722-10		
2-10	248-22122-10	1-1	412-14101-60		
2-11	248-22128-10	6-8	808-82270-10		
2-12	248-22427-10	4-18	848-82131-00		
2-4-2	252-20290-20	4-20	92901-02100		
4-6	260-84147-40	4-16	92901-06100		
6-7	284-83220-11	4-17	92901-06200		
2-2	296-81222-10	1-10	92901-08100		
4-7	298-84244-40	6-4	92901-08100		
4-10	298-84227-40	2-2	94127-21112		
6-6	298-82208-80	2-6	94227-21021		
2-1	298-82210-22-93	1-7	94227-21024		
2-2	298-82220-22-93	2-8	94416-21044		
4-0-2	298-84101-40	2-14	94224-28108		
4-1	298-84112-21	6-2	94201-00042		
4-8	298-84124-20	4-14	92501-06012		
4-2	298-84122-21	6-2	92501-08010		
4-0-1	214-84102-20	4-14	98801-02100		
4-4	214-84112-20	4-12	98801-04100		
4-7	214-84114-20	1-9	98801-04200		
4-2	214-84120-20				
2-1					
2-1					
2-1					
2-2					
2-2					
2-4					



YAMAHA MOTOR CO., LTD.

PRINTED IN JAPAN
First edition Feb., 1973

(415-20)